



010

**LAMPADINE, PRESSACAVI
ED ACCESSORI**

**LAMPS, CABLE GLANDS
AND ACCESSORIES**

016

020

032

030

040

080

050

060



Lampadine Bulbs

BA9S Led luce fissa BA9S Steady light led bulbs

W g n cod

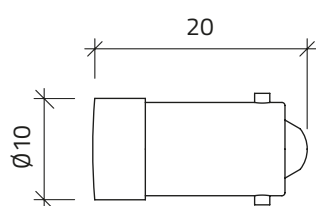

6V AC/DC

● Rosso / Red	0,05	2	5	010BA9SLR6
● Verde / Green	0,05	2	5	010BA9SLV6
● Giallo / Yellow	0,05	2	5	010BA9SLG6
● Blu / Blue	0,05	2	5	010BA9SLBL6
○ Bianco / White	0,05	2	5	010BA9SLB6

12V AC/DC

● Rosso / Red	0,1	2	5	010BA9SLR12
● Verde / Green	0,1	2	5	010BA9SLV12
● Giallo / Yellow	0,1	2	5	010BA9SLG12
● Blu / Blue	0,1	2	5	010BA9SLBL12
○ Bianco / White	0,1	2	5	010BA9SLB12

24V AC/DC

● Rosso / Red	0,2	2	5	010BA9SLR24
● Verde / Green	0,2	2	5	010BA9SLV24
● Giallo / Yellow	0,2	2	5	010BA9SLG24
● Blu / Blue	0,2	2	5	010BA9SLBL24
○ Bianco / White	0,2	2	5	010BA9SLB24

36V AC/DC

● Rosso / Red	0,3	2	5	010BA9SLR36
● Verde / Green	0,3	2	5	010BA9SLV36
● Giallo / Yellow	0,3	2	5	010BA9SLG36
● Blu / Blue	0,3	2	5	010BA9SLBL36
○ Bianco / White	0,3	2	5	010BA9SLB36

48V AC/DC

● Rosso / Red	0,3	2	5	010BA9SLR48
● Verde / Green	0,3	2	5	010BA9SLV48
● Giallo / Yellow	0,3	2	5	010BA9SLG48
● Blu / Blue	0,3	2	5	010BA9SLBL48
○ Bianco / White	0,3	2	5	010BA9SLB48

110-130V AC/DC

● Rosso / Red	0,4	2	5	010BA9SLR110
● Verde / Green	0,4	2	5	010BA9SLV110
● Giallo / Yellow	0,4	2	5	010BA9SLG110
● Blu / Blue	0,4	2	5	010BA9SLBL110
○ Bianco / White	0,4	2	5	010BA9SLB110

220-240V AC/DC

● Rosso / Red	0,6	2	5	010BA9SLR240
● Verde / Green	0,6	2	5	010BA9SLV240
● Giallo / Yellow	0,6	2	5	010BA9SLG240
● Blu / Blue	0,6	2	5	010BA9SLBL240
○ Bianco / White	0,6	2	5	010BA9SLB240

380-400V AC/DC

● Rosso / Red	0,4	2	5	010BA9SLR400
● Verde / Green	0,4	2	5	010BA9SLV400
● Giallo / Yellow	0,4	2	5	010BA9SLG400
● Blu / Blue	0,4	2	5	010BA9SLBL400
○ Bianco / White	0,4	2	5	010BA9SLB400



Lampadine Bulbs

BA9S Led luce fissa BA9S Steady light led bulbs

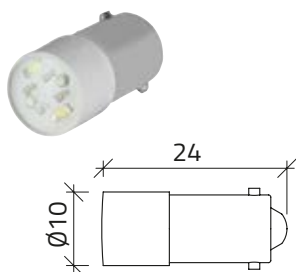

8V AC/DC tensione di accensione / 8V AC/DC switch ON voltage
24V ÷ 30V AC/DC con Diodo Zener integrato / 24V ÷ 30V AC/DC with integrated Zener Diode

	W	g	cod
○ Bianco / White	0,2	2	010BA9SZLB30

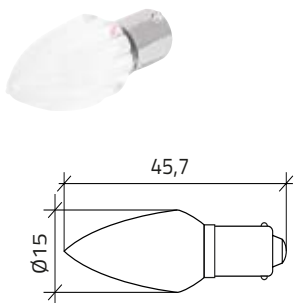

24V AC/DC

● Rosso / Red	0,4	3	010BA9ALR24
● Verde / Green	0,4	3	010BA9ALV24
● Giallo / Yellow	0,4	3	010BA9ALG24
● Blu / Blue	0,4	3	010BA9ALBL24
○ Bianco / White	0,4	3	010BA9ALB24

220-240V AC/DC

● Rosso / Red	3	3	010BA9ALR220
● Verde / Green	3	3	010BA9ALV220
● Giallo / Yellow	3	3	010BA9ALG220
● Blu / Blue	3	3	010BA9ALBL220
○ Bianco / White	3	3	010BA9ALB220

BA9S Led luce lampeggiante BA9S Flashing light led bulbs

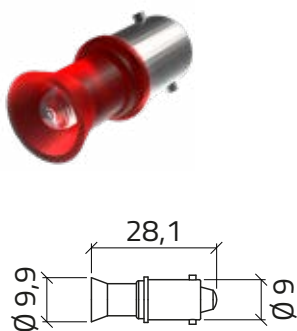

9V AC/DC

● Rosso / Red	0,2	2	010BA9SLLR9
---------------	-----	---	-------------

24V AC/DC

● Rosso / Red	0,2	2	010BA9SLLR24
---------------	-----	---	--------------

48V AC/DC

● Rosso / Red	0,6	2	010BA9SLLR48
---------------	-----	---	--------------

110-130V AC

● Rosso / Red	0,8	2	010BA9SLLR110
---------------	-----	---	---------------

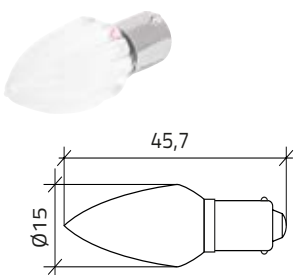

24V AC/DC

● Rosso / Red	0,4	3	010BA9ALLR24
---------------	-----	---	--------------



Lampadine Bulbs

BA9S Lampadine due colori BA9S Bi-colour led bulbs

g cod

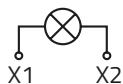

24V DC 0,4W

1 = X1+ X2-
2 = X1- X2+

Colore 1 / Colour 1

- Verde / Green
- Verde / Green
- Blu / Blue
- Blu / Blue

Colore 2 / Colour 2

- Rosso / Red 2
- Giallo / Yellow 2
- Rosso / Red 2
- Giallo / Yellow 2

- 010BA9SLVR24**
- 010BA9SLVG24**
- 010BA9SLBLR24**
- 010BA9SLBLG24**

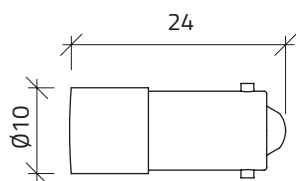

BA9S Lampadine ad incandescenza BA9S Incandescent bulbs

V W g n cod

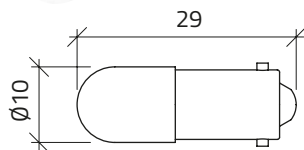

V	W	g	n	cod
6	0,6	1,3	10	010BA9S6V-0.6W
24	1,2	1,3	10	010BA9S24V-1.2W
24	3	1,3	10	010BA9S24V-3W
30	1,2	1,3	10	010BA9S30V-1.2W
30	3	1,3	10	010BA9S30V-3W
48	1,2	1,3	10	010BA9S48V-1.2W
60	1,2	1,3	10	010BA9S60V-1.2W
60	3	1,3	10	010BA9S60V-3W
110	1,9	1,3	10	010BA9S130V-1.9
220	2	1,3	10	010BA9S220V-2W

BA9S Lampadine al neon AC BA9S Neon AC bulbs

V W g n cod

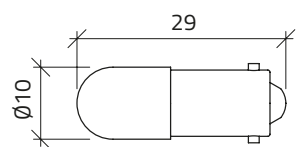

V	W	g	n	cod
65	0,05	2,3	10	010BA9SN65
130	0,1	2,3	10	010BA9SN110
130	0,1	2,3	10	010BA9NV110
240	0,3	2,3	10	010BA9SN220
240	0,3	2,3	10	010BA9NV220
400	0,5	2,3	10	010BA9SN380
400	0,5	2,3	10	010BA9NV380

BA15D Lampadine led BA15D Led bulb

W g cod

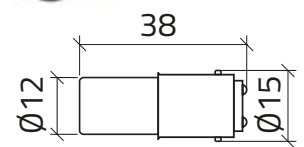

Led luce fissa / Steady light led

12-24V AC/DC

○ Bianco / White 1,5 2 **010BA15DLB24**

220-240V AC/DC

○ Bianco / White 3 2 **010BA15DLB220**

Led luce lampeggiante / Flashing light led

12-24V AC/DC

○ Bianco / White 1,5 2 **010BA15DLLB24**



Chiavi Keys

Chiavi Keys

g c n cod

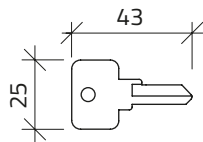

11	3095	2	010K95
11	3353	2	010K53
11	9901	2	010K01
11	9902	2	010K02
11	9903	2	010K03
11	9904	2	010K04
11	9905	2	010K05
11	9910	2	010K10
11	9916	2	010K16
11	9919	2	010K19

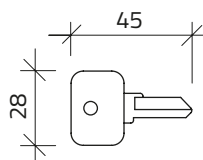

Versione secondo normativa FIAT / Version according to FIAT standards

● Nero / Black	11	73034	2	010K34
● Rosso / Red	11	73037	2	010K37
● Giallo / Yellow	11	73033	2	010K33
● Blu / Blue	11	73038	2	010K38
● Arancio / Orange	11	73040	2	010K40

016

020

032

030

040

080

050

060



Pressacavi in termoplastico

Thermoplastic cable glands

Pressacavi

Cable glands



Poliammide PA6 autoestinguente cl. V2 (UL 94) - Temperatura di impiego -20°C ÷ +90°C
 V2 (UL 94) self-extinguishing PA6 polyamide - Operating temperature -20°C ÷ +90°C

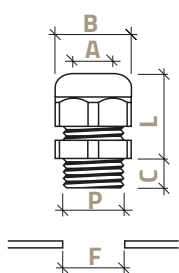

● Nero / Black	M12 × 1,5	4	12,5	3-6,5	15	8	25	010NM12
● Nero / Black	M16 × 1,5	7	16,5	5-10	22	10	32	010NM16
● Nero / Black	M20 × 1,5	11	20,5	6-12	24	10	32	010NM20
● Nero / Black	M20 × 1,5	11	20,5	10-14	27	10	32	010NM20A
● Nero / Black	M25 × 1,5	16	25,5	13-18	33	10	38	010NM25
● Nero / Black	M32 × 1,5	23	32,5	18-25	42	15	43	010NM32
● Nero / Black	PG7	4	12,5	3-6,5	15	8	25	010NPG7
● Nero / Black	PG9	6	15,5	4-8	19	8	27	010NPG9
● Nero / Black	PG11	9	19	5-10	22	8	32	010NPG11
● Nero / Black	PG13,5	11	20,5	6-12	24	10	32	010NPG13
● Nero / Black	PG16	13	22,5	10-14	27	10	32	010NPG16
● Nero / Black	PG21	21	29	13-18	33	12	38	010NPG21
○ Bianco / White	PG29	27	38	18-25	42	11	35-40	010NPG29

Pressacavo 2 ingressi

2-hole cable gland

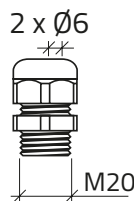

● Nero / Black

10 **0102P20**

Pressacavo 2 vie

Double entry cable gland

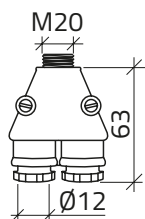

● RAL 7035

45 **010N2M20**

Pressacavi con spirale

Spiral cable glands

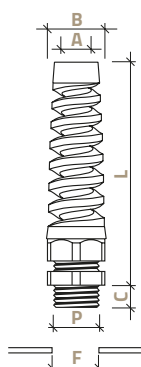

Poliammide PA6 autoestinguente cl. V2 (UL 94) - Temperatura di impiego -20°C ÷ +90°C
 V2 (UL 94) self-extinguishing PA6 polyamide - Operating temperature -20°C ÷ +90°C

M12 × 1,5	7	12,5	3-6,5	15	8	58	010FM12
M16 × 1,5	10	16,5	5-10	22	10	83	010FM16
M20 × 1,5	19	20,5	6-12	24	10	96	010FM20
M20 × 1,5	19	20,5	10-14	27	10	96	010FM20A
M25 × 1,5	33	25,5	13-18	33	10	119	010FM25
PG11	16	19	5-10	22	8	83	010FPG11
PG13,5	19	20,5	6-12	24	10	96	010FPG13
PG16	25	22,5	10-14	27	10	106	010FPG16
PG21	25	29	13-18	33	11	119	010FPG21



Tappi, riduzioni e controdadi in termoplastico

Thermoplastic hole plugs, reducers and locknuts

Tappi di chiusura Hole plugs

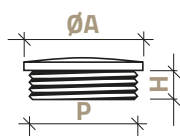

Polistirene PA5 - Temperatura di impiego $-20^{\circ}\text{C} \div +60^{\circ}\text{C}$
PA5 Polystyrene - Operating temperature $-20^{\circ}\text{C} \div +60^{\circ}\text{C}$

M12 × 1,5	15	10	1	010TM12
M16 × 1,5	19,5	10	2	010TM16
M20 × 1,5	25	10	2,4	010TM20
M25 × 1,5	30	10	4	010TM25
M32 × 1,5	37	10	4,2	010TM32
PG7	15	10	1	010TPG7
PG9	19,5	10	1,5	010TPG9
PG11	22	10	2	010TPG11
PG13,5	25	10	2	010TPG13
PG16	27	10	3	010TPG16
PG21	33	10	4	010TPG21

Riduzioni in plastica / Plastic reducers

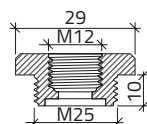

M25 M12 10 8 29 **010RM25M12**

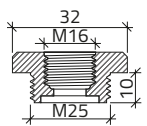

M25 M16 10 9 32 **010RM25M16**

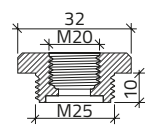

M25 M20 10 7,8 32 **010RM25M20**

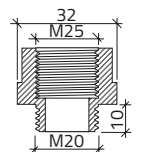

M20 M25 10 6,8 32 **010RM20M25**

Controdadi / Locknuts

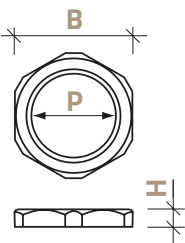

Poliammide PA6 autoestinguente cl. V2 (UL 94) - Temperatura di impiego $+20^{\circ}\text{C} \div +90^{\circ}\text{C}$
V2 (UL 94) self-extinguishing PA6 polyamide - Operating temperature $-20^{\circ}\text{C} \div +90^{\circ}\text{C}$

● Nero / Black	M12 × 1,5	18	5	1	10	010DM12
● Nero / Black	M16 × 1,5	24	6	1,5	1	010DM16
● Nero / Black	M20 × 1,5	27	6	2	1	010DM20
● Nero / Black	M25 × 1,5	34	7	3	1	010DM25
● Nero / Black	M32 × 1,5	41	7	4	1	010DM32
● Nero / Black	PG7	19	5	1	1	010DPG7
● Nero / Black	PG9	22	5	2	1	010DPG9
● Nero / Black	PG11	24	5	2	1	010DPG11
● Nero / Black	PG13,5	27	6	2,5	1	010DPG13
● Nero / Black	PG16	30	6	3	1	010DPG16
● Nero / Black	PG21	36	7	3,5	1	010DPG21
○ Bianco / White	PG29	46	7,5	5	1	010DPG29



Valvole di ventilazione anticondensa

Ventilation plugs (to prevent condensation)

Valvole di ventilazione anticondensa

Ventilation plugs (to prevent condensation)

g n cod

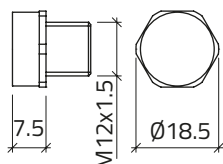

Permeabilità all'aria 2 lt. / min. $\Delta p = 70$ mbar - Pressione ingresso acqua max 0,2 bar / 60 s
 Air permeability 2 lt. / min. $\Delta p = 70$ mbar - Water inlet pressure max 0,2 bar / 60 s

● Nero / Black

1,5

10

010VV

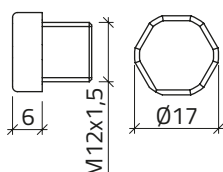

Permeabilità all'aria 0,4 lt. / min. $\Delta p = 70$ mbar - Pressione ingresso acqua max 0,6 bar / 60 s
 Air permeability 0,4 lt. / min. $\Delta p = 70$ mbar - Water inlet pressure max 0,6 bar / 60 s

● Grigio / Grey

2

1

010VV400

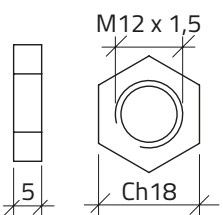

● Nero / Black

1

10

010DM12

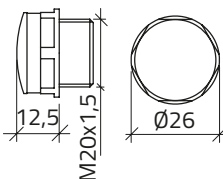

Permeabilità all'aria 12,5 lt. / min. $\Delta p = 70$ mbar - Pressione ingresso acqua max 0,1 bar / 60 s
 Air permeability 12,5 lt. / min. $\Delta p = 70$ mbar - Water inlet pressure max 0,1 bar / 60 s

● Nero / Black

5

1

010VV12500

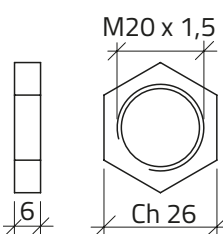

● Nero / Black

2

1

010DM20



Valvole di drenaggio

Drain plugs

Valvola di drenaggio

Drain plug

g n cod

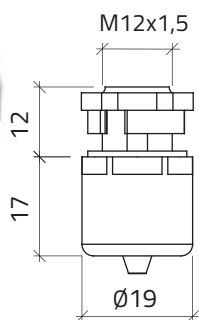

Valvola con dado - poliammide
 Plug and special locknut - polyamide

● RAL 7035

5

1

010VD

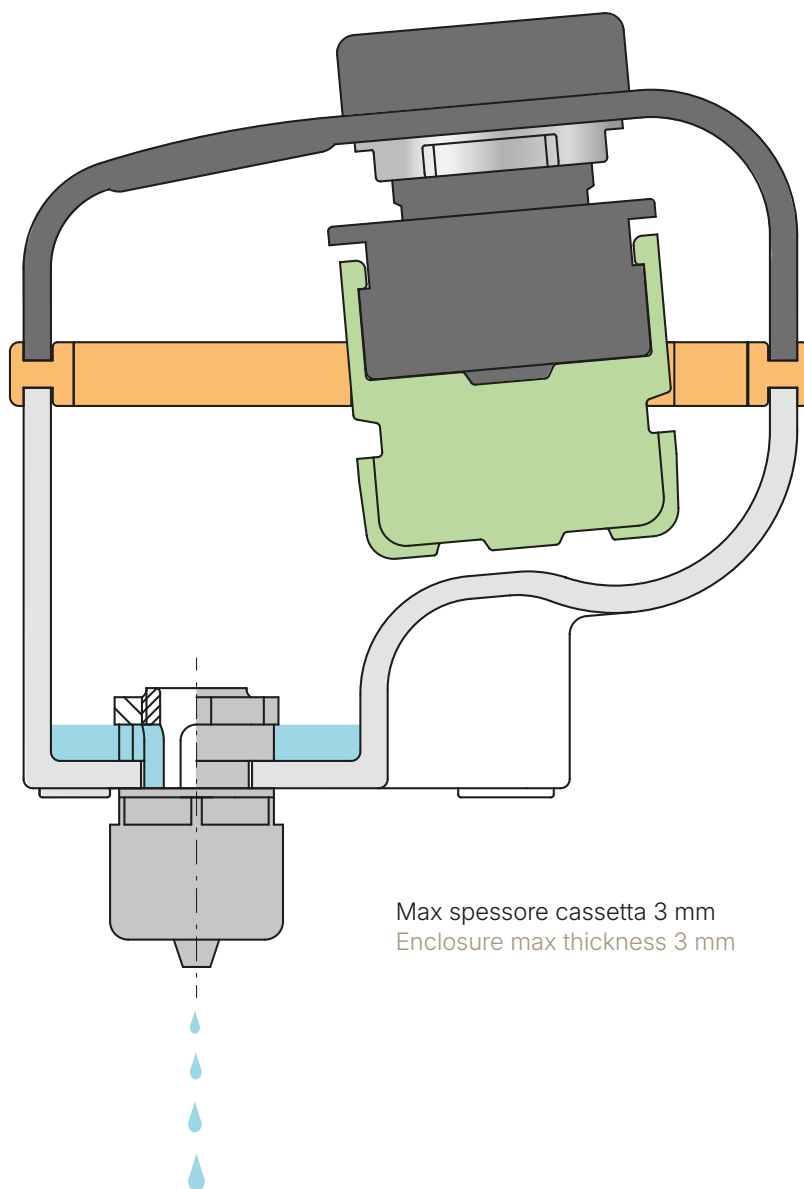

Max spessore cassetta 3 mm
 Enclosure max thickness 3 mm

016

020

032

030

040

080

050

060



Cavi USB

USB cables

Cavo tipo A-A (maschio-maschio) Cable type A-A (male-male)

g cod



0,8 m
0,8 m
● Nero / Black

37

010CUSBMM8

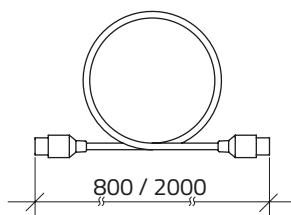

2 m
2 m
● Nero / Black

77

010CUSBMM20

Cavo maschio tipo A-libero Cable male type A-free

g cod



0,8 m
0,8 m
● Nero / Black

30

010CUSBML8



Pressacavi e riduzioni in ottone nichelato

Nickel-plated brass cable glands and adapters

Pressacavi Cable glands

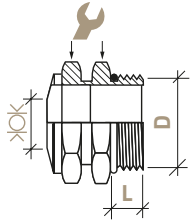

g	D			L	cod
14	M16 × 1,5	5 ÷ 9	18	17	010POM16
18	M20 × 1,5	8 ÷ 12	22	22	010POM20
32	M25 × 1,5	11 ÷ 16	28	28	010POM25
50	M32 × 1,5	15 ÷ 21	35	35	010POM32

Raccordo a gomito 45° Elbow fitting to 45°

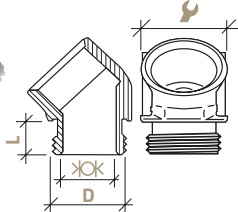

g	D			L	cod
26	M16 × 1,5	11,5	19	10	010GIM16
38	M20 × 1,5	15	23	10	010GIM20
55	M25 × 1,5	20	28	10	010GIM25
90	M32 × 1,5	27	36	10	010GIM32

Nippli Nipples

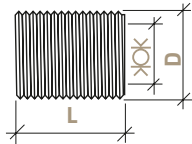

g	D		L	cod
8	M16 × 1,5	12	21	010NPM16
20	M20 × 1,5	15	24,5	010NPM20
18	M25 × 1,5	20	25	010NPM25
30	M32 × 1,5	26	32	010NPM32

Riduzioni Adapters

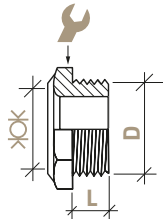

g	D			L	cod
18	M16 × 1,5	12	22	12	010BM16
22	M20 × 1,5	15	26	14	010BM20
20	M25 × 1,5	21	30	14	010BM25
28	M32 × 1,5	28	40	15	010BM32

Controdadi Locknuts

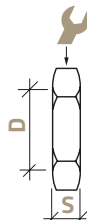

g	D		s	cod
4	M16 × 1,5	19	3	010GM16
6	M20 × 1,5	24	3,5	010GM20
12	M25 × 1,5	30	3,5	010GM25
26	M32 × 1,5	36	4,5	010GM32

016

020

032

030

040

080

050

060



Accessori per scatole pulsantiere

Accessories for push-button enclosures

Sistemi di fissaggio Installation system

g

cod

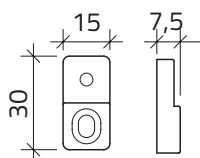

Compatibile con cassette alluminio M4-M10, cassette termoplastico CUBE
Compatible with M4-M10 aluminum boxes, CUBE thermoplastic boxes

Staffe di fissaggio 10 mm
Mounting brackets 10 mm

28

010S10

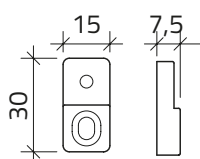

Compatibile con cassette alluminio M4-M10, cassette termoplastico CUBE
Compatible with M4-M10 aluminum boxes, CUBE thermoplastic boxes

Staffe di fissaggio 25 mm
Mounting brackets 25 mm

32

010S25

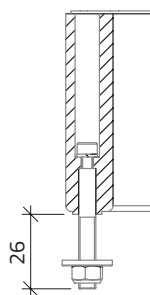

Cassette alluminio M4-M10 / M4-M10 aluminum boxes

Fissaggio con prigionieri
Fixing kit with studs

26

010SFP

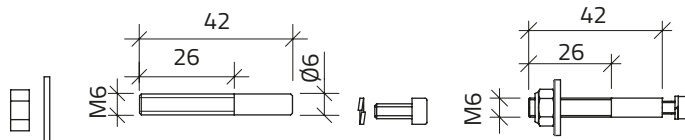

Accessori per scatole pulsantiere

Accessories for push-button enclosures

Cinghia tracolla

Shoulder belt



25 × 1400

g

46

cod

010CT25

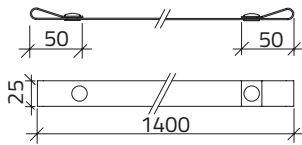

Cavo spiralato

Spiral cable



12 × 0,5 mm²

g

700

cod

010CSN12X05-3

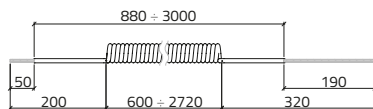

016

020

032

030

040

080

050

060