



060

**DISPOSITIVI DI COMANDO
DI SICUREZZA**

SAFETY CONTROL DEVICES



Pulsanti a palmo

Palm switches

G

Gli azionatori a palmo, per il comando e controllo di circuiti elettrici alimentati sia in CC che in CA, sono progettati per **utilizzi energici o d'urgenza**.

Il **design particolarmente accurato ed ergonomico** ne permette l'utilizzo anche avendo guanti da lavoro oppure con altre parti del corpo quali: gomito, spalla, ginocchio, piede. Inoltre la **linearità senza soluzione di continuità** evita che vi si possano impigliare indumenti, capelli, o elementi estranei. Realizzati in **resina termoplastica antiurto**, con componenti metallici in acciaio inox, possono essere installati in ambienti con atmosfera particolarmente umida o corrosiva e dove sussiste il pericolo di scariche elettrostatiche. Disponibile in due varianti: con tasto bombato o a fungo avvolgente, luminoso o no, con funzionamento momentaneo o ad aggancio. La **versione luminosa** ha svariate esecuzioni: tasto a luce continua, tasto e scatola a luce continua, tasto ad aggancio a luce continua e lampeggiante, tasto trasparente con illuminazione a due colori. Infine la grande superficie dei tasti consente di stampare complesse informazioni.

P

Palm switches for the command and control of both DC and AC circuits are designed for **energetic or emergency use**.

The particularly **careful and ergonomic design** allows them to be pushed even when wearing work gloves or using other parts of the body such as elbow, shoulder, knee and foot. Moreover its **dome shape** prevents clothing, hair or other elements from being caught up. Made from **shockproof thermoplastic resin**, with stainless steel parts, they can be installed in particularly damp or corrosive atmospheric environments where there is the risk of electrostatic discharge.

They are available in two models: with dome or mushroom buttons, normal or illuminated, momentary or latching. The **illuminated models** can have a steady light button, a steady light button and enclosure, latching button with steady and flashing light, clear button with two-colour light. Furthermore the big button surface allows complex symbols to be printed on.

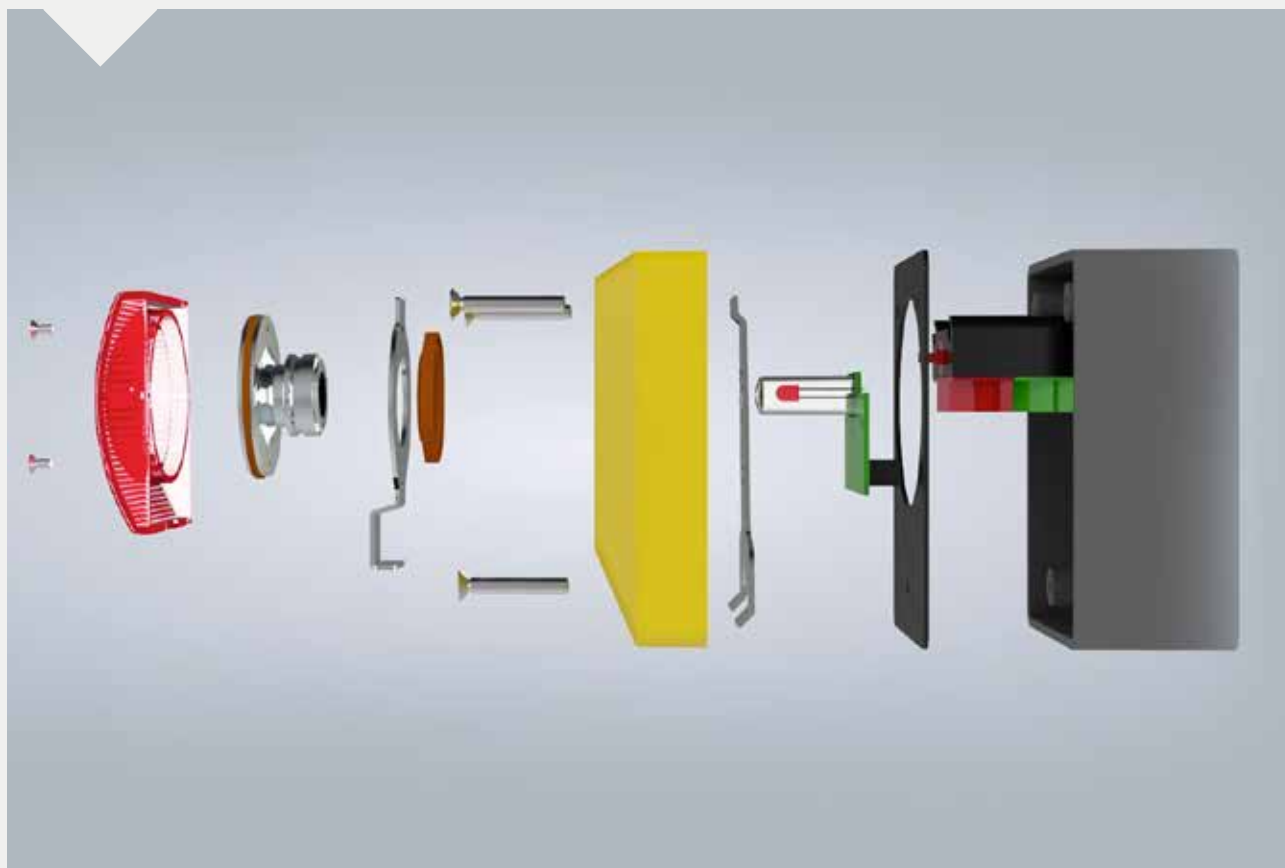

Pulsanti a palmo Palm switches



Meccanicamente resistente
Strong and hard



Adatto ad alte temperature
Heat resistant



Adatto a basse temperature
Cold resistant



Resistente agli shock
Shock resistant



Ampia gamma di utilizzo
Wide range of use

Pulsanti a palmo Palm switches

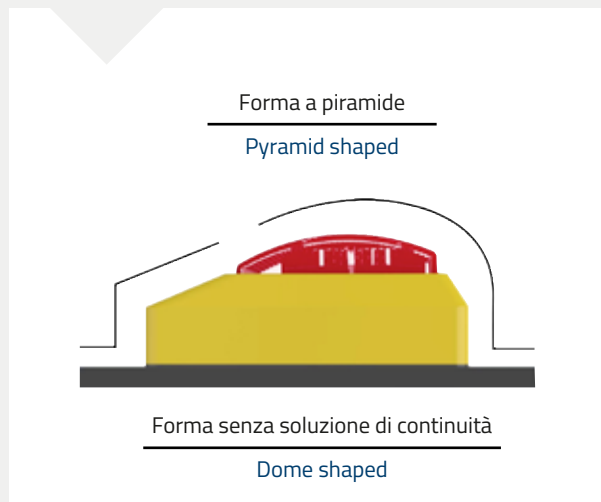
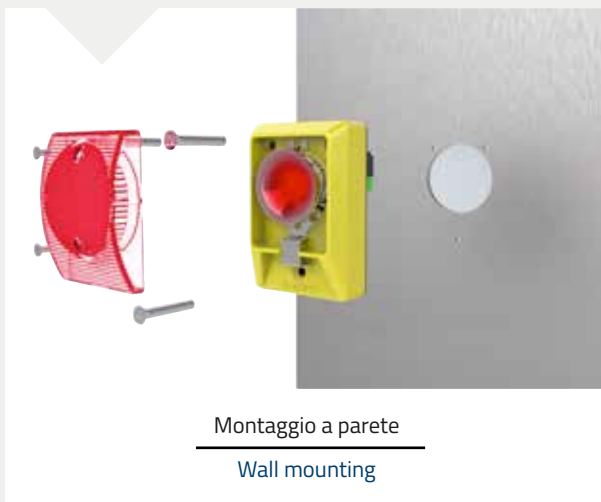

Pulsanti di emergenza a palmo momentanei normali

Momentary normal emergency stop palm switches

Pulsanti di emergenza momentanei normali

Normal momentary emergency stop push-buttons

g

cod

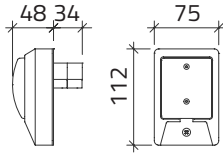

Tasto bombato senza custodia / Dome button without enclosure

● Rosso / Red

284

060APTR

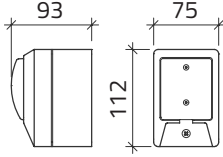
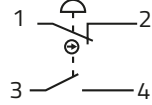

Tasto bombato con custodia / Dome button with enclosure

● Rosso / Red

366

060APTRC

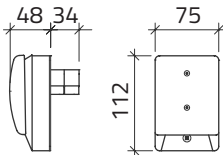
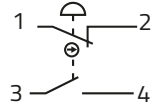

Tasto a fungo senza custodia / Mushroom button without enclosure

● Rosso / Red

284

060APFR

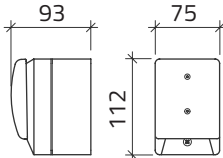
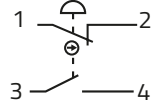

Tasto a fungo con custodia / Mushroom button with enclosure

● Rosso / Red

366

060APFRC

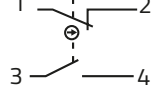

Pulsanti di emergenza a palmo ad aggancio normali

Latching normal emergency stop palm switches

Pulsanti di emergenza ad aggancio

Latching emergency stop push-buttons

g

cod

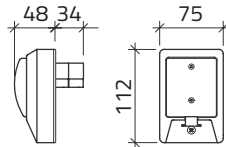

Tasto bombato senza custodia / Dome button without enclosure

● Rosso / Red

305

060APATR

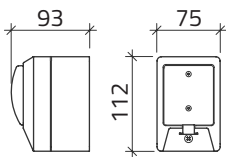
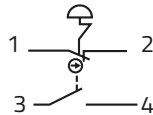

Tasto bombato con custodia / Dome button with enclosure

● Rosso / Red

387

060APATRC

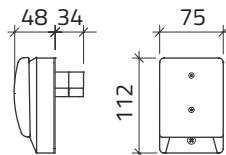
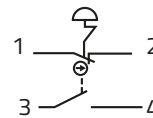

Tasto a fungo senza custodia / Mushroom button without enclosure

● Rosso / Red

305

060APAFR

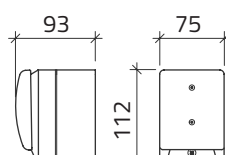
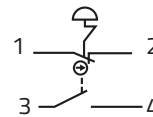

Tasto a fungo con custodia / Mushroom button with enclosure

● Rosso / Red

387

060APAFRC

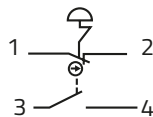

Pulsanti di emergenza a palmo momentanei luminosi Momentary illuminated emergency stop palm switches

Pulsanti di emergenza a palmo luminosi Illuminated emergency stop palm switches

g

cod

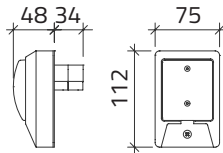

Tasto bombato senza custodia/ Dome button without enclosure

● Rosso / Red

291

060APTLR

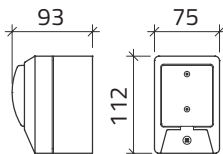
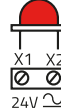
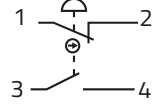

Tasto bombato con custodia / Dome button with enclosure

● Rosso / Red

373

060APTLRC

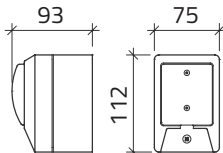
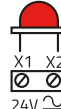
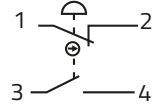

Tasto bombato con custodia luminosa Dome button with illuminated enclosure

● Rosso / Red

373

060APTLRCL

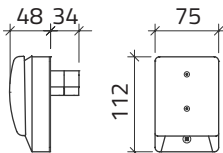
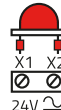
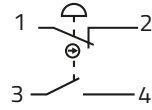

Tasto a fungo senza custodia Mushroom button without enclosure

● Rosso / Red

291

060APFLR

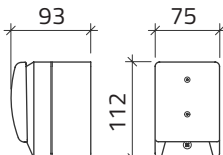
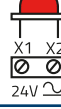
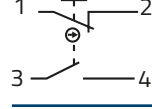

Tasto a fungo con custodia / Mushroom button with enclosure

● Rosso / Red

373

060APFLRC

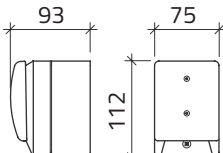
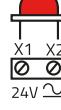
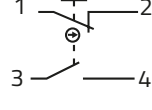

Tasto a fungo con custodia luminosa Mushroom button with illuminated enclosure

● Rosso / Red

373

060APFLRCL

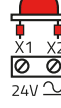
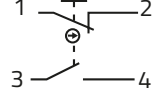

Pulsanti di emergenza a palmo ad aggancio luminosi Illuminated latching emergency stop palm switches

Pulsanti di emergenza a palmo ad aggancio luminosi Illuminated latching emergency stop palm switches

g

cod

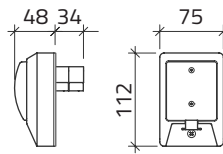

Tasto bombato senza custodia / Dome button without enclosure

● Rosso / Red

312

060APATLR

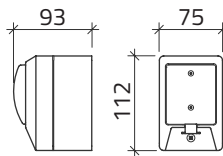
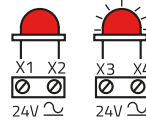
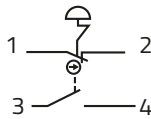

Tasto bombato con custodia / Dome button with enclosure

● Rosso / Red

394

060APATLRC

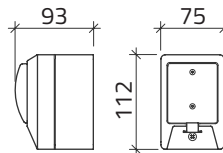
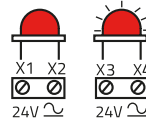
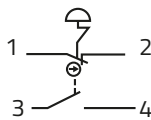

Tasto bombato con custodia luminosa Dome button with illuminated enclosure

● Rosso / Red

394

060APATRLCL

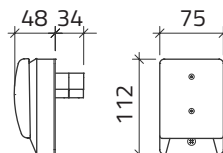
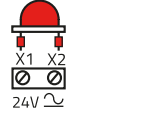
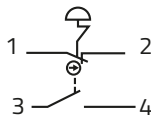

Tasto a fungo senza custodia / Mushroom button without enclosure

● Rosso / Red

312

060APAFRLR

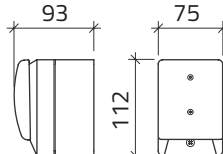
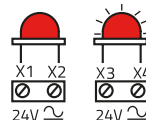
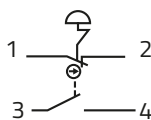

Tasto a fungo con custodia / Mushroom button with enclosure

● Rosso / Red

394

060APAFRLC

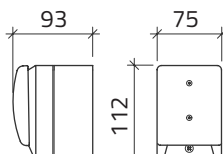
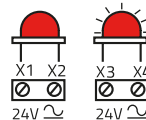
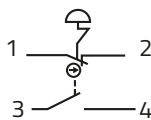

Tasto a fungo con custodia luminosa Mushroom button with illuminated enclosure

● Rosso / Red

394

060APAFRLCL

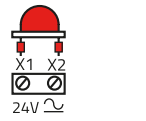
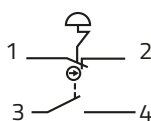

Pulsanti a palmo normali

Normal palm switches

Pulsanti normali Normal push-buttons

g

cod

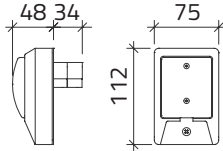

Tasto bombato senza custodia / Dome button without enclosure

● Nero / Black	284	060APTN
● Verde / Green	284	060APT V
● Giallo / Yellow	284	060APT G
● Blu / Blue	284	060APTBL

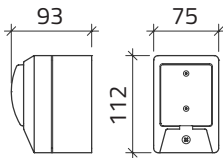
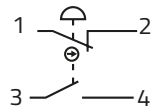

Tasto bombato con custodia / Dome button with enclosure

● Nero / Black	366	060APTNC
● Verde / Green	366	060APTVC
● Giallo / Yellow	366	060APTGC
● Blu / Blue	366	060APTBLC

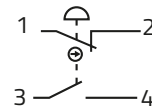

Pulsanti a palmo normali Normal palm switches

Pulsanti normali Normal push-buttons

g **cod**

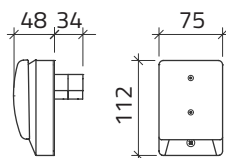

Tasto a fungo senza custodia / Mushroom button without enclosure

● Nero / Black	284	060APFN
● Verde / Green	284	060APFV
● Giallo / Yellow	284	060APFG
● Blu / Blue	284	060APFBL

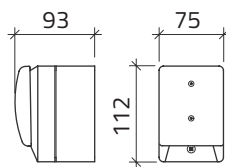
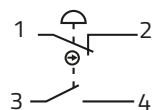

Tasto a fungo con custodia / Mushroom button with enclosure

● Nero / Black	366	060APFNC
● Verde / Green	366	060APFVC
● Giallo / Yellow	366	060APFGC
● Blu / Blue	366	060APFBLC

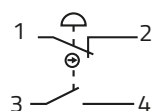

Pulsanti a palmo luminosi Illuminated palm switches

Pulsanti a palmo luminosi Illuminated palm switches

g

cod

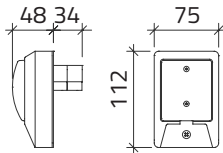

Tasto bombato senza custodia / Dome button without enclosure

● Verde / Green	291	060APTLV
● Giallo / Yellow	291	060APTLG
● Blu / Blue	291	060APTLBL
○ Bianco / White	291	060APTLB

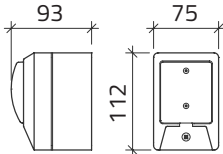
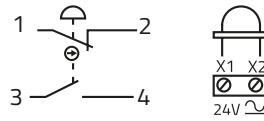

Tasto bombato con custodia / Dome button with enclosure

● Verde / Green	373	060APTLVC
● Giallo / Yellow	373	060APTLGC
● Blu / Blue	373	060APTLBLC
○ Bianco / White	373	060APTLBC

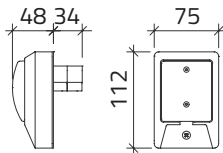
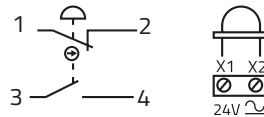

Tasto bombato senza custodia / Dome button without enclosure

● Rosso-verde / Red-green	291	060APTLRV
---------------------------	-----	------------------

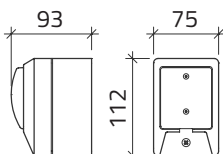
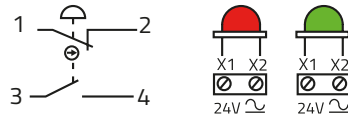

Tasto bombato con custodia / Dome button with enclosure

● Rosso-verde / Red-green	373	060APTLRV
---------------------------	-----	------------------

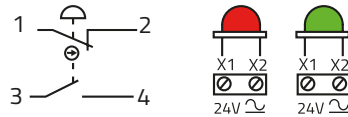

Pulsanti a palmo luminosi Illuminated palm switches



Pulsanti a palmo luminosi Illuminated palm switches

g **cod**





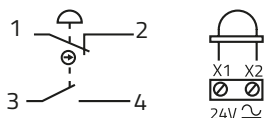

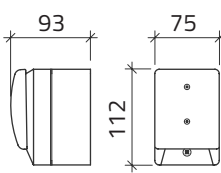
Tasto a fungo senza custodia / Mushroom button without enclosure

● Verde / Green	291	060APFLV
● Giallo / Yellow	291	060APFLG
● Blu / Blue	291	060APFLBL
○ Bianco / White	291	060APFLB

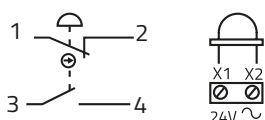

Tasto a fungo con custodia / Mushroom button with enclosure

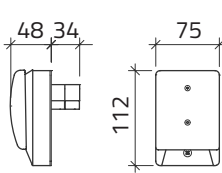
● Verde / Green	373	060APFLVC
● Giallo / Yellow	373	060APFLGC
● Blu / Blue	373	060APFLBLC
○ Bianco / White	373	060APFLBC

Tasto a fungo senza custodia / Mushroom button without enclosure

● Rosso-verde / Red-green	291	060APFLRV
---------------------------	-----	------------------

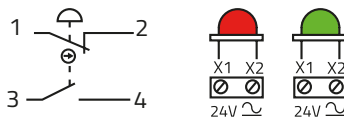
Tasto a fungo con custodia / Mushroom button with enclosure

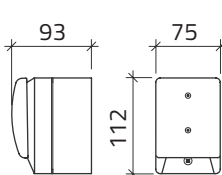
● Rosso-verde / Red-green	373	060APFLRVC
---------------------------	-----	-------------------

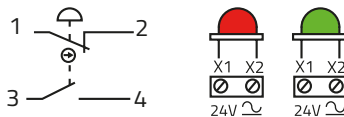

Suffissi per stampa simboli su tasti Suffixes for printing symbols on buttons

Far seguire al codice del prodotto il suffisso del simbolo desiderato
Item code is to be followed by the suffix of the required symbol



cod

S48



cod

S153



S148



S144



S55



S154



S152



S159

Accessori Accessories

Elemento di protezione per pulsante a palmo Protective shroud for palm switch

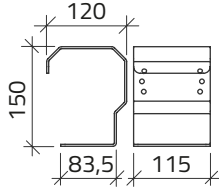

Acciaio / Steel

g	cod
1,130	060SEP

Tasti per pulsanti a palmo normale Buttons for normal palm switches

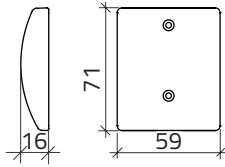

Tasto bombato / Dome button

● Nero / Black	25	060TBN
● Rosso / Red	25	060TBR
● Verde / Green	25	060TBV
● Giallo / Yellow	25	060TBG
● Blu / Blue	25	060TBL

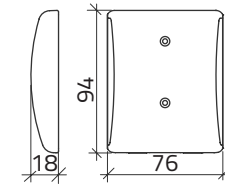

Tasto a fungo / Mushroom button

● Nero / Black	36	060TFN
● Rosso / Red	36	060TFR
● Verde / Green	36	060TFV
● Giallo / Yellow	36	060TFG
● Blu / Blue	36	060TFBL

Tasti per pulsante a palmo luminosi Buttons for illuminated palm switches

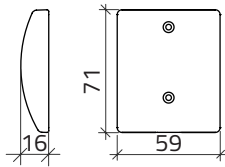

Tasto bombato / Dome button

● Rosso / Red	25	060TBLR
● Verde / Green	25	060TBLV
● Giallo / Yellow	25	060TBLG
● Blu / Blue	25	060TBLBL
○ Bianco / White	25	060TBLB
○ Trasparente / Clear	25	060TBLI

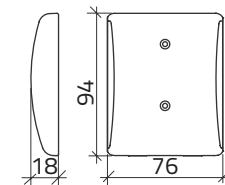

Tasto a fungo / Mushroom button

● Rosso / Red	36	060TFLR
● Verde / Green	36	060TFLV
● Giallo / Yellow	36	060TFLG
● Blu / Blue	36	060TFLBL
○ Bianco / White	36	060TFLB
○ Trasparente / Clear	36	060TFLI

Custodia per azionatore a palmo Palm switch enclosures

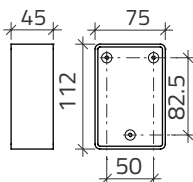

Custodia non luminosa / Not illuminated enclosure

● Grigio / Grey	115	060SGR
-----------------	-----	--------

Custodia luminosa / Illuminated enclosure

● Rosso / Red	115	060SRT
---------------	-----	--------

Pulsanti a palmo

Palm switches

Caratteristiche tecniche

Rispondenza alle norme	EN-IEC60947-1, EN-IEC60947-5-1 UNI EN 13850, UNI EN ISO 12100 EN-IEC60947-5-5 UNI CEI EN 45545/2, CEI EN 61373																														
Omologazioni	CE, (UL, CSA solo elementi di contatto 030FA-030FAA / 030FC-030FCF)																														
Limiti di temperatura	Funzionamento $\geq -30^{\circ}\text{C}$ e $\leq +120^{\circ}\text{C}$ Stoccaggio $\geq -40^{\circ}\text{C}$ e $\leq +125^{\circ}\text{C}$																														
Grado di protezione	IP66-IP69K (EN-IEC60529-DIN40050)																														
Protezione contro gli impatti	IK08 (EN-IEC62262)																														
Materiale custodia	PA Poliammide V0																														
Materiale guarnizione	Gomma-sughero																														
Materiale viti custodia	Acciaio inox AISI 304																														
Coppia di serraggio	Viti custodia 1 = 2,5 Nm (8,8 ÷ 22,1 Lb-in) Viti terminali 0,8 = 1,2 Nm (7,1 ÷ 10,6 Lb-in)																														
Durata meccanica	3 milioni di manovre																														
Elementi di contatto	NO-NC inclusi apertura positiva del contatto NC secondo EN, IEC 60947-5-1																														
Funzionamento contatti	Azionamento lento con autopulitura e strisciamento delle pastiglie																														
Materiale contatti	Pastiglie in Ag 1000 / 1000																														
Tensione nominale di isolamento	690 V secondo : EN-IEC 60947-1																														
Corrente nominale termica	Ith 10A																														
Categorie nominali di impiego	AC15-DC13 secondo EN-IEC60947-5-1 A600 - P300 secondo UL508																														
	<table border="1"> <thead> <tr> <th colspan="3">AC</th> </tr> <tr> <th>Ue V</th> <th></th> <th>Ie A</th> </tr> </thead> <tbody> <tr> <td>24</td> <td></td> <td>10</td> </tr> <tr> <td>110</td> <td></td> <td>6</td> </tr> <tr> <td>230</td> <td></td> <td>3</td> </tr> </tbody> </table> <table border="1"> <thead> <tr> <th colspan="3">DC</th> </tr> <tr> <th>Ue V</th> <th></th> <th>Ie A</th> </tr> </thead> <tbody> <tr> <td>24</td> <td></td> <td>5</td> </tr> <tr> <td>110</td> <td></td> <td>1,1</td> </tr> <tr> <td>230</td> <td></td> <td>0,55</td> </tr> </tbody> </table>	AC			Ue V		Ie A	24		10	110		6	230		3	DC			Ue V		Ie A	24		5	110		1,1	230		0,55
AC																															
Ue V		Ie A																													
24		10																													
110		6																													
230		3																													
DC																															
Ue V		Ie A																													
24		5																													
110		1,1																													
230		0,55																													

Versioni luminose Led incluso con alimentazione 24AC-DC

Technical data

Compliance with Standards	EN-IEC60947-1, EN-IEC60947-5-1 UNI EN 13850, UNI EN ISO 12100 EN-IEC60947-5-5 UNI CEI EN 45545/2, CEI EN 61373																														
Approvals	CE, (UL, CSA only for contacts blocks 030FA-030FAA / 030FC-030FCF)																														
Temperature ranges	Working $\geq -30^{\circ}\text{C}$ e $\leq +120^{\circ}\text{C}$ Storage $\geq -40^{\circ}\text{C}$ e $\leq +125^{\circ}\text{C}$																														
Protection degree	IP66-IP69K (EN-IEC60529-DIN40050)																														
Protection against impact	IK08 (EN-IEC62262)																														
Housing material	PA Polyamide V0																														
Gasket material	Cork-rubber																														
Screws material	Stainless steel AISI 304																														
Tightening torque	Cover screws 1 = 2,5 Nm (8,8 ÷ 22,1 Lb-in) Terminal screws 0,8 = 1,2 Nm (7,1 ÷ 10,6 Lb-in)																														
Mechanical durability	3 millions operation																														
Contacts blocks	NO-NC included positive opening on NC contact according to EN, IEC 60947-5-1																														
Contact actuation	Slow action with self cleaning by pads creeping																														
Contacts material	Pads in Ag 1000 / 1000																														
Rated insulation voltage	690 V according to : EN-IEC60947-1																														
Rated thermal current	Ith 10A																														
Electrical ratings	AC15-DC13 according to EN-IEC60947-5-1 A600 - P300 according to UL508																														
	<table border="1"> <thead> <tr> <th colspan="3">AC</th> </tr> <tr> <th>Ue V</th> <th></th> <th>Ie A</th> </tr> </thead> <tbody> <tr> <td>24</td> <td></td> <td>10</td> </tr> <tr> <td>110</td> <td></td> <td>6</td> </tr> <tr> <td>230</td> <td></td> <td>3</td> </tr> </tbody> </table> <table border="1"> <thead> <tr> <th colspan="3">DC</th> </tr> <tr> <th>Ue V</th> <th></th> <th>Ie A</th> </tr> </thead> <tbody> <tr> <td>24</td> <td></td> <td>5</td> </tr> <tr> <td>110</td> <td></td> <td>1,1</td> </tr> <tr> <td>230</td> <td></td> <td>0,55</td> </tr> </tbody> </table>	AC			Ue V		Ie A	24		10	110		6	230		3	DC			Ue V		Ie A	24		5	110		1,1	230		0,55
AC																															
Ue V		Ie A																													
24		10																													
110		6																													
230		3																													
DC																															
Ue V		Ie A																													
24		5																													
110		1,1																													
230		0,55																													

Illuminated models Led 24AC-DC included

Dima di foratura

Drilling template

Con custodia
With case

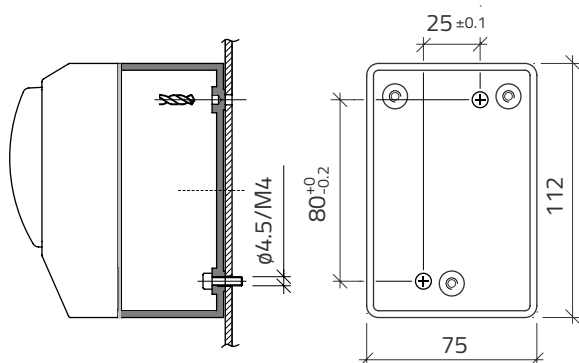

A incasso
Wall mount

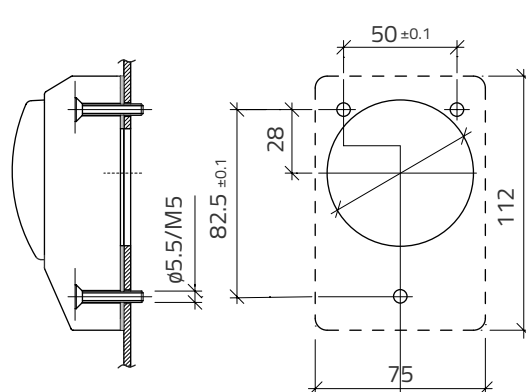



Pulsantiera mobile

Hand-held push-button control unit

■ PULSANTIERA MOBILE

La pulsantiera mobile è stata progettata per rispondere alle necessità di avere la portabilità di alcuni comandi elettrici manuali, garantendo l'interfaccia uomo macchina, anche in situazioni dove occorre posizionarsi in zone specifiche. La forma particolare è stata appositamente progettata per un ottimo connubio tra ergonomia, facilità di impugnatura e spazio a disposizione per i comandi manuali elettromeccanici. Dotata di piastra frontale in alluminio anodizzato, facilmente lavorabile, la pulsantiera si rende adattabile a innumerevoli configurazioni e consente il contenimento di piccoli display, touch screen e altri dispositivi ausiliari di comando e controllo. La piastra è trattenuta da viti in acciaio inox, garantendo a tutta la pulsantiera un elevato grado di resistenza sia alla corrosione sia alla tenuta ai liquidi (IP66). Il corpo della pulsantiera è realizzato in materiale plastico antiurto particolarmente resistente in caso di caduta accidentale (IK07). Essa è inoltre dotata di aletta perimetrale disegnata per coprire e proteggere gli operatori di comando da azionamenti involontari a seguito di cadute dell'apparecchiatura. L'articolo è disponibile in due colorazioni: giallo RAL 1003 oppure grigio RAL 7016. Un'ampia gamma di accessori dedicati completano l'apparecchiatura, quali staffa magnetica, staffa per fissaggio a muro, staffa raccolta cavo e cinghia a tracolla.

■ MODULAR SYSTEM FOR PUSH-BUTTON

The hand-held push-button control unit has been designed to have some manual electrical commands within operator's reach, thus granting a man-machine interface, even when it is required to work in particular positions.

Its special shape is the result of a perfect combination design of ergonomics, easy grip and available space for the manual electromechanical commands.

Provided with a front easy-to-drill anodized aluminium plate, the enclosure is suitable for multiple configurations and can house small display panels, touch screens and other auxiliary command and control devices.

The plate is fastened using stainless steel screws, thus granting high resistance to both corrosion and liquid entrance (IP66).

The enclosure of the control unit is made of high impact resistant plastic (IK07) and is provided with a shaped border around its perimeter, which has been designed to protect the operators from their accidental operation in case of control unit drop.

It is available in two colours: yellow RAL 1003 or dark grey RAL 7016.

A wide range of accessories, like magnetic mounting plate, wall-mounting bracket, cable bracket and shoulder belt, are available to complete the control unit.



Pulsantiera mobile Hand-held push-button control unit



La pulsantiera è dotata di agevoli superfici per l'installazione di operatori.
The control unit has wide surfaces where the operators can be easily housed.



L'impugnatura può accogliere nei lati destro o sinistro un pulsante di abilitazione a tre posizioni.

The right or the left side of the grip can house a three-position enabling push-button.



La pulsantiera è dotata di un pratico cinghiolo che garantisce un sicuro utilizzo.

The control unit is equipped with a useful strap assuring a safe operation.



L'introduzione del cavo di alimentazione è favorito da un pratico pressacavo che protegge eventuali torsioni, mentre un robusto serracavo evita sfilacciamenti.

The power cable can be easily fitted thanks to a spiral cable gland, which protects from a possible twisting, and a strong wire clamp avoids cable fraying.

Pulsantiera mobile Hand-held push-button control unit



La parte superiore della pulsantiera adotta ancoraggi per l'accessorio a tracolla.
The upper side of the control unit is provided with openings to fit the shoulder belt.



Pratici accessori completano la gamma: supporto a parete con gancio avvolgicavo e piastra magnetica.
Useful accessories, like wall-mounting bracket, cable bracket and magnetic mounting plate complete the range.



Tutta la struttura del contenitore è studiata per realizzare organizzate configurazioni di layout con diversi componenti elettromeccanici.
The whole enclosure structure is so designed to get layout configurations with different electromechanical components.

Pulsantiera mobile Hand-held push-button control unit

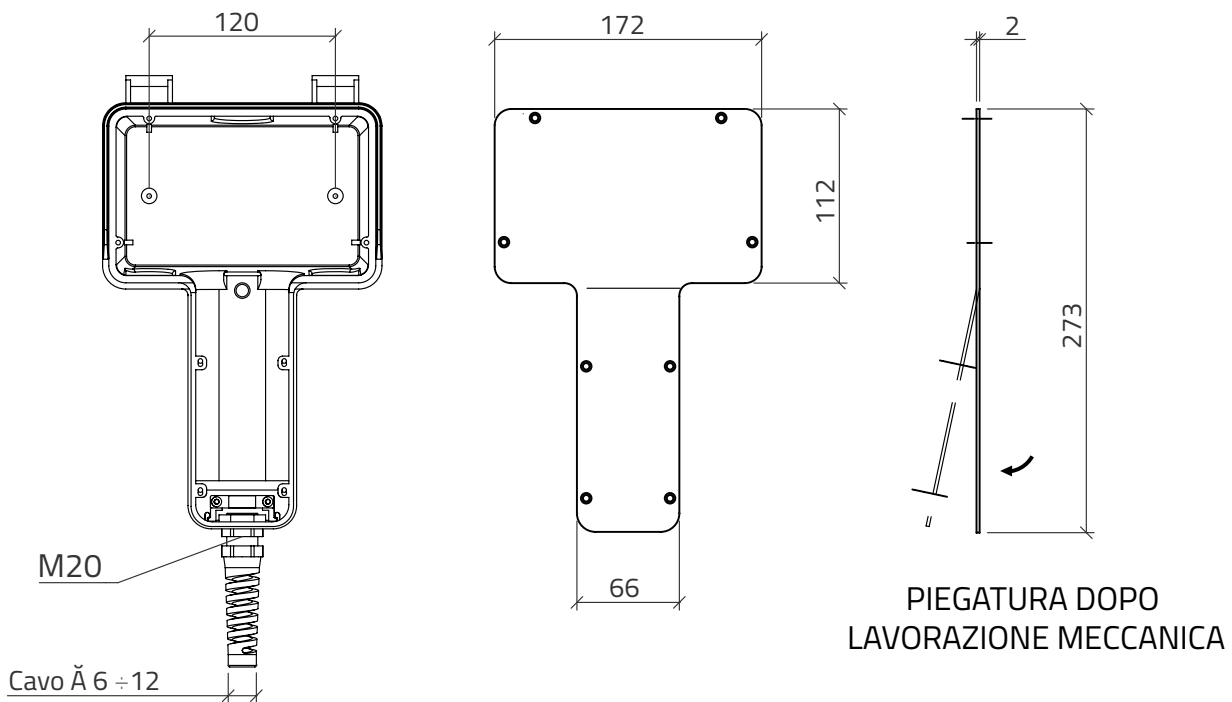
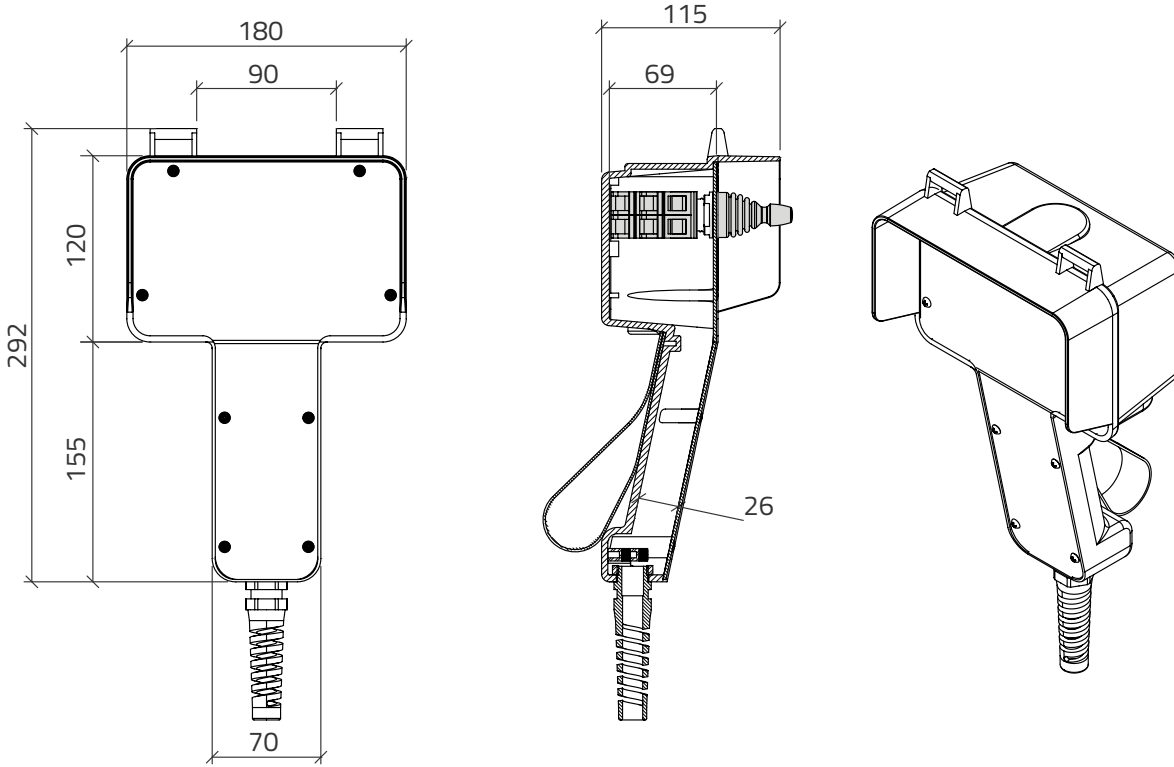

Pulsantiera mobile Hand-held push-button control unit

Scatola pulsantiera in resina termoplastica Push-button enclosure made of thermoplastic resin



Completa di piastra in alluminio, senza forature.
Provided with aluminium undrilled plate.

● Giallo / Yellow

g

cod

680

060PMG



Completa di piastra in alluminio, senza forature.
Provided with aluminium undrilled plate.

● Grigio / Grey

680

060PMGR

Per richieste speciali contattare la nostra organizzazione commerciale.
For special requirements get in touch with our commercial department.

Pulsantiera mobile

Hand-held push-button control unit



Staffa fissaggio parete / Wall-mounting bracket

Acciaio / Steel

g

465

cod

060SFP

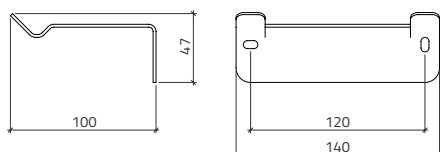

Staffa fissaggio cavo / Cable bracket

Acciaio / Steel

g

165

cod

060SFC

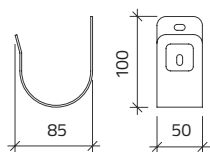

Staffa fissaggio magnetica / Magnetic mounting plate

Acciaio / Steel

g

200

cod

060PFM

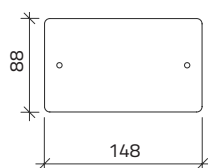

Piastra non forata (ricambio) / Undrilled plate (spare part)

Alluminio anodizzato / Anodised aluminium

g

160

cod

060PPM

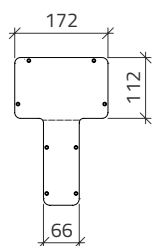

Pulsantiera mobile

Hand-held push-button control unit



Cinghia tracolla / Shoulder belt

25x1400 mm

g

cod

90

010CT25

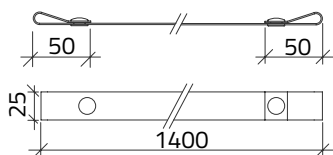

Cavo Spiraleto / Spiral cable

12x0,5 mm²

g

cod

700

010CSN12X05-3

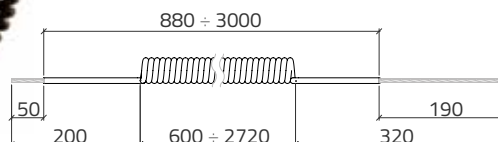

Caratteristiche tecniche

Certificazioni	CE
Rispondenza alle norme	IEC-EN60529
Rispondenza alle norme	IEC-EN60947-1, IEC-EN60947-5-1
Temperature di operatività	-25° ÷ +65°C
Grado di protezione	IP66 - IP69K (IEC-EN60529 - DIN40050)
Protezione contro gli impatti	IK07 (IEC-EN62262)
Resistenza agli urti	50g (durata: 11ms) EN-IEC 60068-2-27
Materiale custodia	Polimero termoplastico ad alto impatto
Processo di fabbricazione	Stampaggio ad iniezione
Materiale guarnizione	Schiuma EPDM + adesivo
Materiale viti custodia	Acciaio inossidabile AISI 304
Piastra frontale	Alluminio anodizzato - Spessore 2mm
Coppia di serraggio	1 ÷ 2,5Nm (8.8-22.1 Lb-in)
Entrata cavo	M20x1,5
Categoria di sovratensione	Classe I (IEC-EN61140)
Maniglia con fori sinistro/destro	Per Q16P3Pxxx pulsanti di abilitazione a 3 posizioni
Periodo di garanzia	18 mesi

Technical data

Approvals	CE
Compliance with standards	IEC-EN60529
Compliance with standards	IEC-EN60947-1, IEC-EN60947-5-1
Operating temperatures	-25° ÷ +65°C
Protection degree	IP66 - IP69K (IEC-EN60529 - DIN40050)
Protection against impact	IK07 (IEC-EN62262)
Shock resistance	50g duration=11ms (EN-IEC 60068-2-27)
Housing material	High impact grade thermoplastic polymer
Manufacturing process	Injection moulding
Gasket material	EPDM Foam + adhesive
Screw material	Stainless steel AISI 304
Front plate	Anodized aluminium - Thickness 2mm
Tightening torque	1 ÷ 2,5Nm (8.8-22.1 Lb-in)
Cable entry	M20x1,5
Overvoltage category	Class I (IEC-EN61140)
Handle with left / right knockouts	For Q16P3Pxxx 3 position enabling safety switch
Warranty period	18 months



Dispositivi di comando a due mani

Two-hand control devices

DEFINIZIONE DI COMANDO A DUE MANI (UNI EN ISO 12100)

3.28.4

Comando a due mani: comando ad azione mantenuta che richiede almeno l'azionamento simultaneo dei due comandi manuali (attuatori) per avviare e mantenere il funzionamento della macchina o degli elementi di quest'ultima, assicurando così protezione alla persona che li aziona.

CLASSIFICAZIONE DEI COMANDI A DUE MANI (CEI EN 60204.1 PUNTO 9.2.6.2)

9.2.6.2

Comandi a due mani: esistono tre tipi di comandi a due mani, la cui selezione dipende dalla valutazione dei rischi. Essi devono avere le caratteristiche seguenti:

TIPO 1: questo tipo richiede:

- la fornitura di due dispositivi di comando dell'attivazione che necessitano l'uso contemporaneo delle due mani;
- l'attivazione continua durante le situazioni pericolose;
- l'interruzione dell'attivazione della macchina al rilascio di uno qualsiasi dei dispositivi di comando dell'attivazione, se le condizioni rimangono pericolose.

TIPO 2: comando di tipo 1 che richiede il rilascio di entrambi i dispositivi di comando dell'attivazione, prima che il funzionamento della macchina possa ripartire.

TIPO 3: comando di tipo 2 che richiede un'attivazione contemporanea dei dispositivi di comando dell'attivazione come segue:

- deve essere necessario fare funzionare i dispositivi di comando dell'attivazione entro un determinato tempo limite minore o uguale a 0,5 s (Appendice B);
- quando viene superato il tempo limite, entrambi i dispositivi di comando dell'attivazione devono essere rilasciati prima che possa essere iniziata una nuova operazione.

DEFINITION OF TWO HAND CONTROL (UNI EN ISO 12100)

3.28.4

Two hand control: maintained action control which requires at least the simultaneous activation of the two manual controls (actuators) to start up and continue running the machine and its elements, thus ensuring that operators are protected.

CLASSIFICATION OF TWO HAND CONTROLS (CEI EN 60204.1 ITEM 9.2.6.2)

9.2.6.2

Two hand controls: there are three types of two hand control, the selection of which depends on risk assessment. They must have the following features:

TYPE 1: this type must have:

- the supply of two activation control devices which require the simultaneous use of both hands;
- constant activation during dangerous situations;
- machine cut-off when any activation control is released, if conditions continue to be dangerous.

TYPE 2: type 1 control which requires the release of both activation control devices for the machine to start running again.

TYPE 3: type 2 control which requires the simultaneous activation of the activation control devices as follows:

- it must be possible to engage the activation control devices within a set time equal to or less than 0.5 seconds (Appendix B);
- when the time limit is up, both activation control devices must be released before a new operation can begin.



Pulsantiera a due mani

Two-hand control device

■ SISTEMA MODULARE PER PULSANTIERE

Il sistema modulare per pulsantiera di comando, che la New Elfin ha realizzato pensando alle esigenze del mercato e del tuo lavoro trova impiego nel settore dell'automazione industriale, è dotato di una serie di componenti che permettono di configurare svariate strutture ottimizzate per essere integrate con le macchine utensili con cui dovranno interagire come presse, piegatrici, saldatrici laser ecc.

■ COLORAZIONE

La scelta delle colorazioni in toni di grigio e dell'alluminio satinato permettono l'armonizzazione estetica con gli apparati di destinazione; la colorazione in toni neutri evita un eccessivo impatto cromatico che può andare anche a discapito della concentrazione degli operatori alle macchine.

■ DIMENSIONI E FORMA

Nel progettare il nuovo comando a due mani è stata valutata la necessità di installazione in spazi ridotti e quindi ne è nato un prodotto con dimensioni 380 x 90 x 90 mm e con un notevole volume interno. La forma ergonomica del nuovo comando a due mani conferisce un notevole comfort durante l'utilizzo; la dimensione della sezione di appoggio del palmo permette una contrapposizione tra il pollice e le altre dita facilitando l'azionamento dei pulsanti.

■ SISTEMA MODULARE PER PULSANTIERE

L'estrema modularità del sistema permette di configurare anche soluzioni a braccio di sostegno dove è possibile applicare diversi componenti specifici. La forma particolare dei giunti garantisce solidità e rigidità alla struttura.

■ KIT DI RUOTE

Il kit di ruote risolve razionalmente il problema della mobilità senza compromettere la solidità di appoggio della base.

■ KIT DI CONNESSIONE

Il kit di connessione risolve efficacemente tutti i problemi di cablaggio tra i numerosi possibili componenti.

■ MODULAR SYSTEM FOR P/B PANELS

The modular system for push-button panels, specifically designed by New Elfin to meet specific market and working needs is provided with several components allowing the user to configure multiple structures to be integrated in machine, tools, like presses, folding machines, laser welding machines, etc.

■ COLORATION

The range of colours available, from grey to satin aluminium, enhance the aesthetic integration with existing equipment, while the use of neutral shades reduces the chromatic impact that could distract machine operators during work.

■ DIMENSIONS AND SHAPE

The new two-hand control, device designed to be installed in small areas, has dimensions of 380 x 90 x 90 mm and very large internal volume. Its ergonomic shape enhances comfort during use, while the size of the palm resting area enables operators to easily grasp the buttons between the thumb and fingers.

■ MODULAR SYSTEM FOR P/B PANELS

The versatility and modularity of the system can also be fitted with a support arm, which can be used to hold a wide range of specific components. The truncated conical shape of the joints confers solidity and rigidity to the frame.

■ CASTOR KIT

The castor kit offers a rational solution to the problem of mobility without affecting the overall stability of the base.

■ CONNECTION KIT

The connection kit allows to easily wire up all the components installed on the base.

Pulsantiera a due mani Two-hand control device



Dispositivi di comando a due mani Two-hand control devices

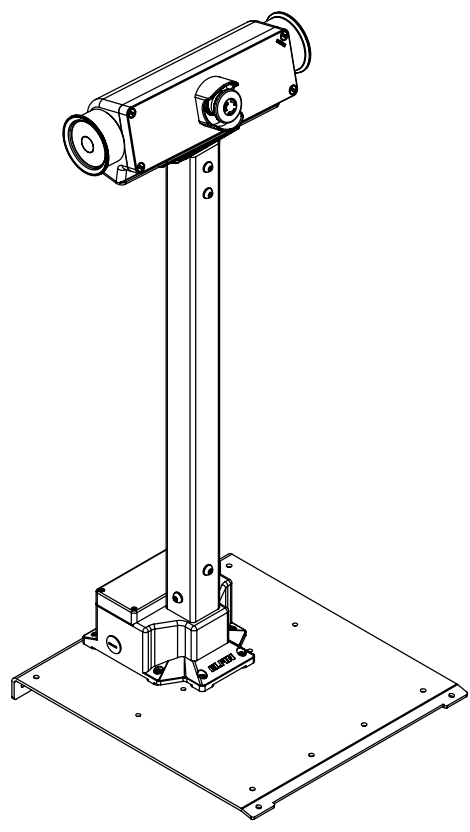
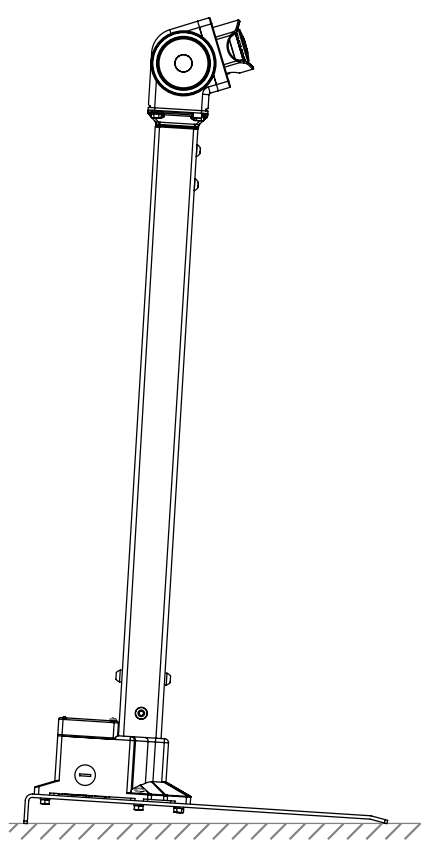
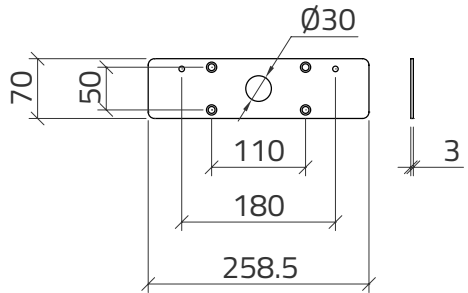
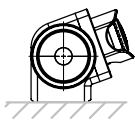
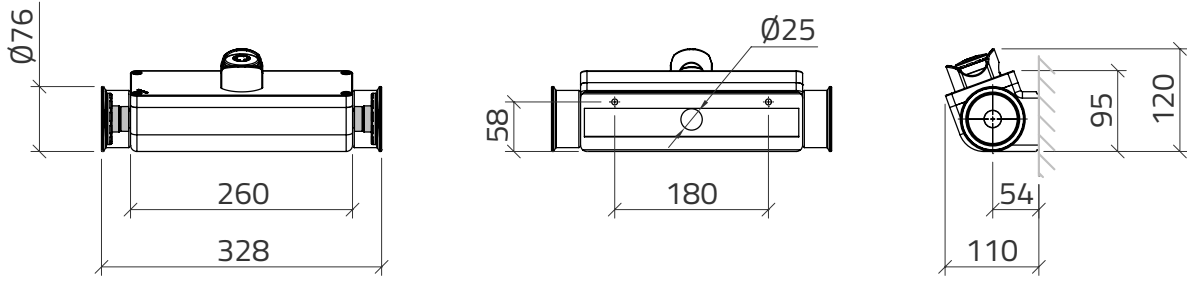

Dispositivi di comando a due mani Two-hand control devices

Pulsantiera a due mani inclinata in alluminio Sloped aluminium two-hand control panel



- RAL 7016
- RAL 2011

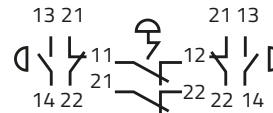

g

cod

1461
1461

060CL2MA
060CL2MAA

Accessori Accessories



Piastra accoppiamento pulsantiera inclinata
Coupling plate for sloped panel

g

cod

450

060PAP



Stativo componibile ortogonale
Orthogonal modular stand

7040

060SCO

Stativo componibile ortogonale con base di derivazione
Orthogonal modular stand with junction base

7500

060SCDO

Dispositivi di comando a due mani Two-hand control devices

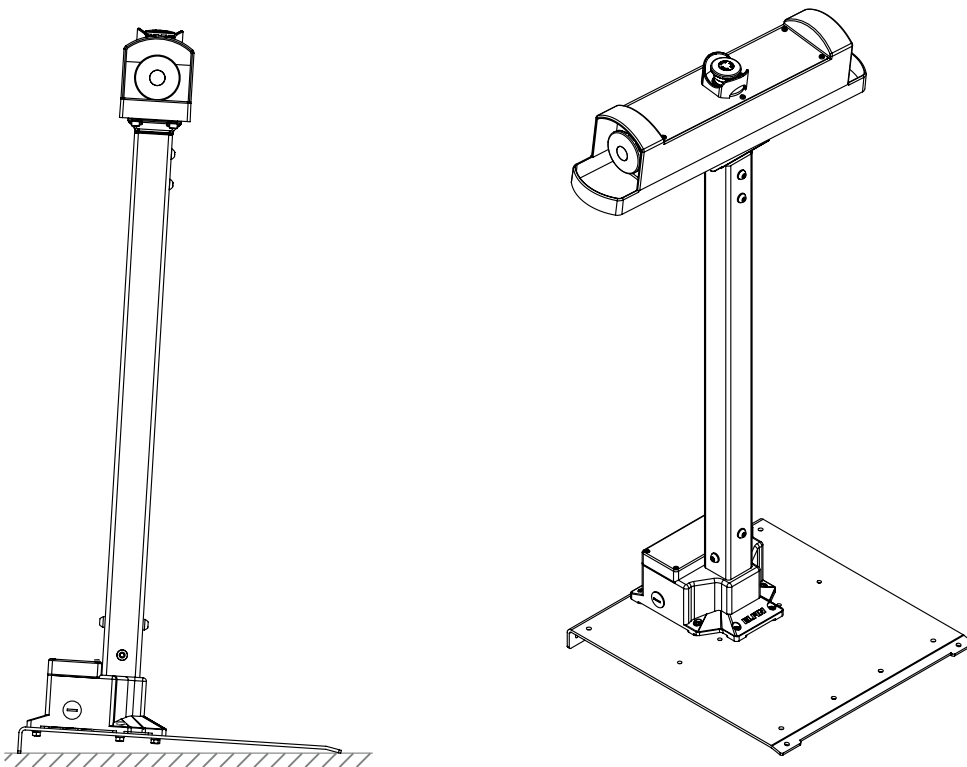
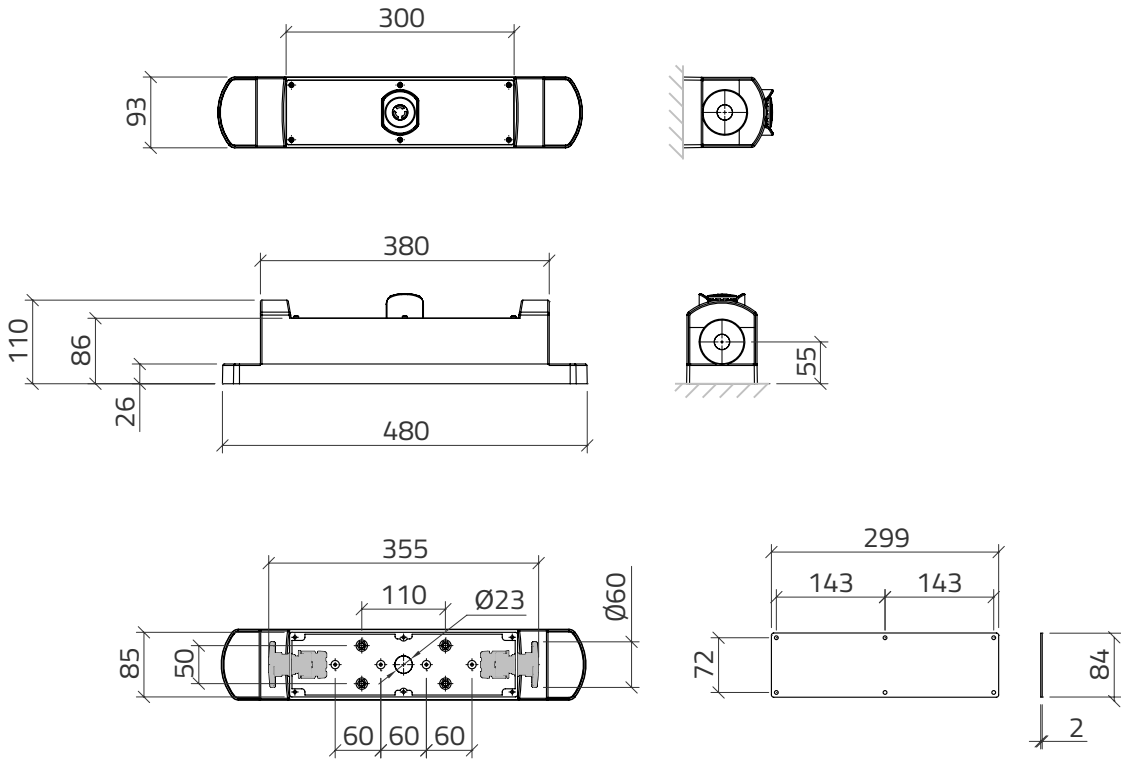

Dispositivi di comando a due mani Two-hand control devices

Pulsantiera a due mani console in alluminio Aluminium console two-hand control panel



- RAL 7016
- RAL 2011

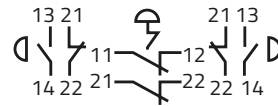

g	cod
2050	060C2MA
2050	060C2MAA

Pulsantiera a due mani console da completare Console two-hand control panel to be completed



Pulsantiera con pulsanti
Control panel with push-buttons

- RAL 7016
- RAL 2011



g	cod
1730	060C2MGRP
1730	060C2MAP

Accessori Accessories



Piastra di ricambio / Spare plate

g	cod
150	060PC



Stativo componibile ortogonale
Orthogonal modular stand

7040	060SCO
------	---------------

Stativo componibile ortogonale con base di derivazione
Orthogonal modular stand with junction base

7500	060SCDO
------	----------------

Dispositivi di comando a due mani Two-hand control devices

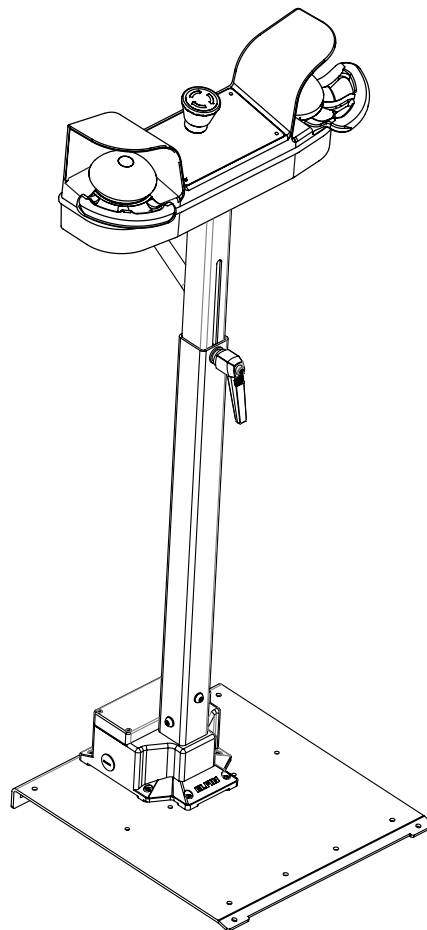
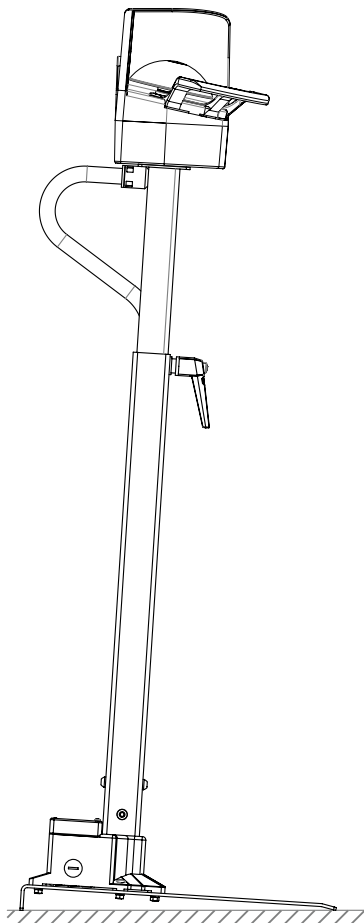
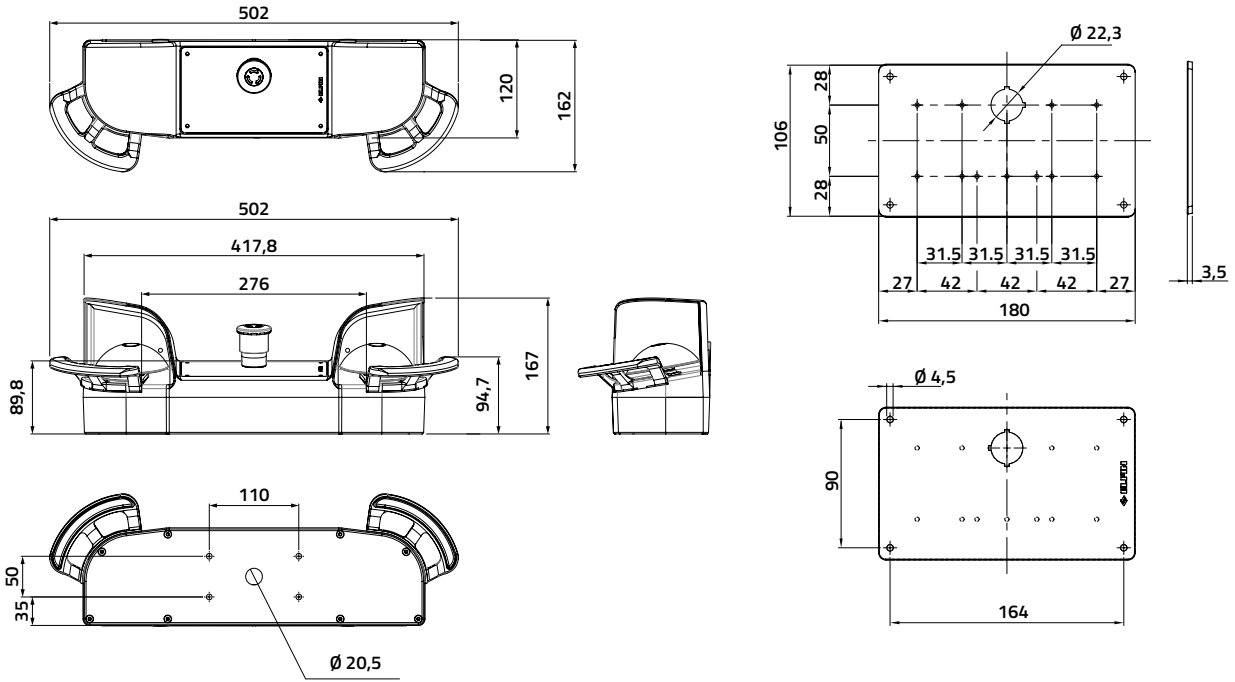

Dispositivi di comando a due mani Two-hand control devices

Pulsantiera a due mani protetta in alluminio Aluminium two-hand control panel protected



Per personalizzazioni con altri operatori ed elementi di contatto
vedi sezione "020 Comando e segnalazione SM2 Ø22"
For customization with other operators or contact blocks,
refer to section 020 "Command and signaling SM2 Ø22".

● RAL 7016

g

cod

2980

060P2MEAGR

● RAL 2011

2980

060P2MEAA

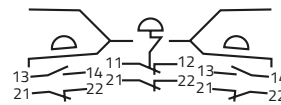

Accessori Accessories



Stativo telescopico
Telescopic Stand

● RAL 7016

g

cod

11040

060STP2M

● RAL 2011

11040

060STP2MA

Dispositivi di comando a due mani Two-hand control devices

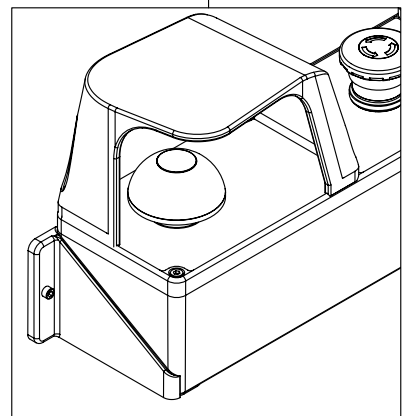
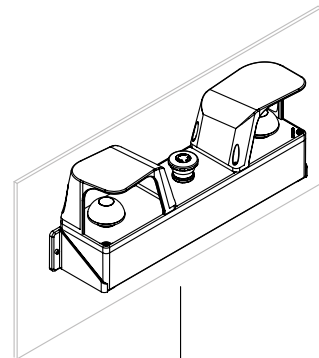
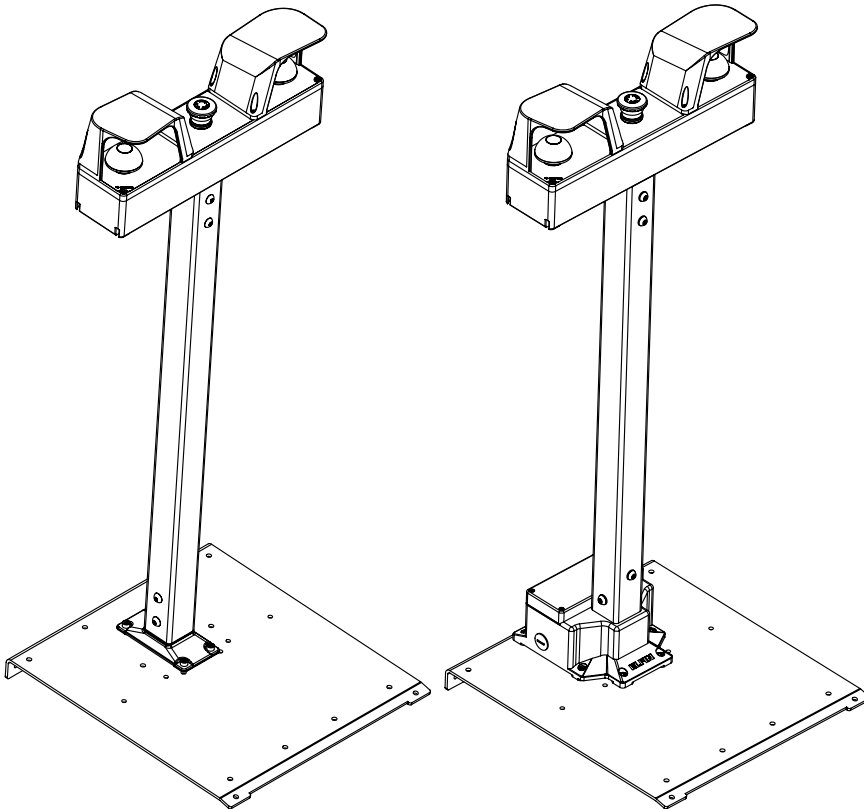
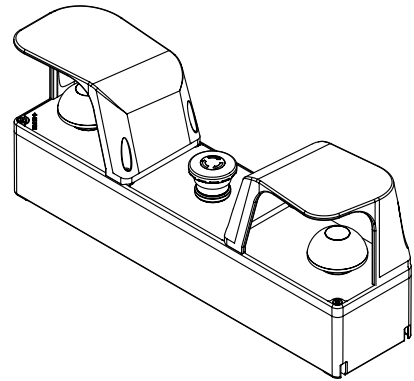
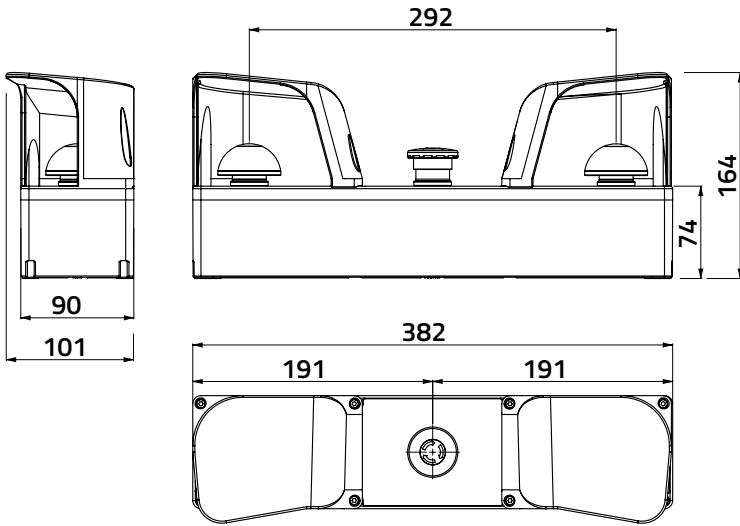



Dispositivi di comando a due mani

Two-hand control devices

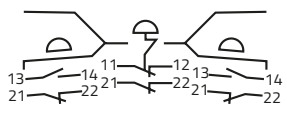

Pulsantiera a due mani protetta in Termoplastico

Thermoplastic two-hand control panel protected

	g	cod
 <p>Involucro linea Techno 90 Techno 90 line enclosure</p> <p>● RAL 7016</p>	1195	060PT2MAGR
 <p>● RAL 2011</p>	1195	060PT2MAA
		

Accessori

Accessories

	g	cod
 <p>Stativo componibile ortogonale Orthogonal modular stand</p>	7040	060SCO
<p>Stativo componibile ortogonale con base di derivazione Orthogonal modular stand with junction base</p>	7500	060SCDO
 <p>Sistema fissaggio inclinato a 90° Techno 90 mm Techno 90 mm 90° sloped mounting system</p> <p>Conforme UL / UL Compliant</p>		080TSF090 080TUSF090
		

Dispositivi di comando a due mani Two-hand control devices

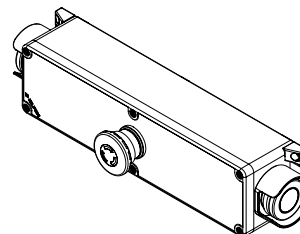
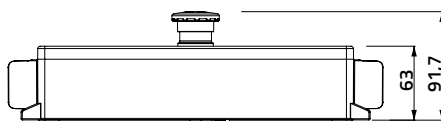
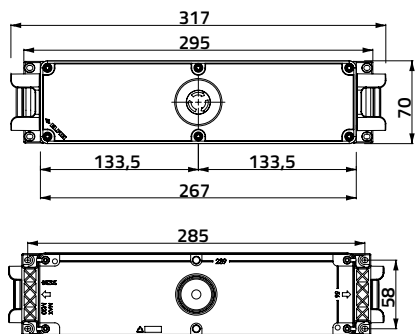

Dispositivi di comando a due mani Two-hand control devices

Pulsantiera a due mani in Termoplastico Thermoplastic two-hand control panel



Involucro linea Techno 70
Techno 70 line enclosure

● RAL 7016

g

cod

060CT2MAGR

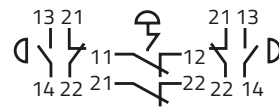

Dispositivi di comando a due mani Two-hand control devices

060MPP2GR

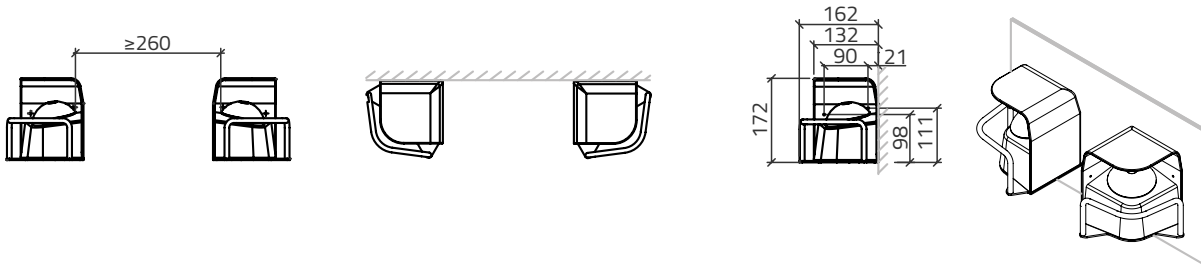

060MLP2GR

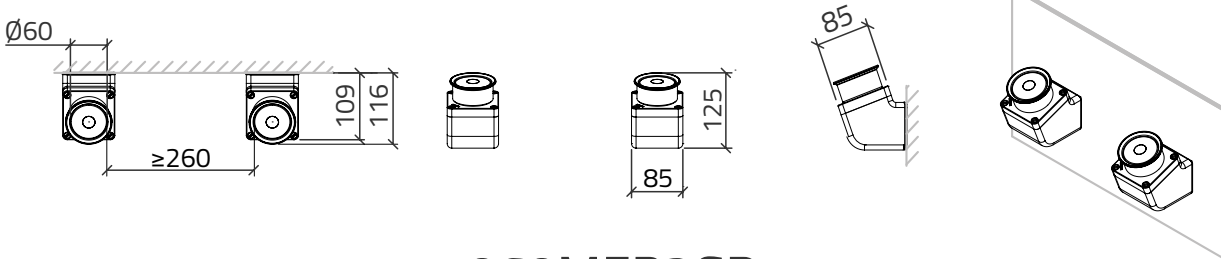

060MEP2GR

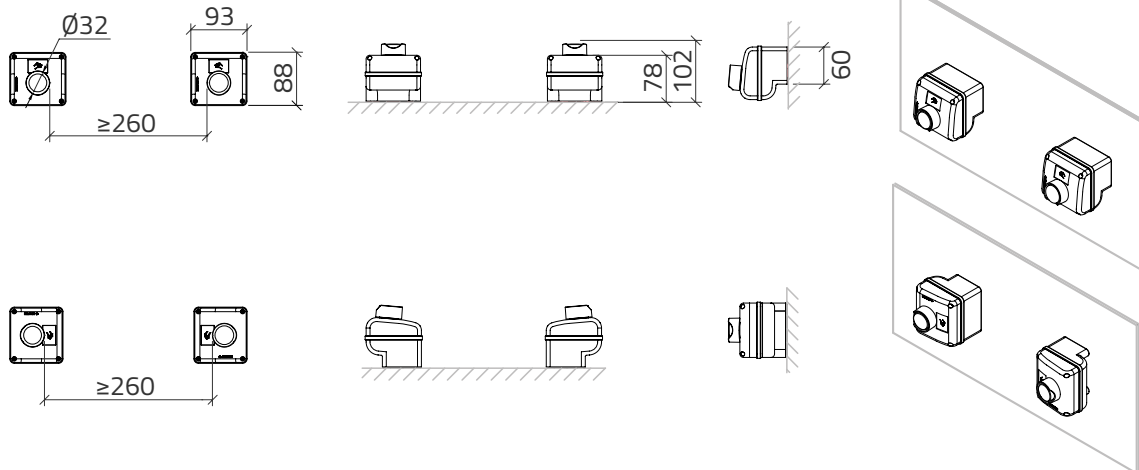

060MTP2GR



Dispositivi di comando a due mani Two-hand control devices

Moduli singoli in alluminio Single aluminium modules



Moduli singoli protetti per comando a due mani Protected single modules for two-hand control

● Grigio / Gray

g

cod

3200

060MPP2GR

Unità 1/ Unit 1

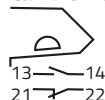

Unità 2/ Unit 2

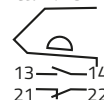

Moduli singoli inclinati per comando a due mani Sloped single modules for two-hand control

Involucro inclinato in alluminio - 2 unità
Sloped aluminium enclosures - 2 units

● Grigio / Gray

g

cod

1300

060MLP2GR

Unità 1/ Unit 1

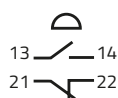

Unità 2/ Unit 2

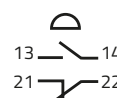

Moduli singoli in termoplastico Single thermoplastic modules



Moduli singoli per comando a due mani Single modules for two-hand control

Involucro ergonomico in termoplastico - 2 unità
Ergonomic thermoplastic enclosures - 2 units

● Grigio / Gray

g

cod

400

060MEP2GR

Unità 1/ Unit 1

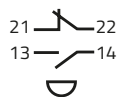

Unità 2/ Unit 2

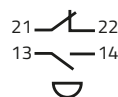

Moduli singoli per comando a due mani Single modules for two-hand control

Involucro linea Techno 70 - 2 unità
Techno 70 line enclosures - 2 units

● Grigio / Gray

g

cod

060MTP2GR

Dispositivi di comando a due mani Two-hand control devices

Stativi componibili per comando bimanuale Modular stands for two-hand control panel

g

cod

Per articoli 060CL2M_, 060C2M_
For item code 060CL2M_, 060C2M_



Stativo componibile ortogonale
Orthogonal modular stand

7039

060SCO

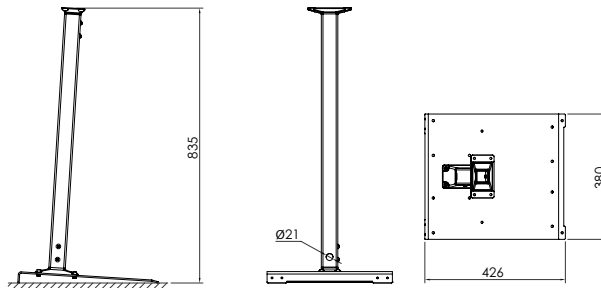

Stativo componibile inclinato
Sloped modular stand

7110

060SCI

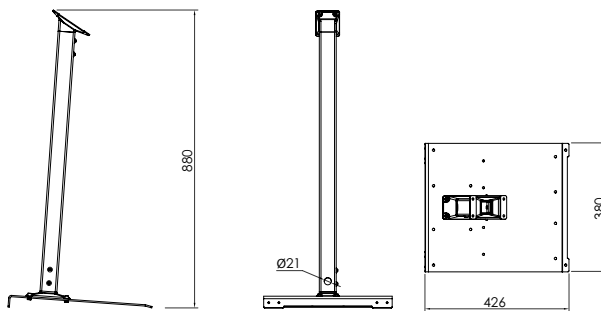

Stativo componibile ortogonale con base di derivazione
Orthogonal modular stand with junction base

7500

060SCDO

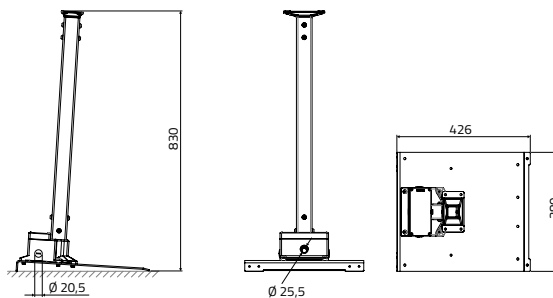

Stativo componibile inclinato con base di derivazione
Sloped modular stand with junction base

7500

060SCDI

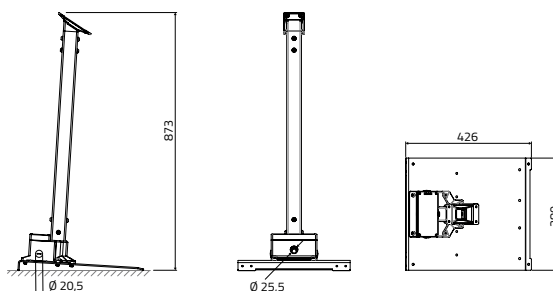

Dispositivi di comando a due mani Two-hand control devices

Stativi telescopici per comando bimanuale Telescopic stands for two-hand control panel



Per articoli 060P2M_
For item code 060P2M_

- RAL 7016
- RAL 2011

g **cod**

11040 **060STP2M**
11040 **060STP2MA**

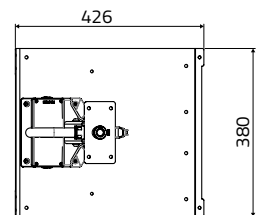
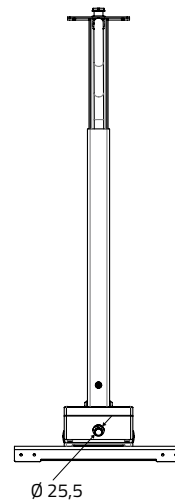
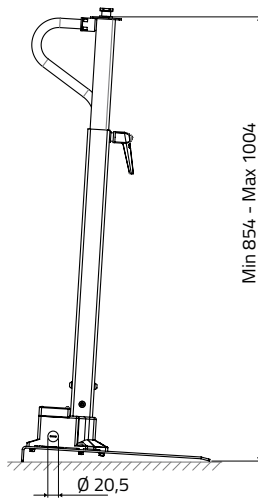

Ruote Wheels



Kit di ruote per piastra base colonna
Castor kit for column base plate

g **cod**

200 **060KR**

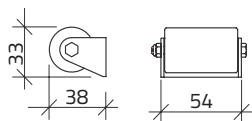

Dispositivi di comando a due mani Two-hand control devices

Piastre Plates



Piastra base stativo / Column base plate

g

5650

cod

060BS

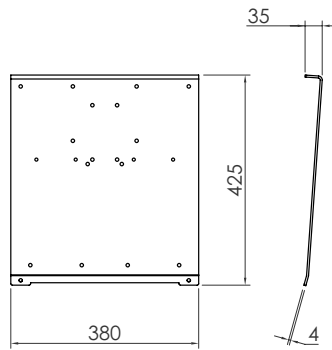

Giunti Joints



Ortagonale / Orthogonal
Inclinato / Oblique

g

327

410

cod

060GCO

060GCI

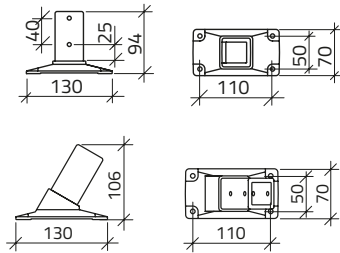

Colonne Columns



Lunghezza / Length mm 770

g

1185

cod

060CB

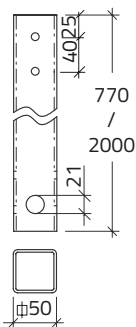

Dispositivi di comando a due mani Two-hand control devices

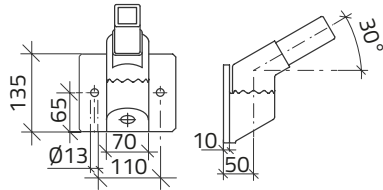

Supporto per braccio / Arm support

g

1800

cod

060SB

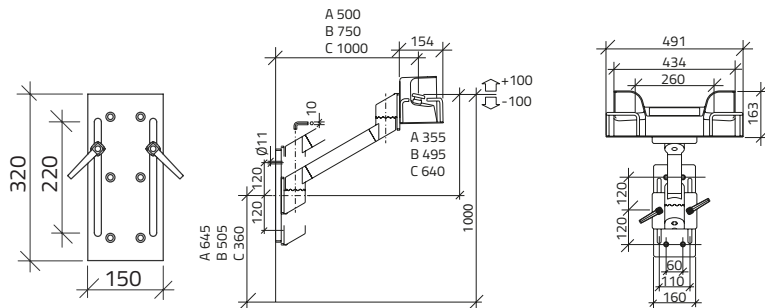

Piastra di regolazione/ Adjustment plate

g

2420

cod

060PRBO

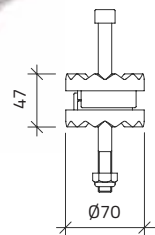
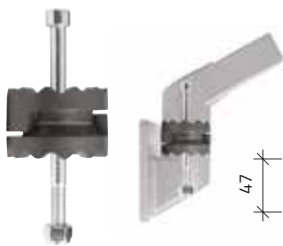

**Snodo per braccio
Articulated joint for arm**

g

530

cod

060SRBO

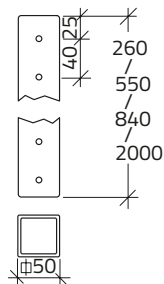

Bracci / Arms

Lunghezza / Length mm 260	360	060B2
Lunghezza / Length mm 550	780	060B5
Lunghezza / Length mm 840	1160	060B8
Lunghezza / Length mm 2000		
senza fori / undrilled	2790	060C2000

g

cod

Modulo di contemporaneità

Simultaneous action controller

CARATTERISTICHE PRINCIPALI

- **Controllo a due mani:** 060MCP2M monitora il funzionamento sicuro delle console di controllo a due mani di tipo IIIC.
- **Conformità alla Direttiva Macchine:** Categoria 4, PL e secondo EN ISO 13849-1
- **Uscite di sicurezza:** Relè di sicurezza a guida forzata elettromeccanici con uscite ausiliarie 2NO + 1NC
- **Cablaggio flessibile:** Il modulo è dotato di morsetti a vite rimovibili per un facile cablaggio e manutenzione del prodotto; le morsettiere sono codificate in modo da evitare errori di collegamento
- **Diagnostica:** Indicazioni a LED per alimentazione, stato degli ingressi di sicurezza e stato delle uscite di sicurezza
- **Compatto:** 1 modulo DIN, L x A x P: 17,5 x 110,8 x 121,1mm
- **Approvazioni:** TÜV. CE, cULus

FUNZIONI PRINCIPALI

- Monitoraggio del funzionamento sicuro delle console di comando a due mani (Tipo IIIC secondo EN ISO 13851), utilizzato in applicazioni che richiedono all'operatore di supervisionare in sicurezza il funzionamento della macchina
- Funzionamento a doppio canale di sicurezza delle console di comando a due mani
- Controllo di 2 uscite di sicurezza NA con relè di sicurezza elettromeccanici
- Diagnostica del circuito di sicurezza tramite indicazioni a LED per alimentazione, stato degli ingressi di sicurezza e stato delle uscite di sicurezza
- 1 uscita ausiliaria NC utilizzabile per l'indicazione remota di stato

COMPATIBILITÀ E CONFORMITÀ

- **Direttiva bassa tensione 2014/35/UE EN 60947-5-1.** Apparecchiature e quadri di comando in bassa tensione - Dispositivi ed elementi di commutazione circuito di controllo
- **Direttiva EMC 2014/30/UE EN 60947-5-1.** Apparecchiature e quadri di comando in bassa tensione - Dispositivi ed elementi di commutazione circuito di controllo
- **Direttiva macchine 2006/42/CE. Esame di tipo CE certificato TÜV Cert. no. 44 205 15058307 EN ISO 13849-1** Sicurezza delle macchine - parti dei sistemi di controllo legate alla sicurezza- Principi generali di progettazione. **EN 60204-1** Sicurezza delle macchine - Equipaggiamento elettrico delle macchine - Requisiti generali Comando a due mani di tipo III **EN ISO 13851.** Sicurezza delle macchine - Dispositivi di comando a due mani Principi per la progettazione e la selezione. **EN 61326-3-1.** Apparecchiature elettriche per misurazione, controllo e uso in laboratorio. Requisiti EMC. Requisiti di immunità per i sistemi di sicurezza e per le apparecchiature destinate a svolgere funzioni di sicurezza (sicurezza funzionale)

MAIN FEATURES

- **Two-hand control:** 060MCP2M monitors the safe operation of Type IIIC two-hand control consoles
- **Machinery Directive compliance:** Cat. 4, PL e in accordance with EN ISO 13849-1
- **Safety outputs:** Electromechanical forcibly guided safety relays with 2NO+1NC aux outputs
- **Flexible wiring:** The module is equipped with detachable screw terminals for easy wiring and product maintenance; the terminal blocks are coded so to avoid wiring mistakes
- **Diagnostic:** LED indications for power supply, state of the safety inputs and state of the safety outputs
- **Compact:** 1-DIN, W x H x D: 17,5 x 110,8 x 121,1mm
- **Approval:** by TÜV. CE, cULus

MAIN FUNCTIONS

- Monitoring of the safe operation of two-hand control consoles (Type IIIC as per EN ISO 13851), used in applications requiring the operator to supervise safely the operation of the machinery
- Double safety channels operation of two-hand control consoles
- Control of 2 NO safety outputs with electromechanical safety relays
- Diagnostic of the safety circuit through on-board LED indications for power supply, status of safety channels and status of safety outputs
- 1 NC auxiliary output that can be used for external status indication

COMPATIBILITY AND CONFORMITY

- **Low Voltage Directive 2014/35/UE EN 60947-5-1.** Low-voltage switchgear and controlgear - Control circuit devices and switching elements.
- **EMC Directive 2014/30/UE EN 60947-5-1.** Low-voltage switchgear and controlgear - Control circuit devices and switching elements.
- **Machinery Directive 2006/42/EC EC type examined by TÜV Cert. no. 44 205 15058307 EN ISO 13849-1** Safety of machinery - safety related parts of control systems General principles for design **EN 60204-1** Safety of machinery - Electrical equipment of machines - General requirements. Two-hand control type III **EN ISO 13851** Safety of machinery - Two-hand control devices - Principles for design and selection **EN 61326-3-1** Electrical equipment for measurement, control and laboratory use. EMC requirements. Immunity requirements for safety-related systems and for equipment intended to perform safety-related functions (functional safety)

Modulo di contemporaneità Simultaneous action controller

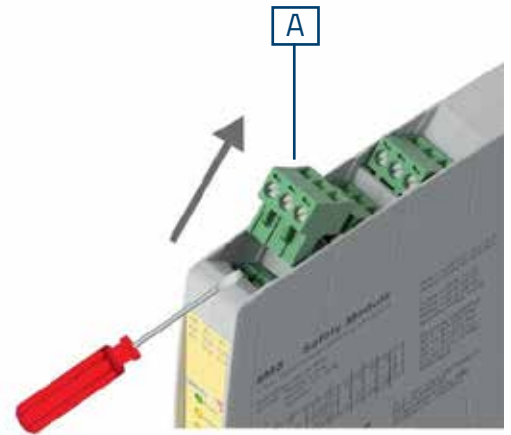
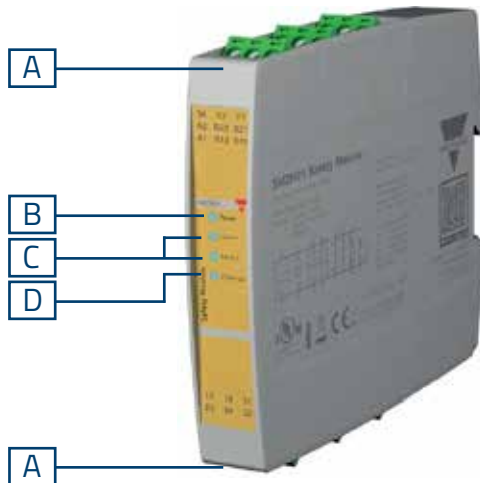

Elemento	Componente	Funzione
A	Morsettiere rimovibili	Alimentazione, segnale di feedback, ingressi e uscite di sicurezza
B	LED	Stato dell'alimentazione
C	LED	Stato degli ingressi di sicurezza
D	LED	Stato delle uscite di sicurezza

Element	Component	Function
A	Pluggable terminal blocks	Power supply, feedback signal safety inputs and outputs
B	LED	Power supply status
C	LED	Safety inputs status
D	LED	Safety outputs status

Schema di collegamento

Terminale	Funzione
A1	alimentazione 24 Vdc (+)/Vac(-)
A2	alimentazione 24 Vdc (-)/Vac(-)
S11-S12	ingresso canale 1 NA
S21-S22	ingresso canale 2 NA input
Y1-Y2	ingresso di feedback NC
10-14	uscita sicura NA
23-24	uscita sicura NA
31-32	uscita ausiliaria NC
34	uscita ausiliaria PNP

Connection diagram

Terminal	Function
A1	power supply 24 Vdc (+)/Vac(-)
A2	power supply 24 Vdc (-)/Vac(-)
S11-S12	channel 1 NO input
S21-S22	channel 2 NO input
Y1-Y2	NC feedback input
10-14	NO safety output
23-24	NO safety output
31-32	NC auxiliary output
34	PNP auxiliary output

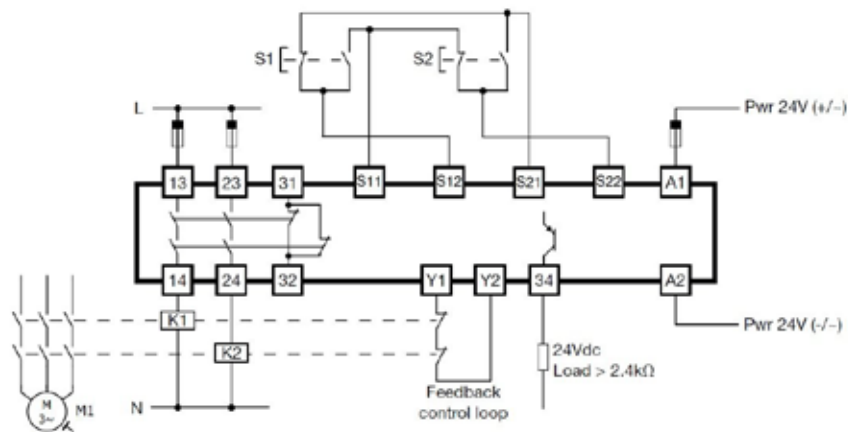

Modulo di contemporaneità Simultaneous action controller

g

cod

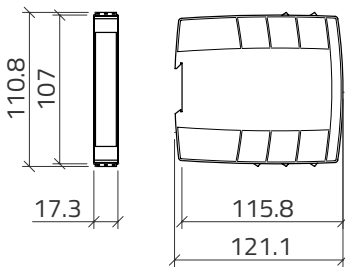

Modulo di contemporaneità / Simultaneous action controller

Modulo / Controller

239

060MCP2M

Il modulo di sicurezza 060MCP2M è progettato per applicazioni fino alla Categoria 4, Livello di prestazione PLe in conformità con la Direttiva macchine EN ISO 13849-1 per monitorare e controllare in sicurezza il funzionamento delle console di controllo a due mani (Tipo III C secondo UNI EN ISO 13851). Il dispositivo abilita le uscite di controllo di sicurezza solo se i due pulsanti della console sono attivati dall'operatore contemporaneamente o con un intervallo massimo di 500 ms l'uno dall'altro.

The 060MCP2M safety module is designed in Category 4, Performance Level e in accordance with the Machine Directive EN ISO 13849-1 to monitor and control safely the operation of two-hand control consoles (Type III C according to UNI EN ISO 13851). The device enables the safety control outputs only if the two buttons of the console are activated by the operator simultaneously or with a max interval of 500 ms from each other.

Caratteristiche tecniche

Materiale	PA-GF, autoestinguente: UL 94 V-0
Montaggio	Montaggio su guida DIN (secondo EN 50022)
Alimentazione	24VCC ± 10%; 24VCA -15%/+10%, 50-60 Hz, Classe 2 Categoria di sovratensione III Protezione da corto circuito a mezzo PTC Tensione nominale di isolamento 4 kV
Numero di canali di ingresso	2
Ingressi	S11-S12 e S21-S22
Resistenza linea circuito ingressi	Max. 30 kΩ (eq. 2500m 1,5mm2 Cu)
Corrente di ingresso	Tipica 30 mA
Numero di uscite sicure NA	2
Numero di uscite ausiliarie NC	1
Numero di uscite ausiliarie	PNP 1; PNP, 24 VCC, carico resistivo esterno min 2.4 kΩ
Tipo di uscita	NA e NC Contatti liberi da tensione, relè con contatti a guida forzata
Corrente Max	Per ciascuna uscita @ 60°C (140°F) temperatura di funzionamento: CA 1: 250V / 6A / 2000 VA - CA 15: 230V / 3A CC 1: 24V / 6A - CC 13: 24V / 2.5A / 0.1 Hz UL508, pilot duty: B300 / R300
Corrente Max quadratica	Spazio tra i moduli ≥ 100mm: 72A2 @40°C (104°F) temperatura ambiente Moduli montati affiancati: 26A2 @25°C (77°F) temperatura ambiente Fare riferimento alle curve di declassamento nel manuale di istruzioni
Durata meccanica	> 107 operazioni
Durata elettrica	AC1 (360 commutazioni/h) - 105 operazioni
ISO 13849-1 Categoria di sicurezza	Cat. 4
ISO 13849-1	Livello di prestazione PL e
MTTFD [a]	422,1
PFHD [1/h]	1,35 E-10
DCavg	99%
β	5,00 E-02
βD	2,00 E-02
Grado di protezione	IP40 sul frontale della custodia, IP20 sui terminali. Il dispositivo deve essere installato in un quadro elettrico con almeno un grado di protezione pari a IP54
Grado di inquinamento	2
Temperatura di funzionamento	-25 + +60°C (-13 + 140°F), UL: +40°C (104°F)
Temperatura di immagazzinamento	-30 + +70°C (-22 + 158°F)
Umidità ambiente	R.H. ≤95% in assenza di condensa

Technical data

Material	PA-GF, self-extinguishing: UL 94 V-0
Assembly	DIN rail mounting (according to EN 50022)
Power supply	24Vdc ± 10%; 24Vac -15%/+10%, 50-60 Hz, Class 2 Overvoltage category III Short circuit protection internal PTC Rated insulation voltage 4 kV
Number of safety channels	2
Safety inputs	S11-S12 e S21-S22
Loop resistance	Max. 30 kΩ (eq. 2500m 1,5mm2 Cu)
Input current	Tipica 30 mA
NO safety outputs	2
NC auxiliary output	1
PNP auxiliary output	1; PNP collector, 24 Vdc, min external resistive load 2.4 kΩ
NO and NC outputs type	Voltage free contact output, relays with forcibly guided contacts
Max current rating	single output @ 60°C (140°F) operating temperature: AC 1: 250V / 6A / 2000 VA - AC 15: 230V / 3A DC 1: 24V / 6A - DC 13: 24V / 2.5A / 0.1 Hz UL508, pilot duty: B300 / R300
Max quadratic current	Spacing between modules ≥ 100mm: 72A2 @40°C (104°F) ambient temperature Modules mounted stacked: 26A2 @25°C (77°F) ambient temperature Please refer to the derating curves in installation manual
Mechanical life	> 107 operations
Electrical life	AC1 (360 s/h) - 105 operations
ISO 13849-1 Safety Category	Cat. 4
ISO 13849-1	Livello di prestazione PL e
MTTFD [a]	422,1
PFHD [1/h]	1,35 E-10
DCavg	99%
β	5,00 E-02
βD	2,00 E-02
Protection grade	IP40 on frontal part of the housing, IP20 on the terminals. The device has to be installed in a cabinet with protection degree of IP54.
Pollution degree	2
Operating temperature	-25 + +60°C (-13 + 140°F), UL: +40°C (104°F)
Storage temperature	-30 + +70°C (-22 + 158°F)
Ambient humidity range	R.H. ≤95% non condensing





Pulpito di emergenza Emergency stand

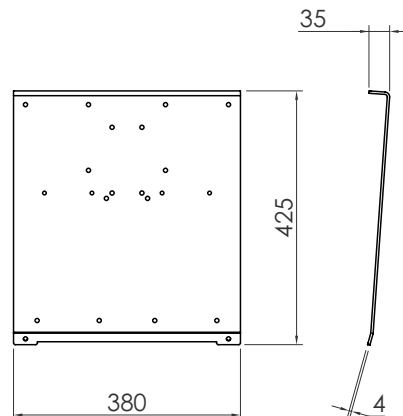
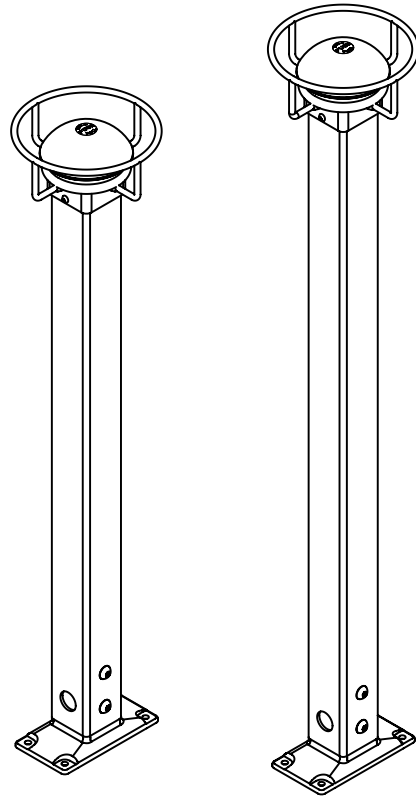
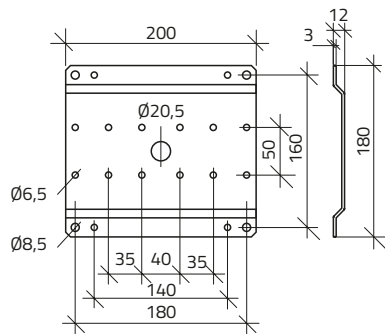
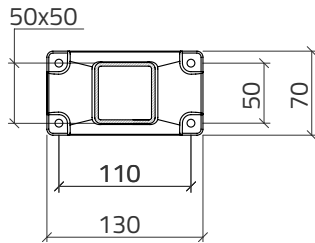
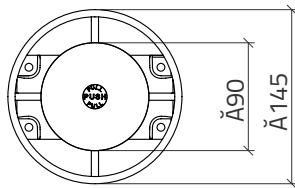
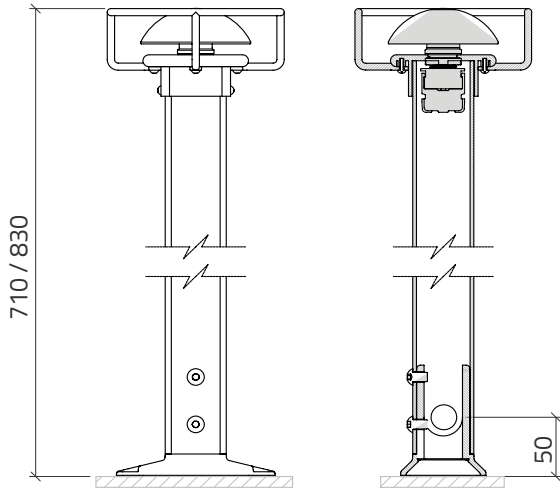

Pulpito di emergenza Emergency stand



Pulpito pulsante di emergenza Emergency push-button stand

Lunghezza / Length mm 710
Lunghezza / Length mm 830

1535
1815

060PES7
060PES8

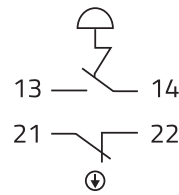

g

cod

g

cod

Piastra / Plate

Piastra base colonna / Column base plate

836

060PAC



g

cod

Piastre / Plates

Piastra base colonna / Column base plate

5650

060BS

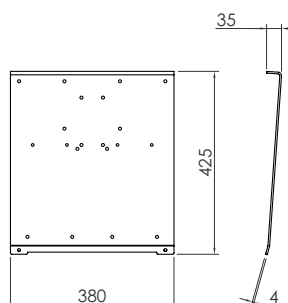

Interruttori a pedale Foot switches

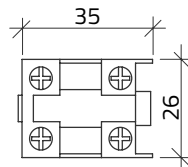
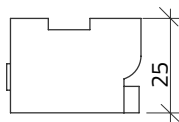
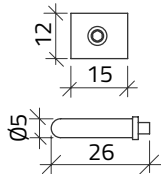
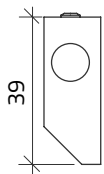
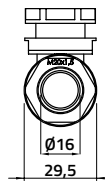
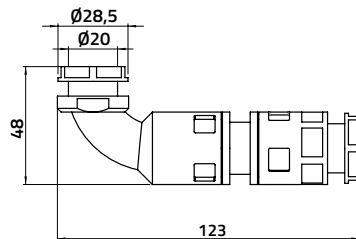
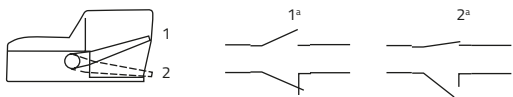
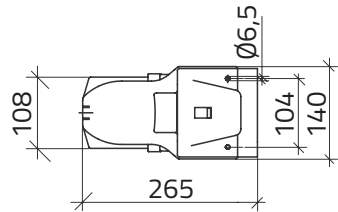
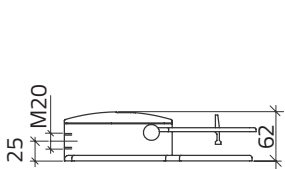
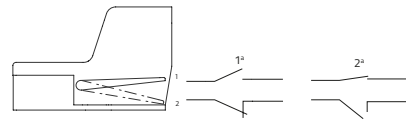
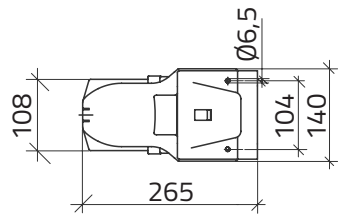
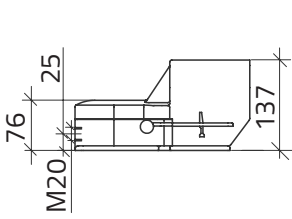
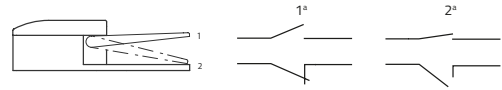
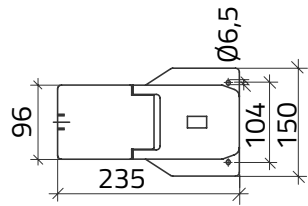
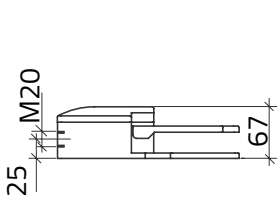
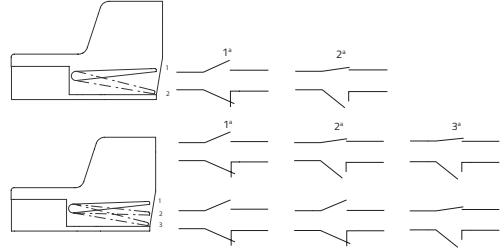
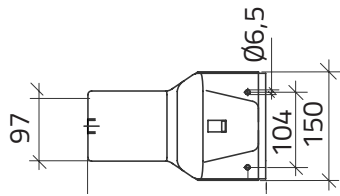
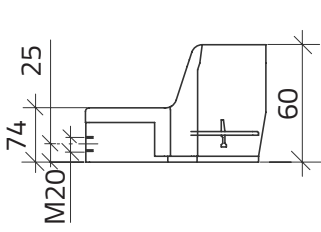

Interruttori a pedale

Foot switches

Interruttori a pedale in termoplastico

Thermoplastic foot switches



2 posizioni (1 microinterruttore) con leva di sicurezza
2 positions (1 microswitch) with safety lever

● Grigio / Grey

g

cod

900

060PPLT11

3 posizioni (2 micro interruttori)
3 positions (2 microswitches)

1000

060PP3PT22



Senza coperchio / Without cover

2 posizioni (1 microinterruttore)
2 positions (1 microswitch)

● Rosso/ Red

632

060PT11



Interruttori a pedale in alluminio

Aluminium foot switches

2 posizioni (1 microinterruttore) con leva di sicurezza
2 positions (1 microswitch) with safety lever

g

cod

1700

060PPLA11



Senza coperchio / Without cover

2 posizioni (1 microinterruttore) con leva di sicurezza
2 positions (1 microswitch) with safety lever

1232

060PA11



Kit di connessione interruttori a pedale

Foot switch connection kit

g

cod

50

060KCP



Accessori per comando a pedale

Foot switch accessories

Kit 2° micro / Kit for 2nd microswitch

74

060KM11

Ricambio micro / Spare microswitch

22

060M11

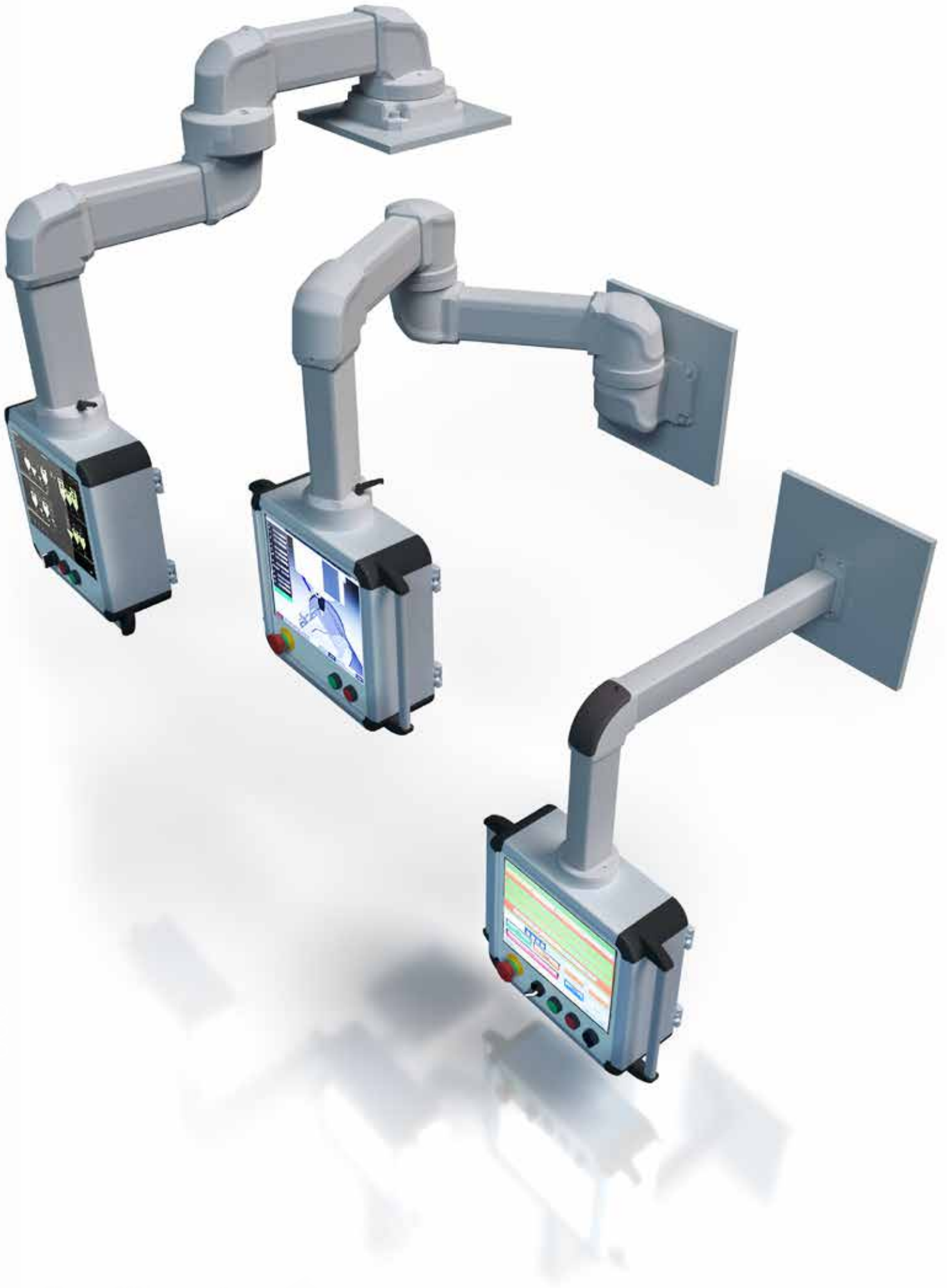

Sistemi di sospensione modulare Modular suspension system

Sistemi di sospensione modulare

La gamma offre molteplici sistemi di sospensione e proiezione delle periferiche di comando, garantendo il loro posizionamento in perfetta ergonomia e sicurezza, personalizzando ogni configurazione sulla base delle proprie esigenze.

Le diverse linee a disposizione, che permettono applicazioni a diversi carichi statici, sono pensate per rispondere ad ogni possibile richiesta.

Modular suspension arm systems

The range offers multiple suspension and support systems for control units, ensuring perfectly ergonomic and safe positioning while allowing full customization of each configuration according to specific requirements.

The different product lines, designed for applications with various static loads, are developed to meet every possible need.

Diagrammi di carico

Linea 50
Line 50

Load-bearing diagrams

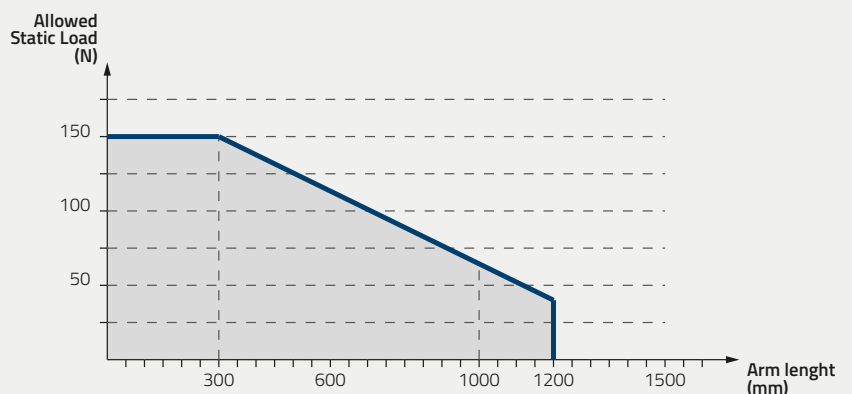

Sistemi di sospensione modulare Modular suspension system

Diagrammi di carico

Load-bearing diagrams

Linea 70
Line 70

1 Partenza verticale
Vertical outlet

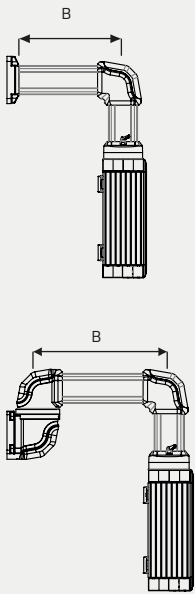

B max: 2000 mm

2 Partenza orizzontale
Horizontal outlet

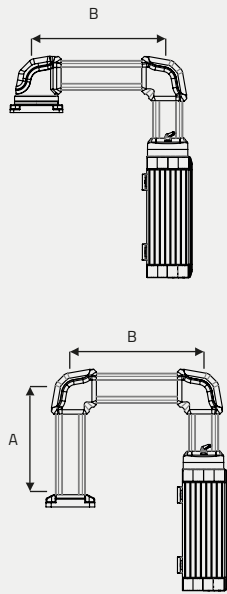

A max: 500 mm
B max: 1500 mm

3 Con utilizzo del giunto a snodo
Using the swivel joint

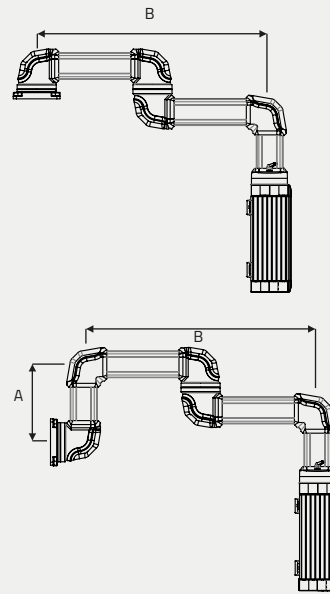

A max: 500 mm
B max: 1500 mm

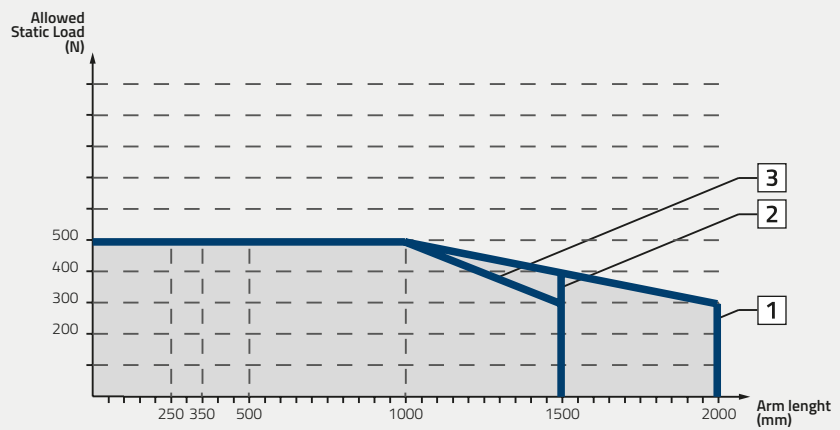

Sistemi di sospensione modulare Modular suspension system

■ Diagrammi di carico

■ Load-bearing diagrams

1 Partenza verticale
Vertical outlet

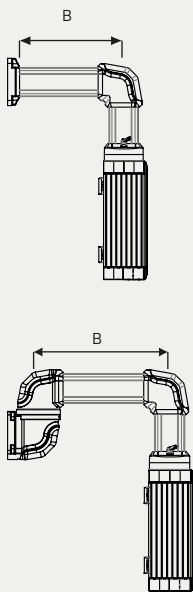

B max: 2500 mm

2 Partenza orizzontale
Horizontal outlet

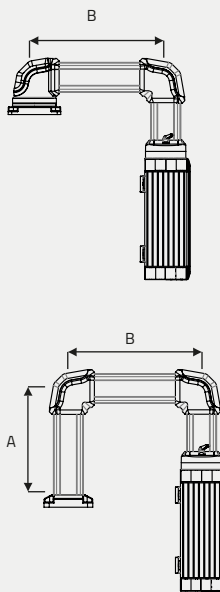

A max: 500 mm
B max: 2000 mm

3 Con utilizzo del giunto a snodo
Using the swivel joint

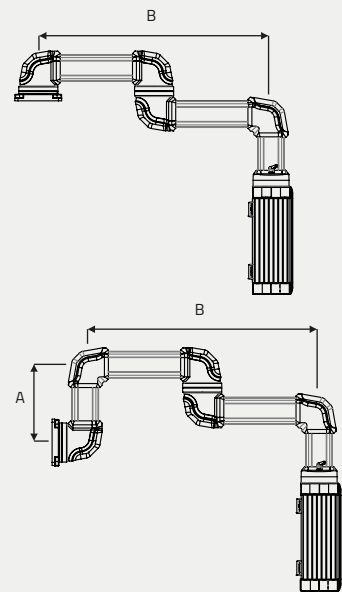

A max: 500 mm
B max: 2000 mm

Linea 85 Line 85

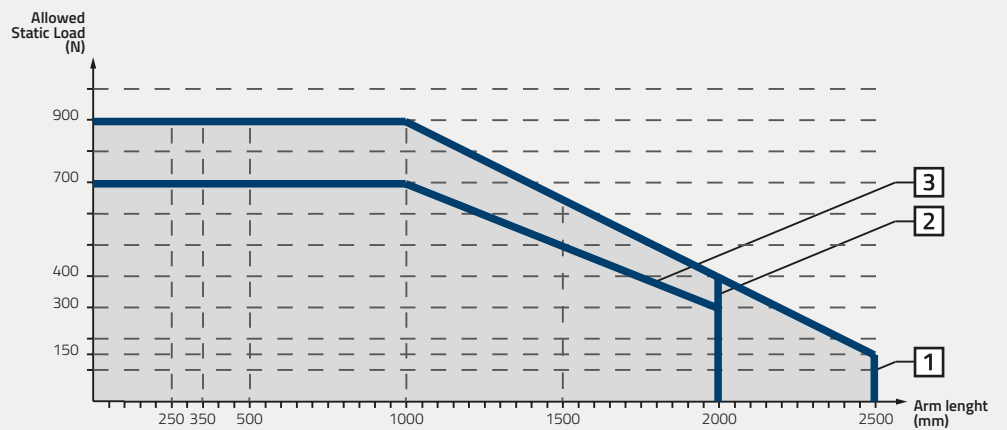

Linea 100 Line 100

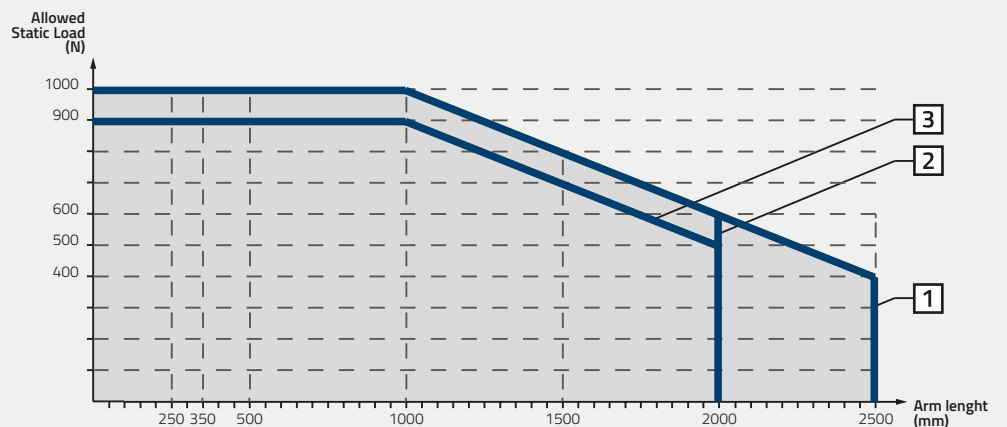

Sistemi di sospensione modulare

Modular suspension system

■ Quadri di comando in alluminio - Linea SC

I quadri di comando in alluminio sono proposti in 3 profondità e molteplici dimensioni.

Il pannello posteriore, incernierato, facilita le operazioni di installazione/cablaggio e successive ispezioni.

Su ordinazione sono disponibili modelli con profondità maggiori, ottenute mediante l'aggiunta di un profilo di estensione al corpo principale, o con pannello posteriore fisso.

Il pannello frontale è completamente personalizzabile. Realizzabile in materiale composito o alluminio, può essere lavorato per realizzazione forature, asolature, finestre per pc ad incasso, stampe digitali che lo completano con descrizione funzioni, simboli e loghi aziendali, e operatori industriali.

■ Aluminum control cabinets - Line SC

The aluminum control cabinets are available in three depths and multiple sizes.

The hinged rear panel simplifies installation, wiring, and subsequent inspection operations.

Models with greater depths, achieved by adding an extension profile to the main body, or with a fixed rear panel, can be supplied on request.

The front panel is fully customizable. Made of composite material or aluminum, it can be machined to include holes, slots, and recessed PC windows, completed with digital prints featuring function descriptions, symbols, company logos, and industrial operators.



P= 100 mm

P= 130 mm

P= 160 mm



Pannello posteriore incernierato
Hinged rear panel



Pannello frontale personalizzabile
Customizable front panel

Sistemi di sospensione modulare - Linea 50 Modular suspension system - Line 50

Giunti / Joints

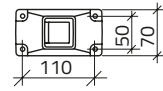
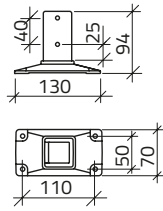

Ortagonale / Orthogonal

g

327

cod

060GCO

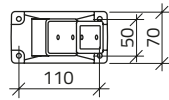
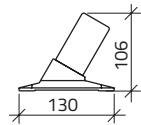

Inclinato / Oblique

410

060GCI

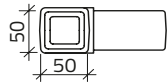
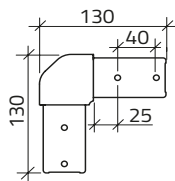

Angolare 90° / Angle 90°

651

060GCA

Sistemi di sospensione modulare - Linea 50 Modular suspension system - Line 50

Giunti / Joints

g

cod



Girevole assiale / Swivel, axial

324

060GRD

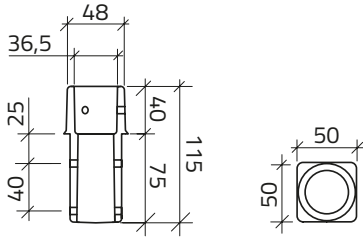

Girevole 90° / Swivel 90°

521

060GRA

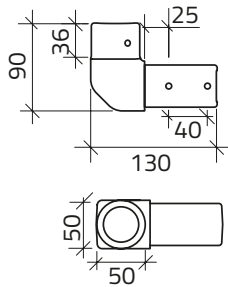

Girevole / Swivel

243

060GRO

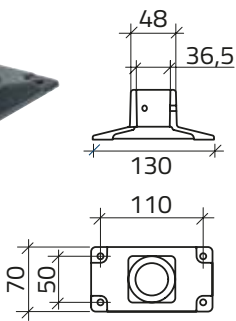

Bussola girevole interno foro \varnothing 23
Swivel bushing, bore \varnothing 23

310

060GSR

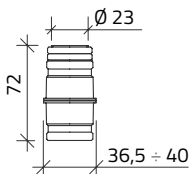

Sistemi di sospensione modulare - Linea 50 Modular suspension system - Line 50

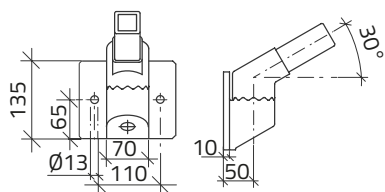

Supporto per braccio / Arm support

g 1800 **cod** 060SB

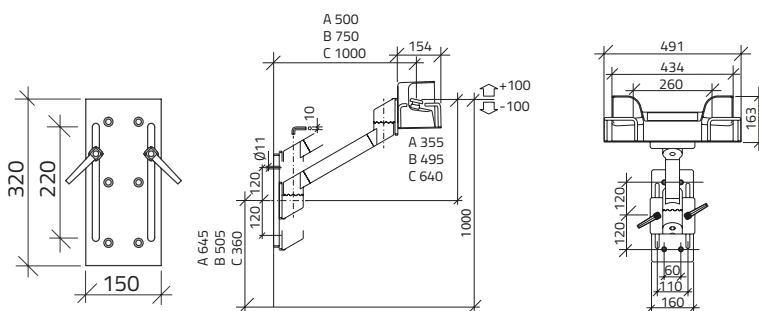

Piastra di regolazione/ Adjustment plate

g 2420 **cod** 060PRBO

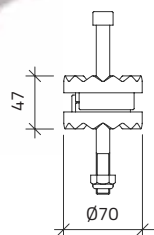
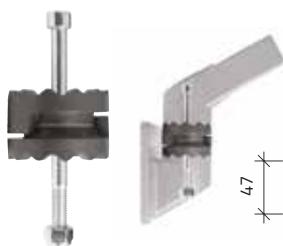

**Snodo per braccio
Articulated joint for arm**

g 530 **cod** 060SRBO

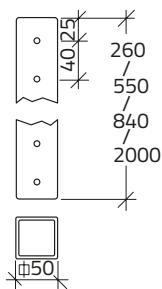

Bracci / Arms

Lunghezza / Length mm 260	360	060B2
Lunghezza / Length mm 550	780	060B5
Lunghezza / Length mm 840	1160	060B8
Lunghezza / Length mm 2000		
senza fori / undrilled	2790	060C2000

g **cod**

Sistemi di sospensione modulare - Linea 70

Modular suspension system - Line 70

Profilo di alluminio 50X70 / Aluminium profile 50x70



	mat	col	g	cod
Lunghezza / Length mm 250	Al	7035	600	060S070B0250
Lunghezza / Length mm 350	Al	7035	840	060S070B0350
Lunghezza / Length mm 500	Al	7035	1200	060S070B0500
Lunghezza / Length mm 750	Al	7035	1800	060S070B0750
Lunghezza / Length mm 1000	Al	7035	2400	060S070B1000
Lunghezza / Length mm 1500	Al	7035	3600	060S070B1500
Lunghezza / Length mm 2000	Al	7035	4800	060S070B2000

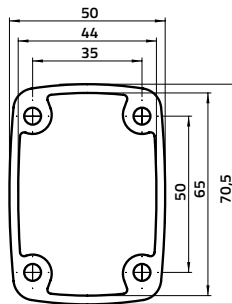

Flange / Flanges



Flangia girevole/
Swivel flange

mat	col	g	cod
Al	7035	600	060S070F320

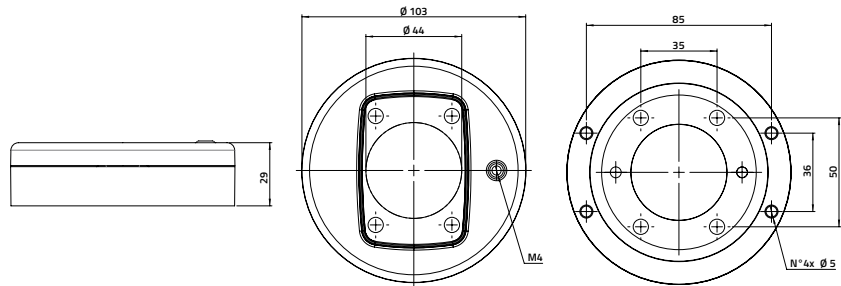

Flangia angolare 90° girevole/
Swivel 90° angular flange

mat	col	g	cod
Al	7035/16	1380	060S070F400

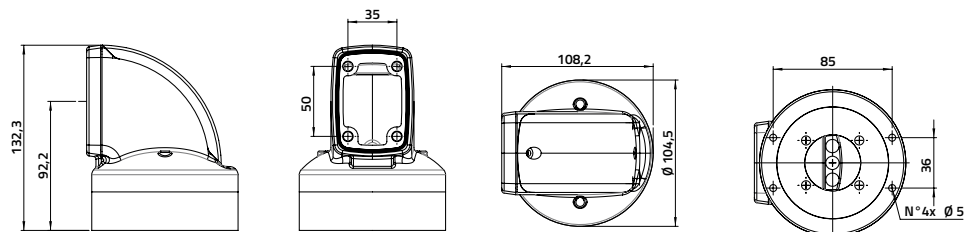

Sistemi di sospensione modulare - Linea 70

Modular suspension system - Line 70

Flange / Flanges



Flangia angolare 90° girevole base rettangolare /
Rectangular base swivel 90° angular flange

mat col g cod

Al 7035 2280 060S070SF410

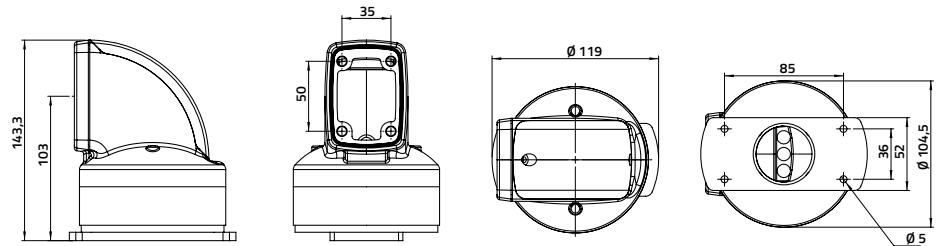

Flangia girevole a base rettangolare /
Rectangular base swivel flange

mat col g

Al 7035 750 060S070F830

cod

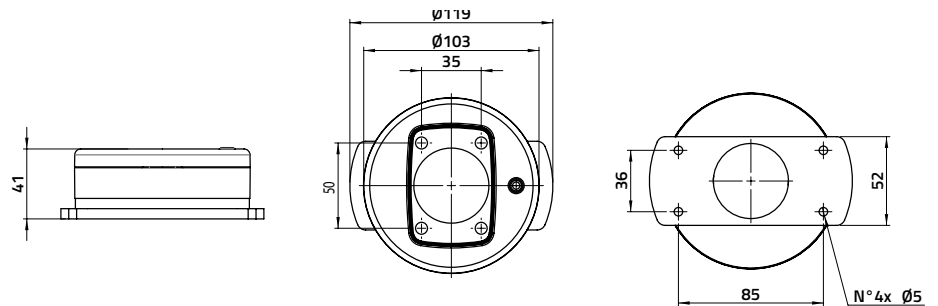

Adattatore per inclinazione regolabile /
Adapter for adjustable tilt

mat col g cod

Al 7035 900 060S070F835

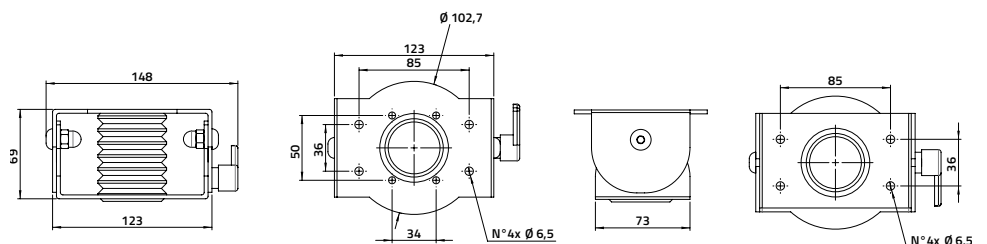

Sistemi di sospensione modulare - Linea 70

Modular suspension system - Line 70

Flange / Flanges



Adattatore inclinazione regolabile c/ vesa
Adapter for adjustable tilt w/ vesa

dim. 50 x 50

mat col g cod

Al 7035 1500 060S070F836

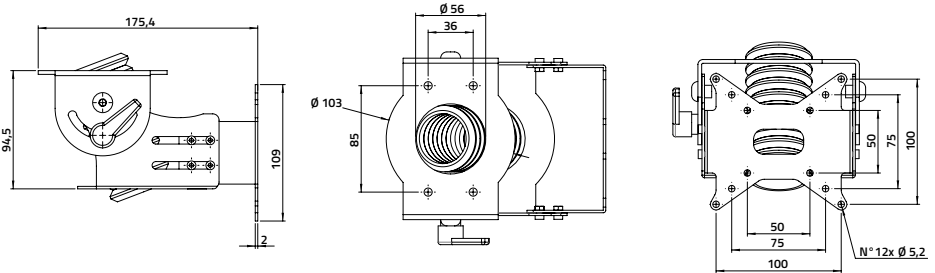

Giunti / Joints



Giunto angolare 90° /
90° angular joint

mat col g cod

Al 7035/7016 400 060S070G420

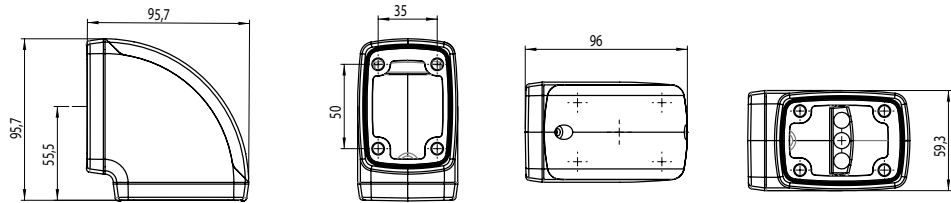

mat col g cod

Al 7035/7016 1650 060S070G500

Giunto a snodo girevole /
Swivel joint

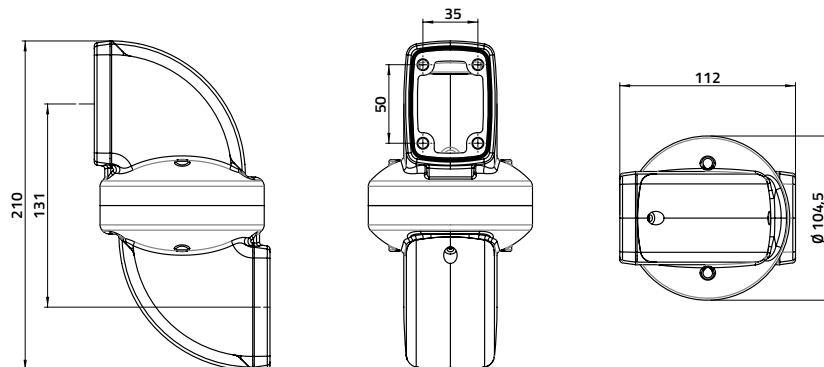

Sistemi di sospensione modulare - Linea 70 Modular suspension system - Line 70

Montanti / Bases



Montante angolare 90° girevole /
Swivel 90° angular base

mat col g cod

Al 7035/7016 1700 060S070M600

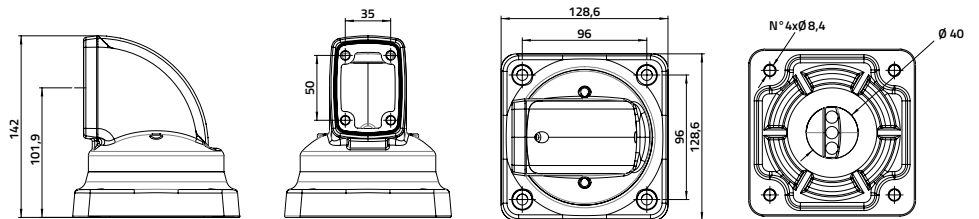

Montante girevole /
Swivel base

mat col g cod

Al 7035 1600 060S070M610

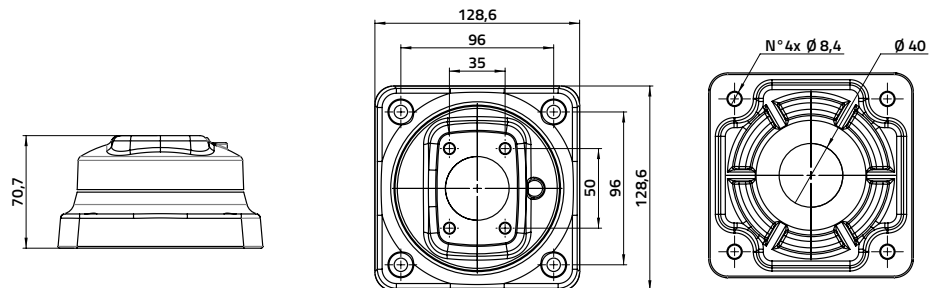

Montante a parete a snodo girevole /
Wall-mount swivel base

mat col g cod

Al 7035/7016 1850 060S070M700

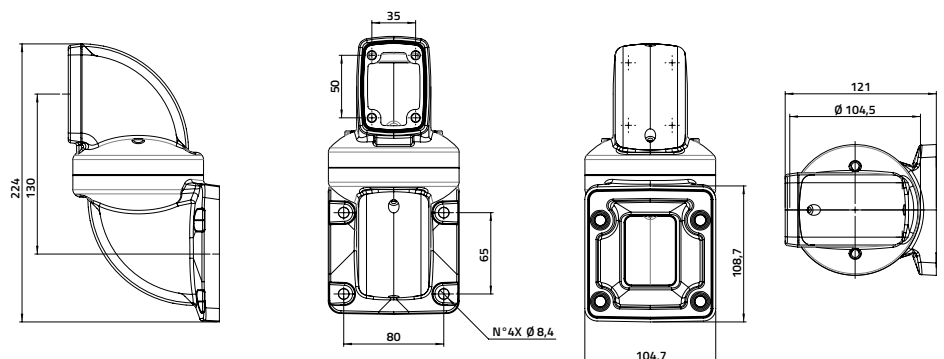

Sistemi di sospensione modulare - Linea 70

Modular suspension system - Line 70

Montanti / Bases

mat col g cod



Montante a parete angolare 90° girevole /
Wall-mount swivel 90° angular base

Al 7035/7016 1700 060S070M710

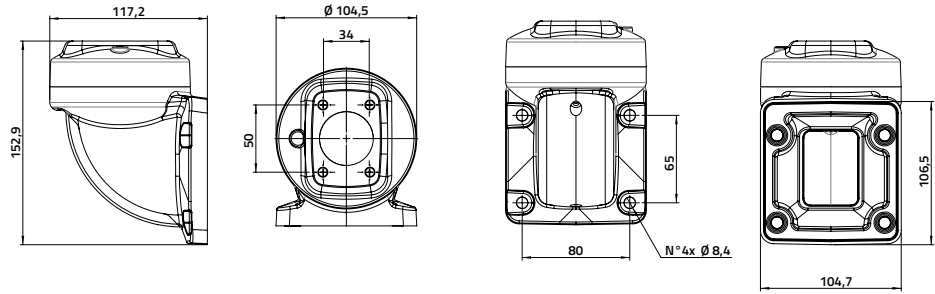

mat col g cod



Montante fisso /
Fixed-mount base

Al 7035 220 060S070M800

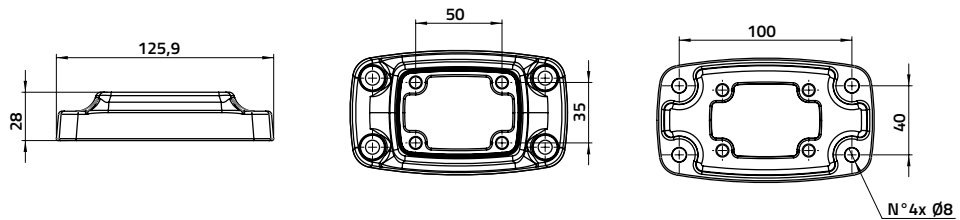

mat col g cod



Montante diretto girevole inclinato 10° /
Base-mount swivel flange with 10° tilt

Al 7035 1050 060S070M841

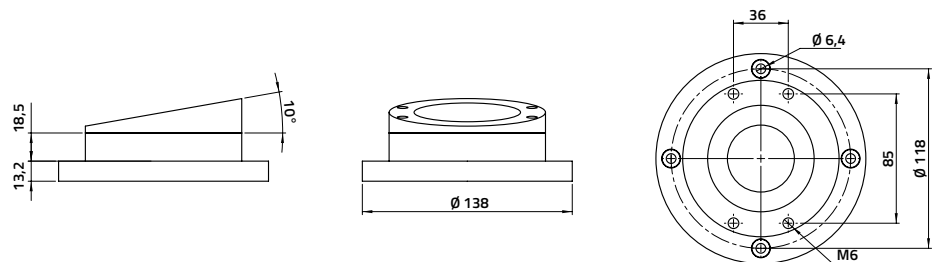

Sistemi di sospensione modulare - Linea 85 Modular suspension system - Line 85

Profilo di alluminio 60X85 / Aluminium profile 60x85



	mat	col	g	cod
Lunghezza / Length mm 250	Al	7035	1105	060S085B0250
Lunghezza / Length mm 350	Al	7035	1547	060S085B0350
Lunghezza / Length mm 500	Al	7035	2210	060S085B0500
Lunghezza / Length mm 750	Al	7035	3315	060S085B0750
Lunghezza / Length mm 1000	Al	7035	4420	060S085B1000
Lunghezza / Length mm 1500	Al	7035	5530	060S085B1500
Lunghezza / Length mm 2000	Al	7035	8840	060S085B2000

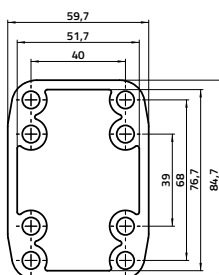

Flange / Flanges



	mat	col	g	cod
Adattatore per inclinazione regolabile $\pm 15^\circ$ / Adapter for adjustable tilt $\pm 15^\circ$	Al	7035	1150	060S085F060

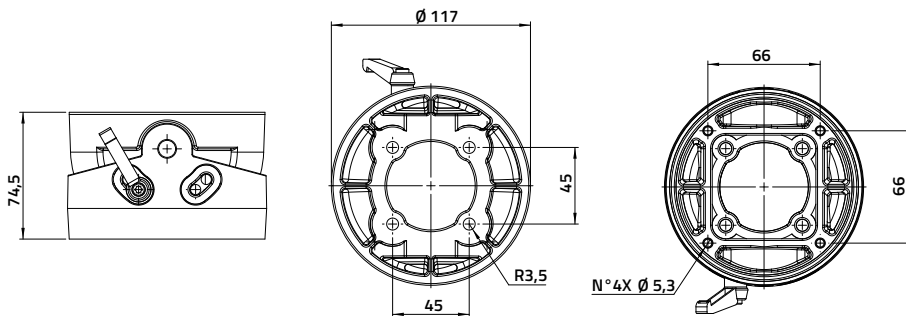

	mat	col	g	cod
Flangia girevole / Swivel flange	Al	7035	935	060S085F090

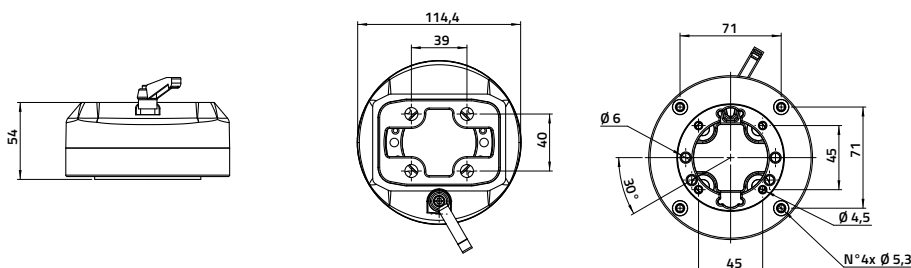

Sistemi di sospensione modulare - Linea 85

Modular suspension system - Line 85

Flange / Flanges



Flangia angolare 90° girevole/
Swivel 90° angular flange

mat

col

g

cod

Al

7035

2580

060S085F150

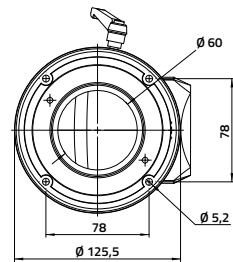
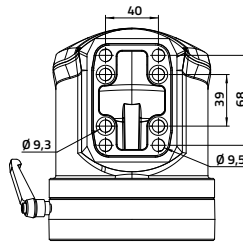
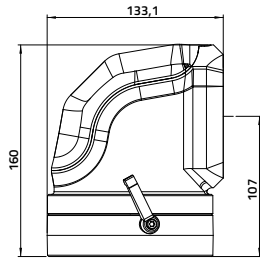

mat

col

g

cod



Adattatore per inclinazione 10°
Adapter for 10° tilt

Al

7035

460

060S085F165

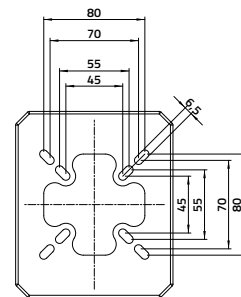
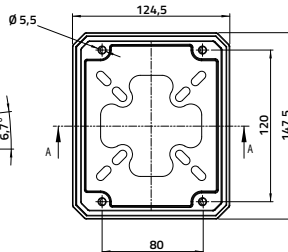
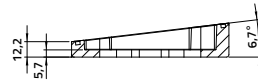

Sistemi di sospensione modulare - Linea 85 Modular suspension system - Line 85

Giunti / Joints



Giunto angolare 90° /
90° angular joint

mat

col

g

cod

Al

7035

923

060S085G100

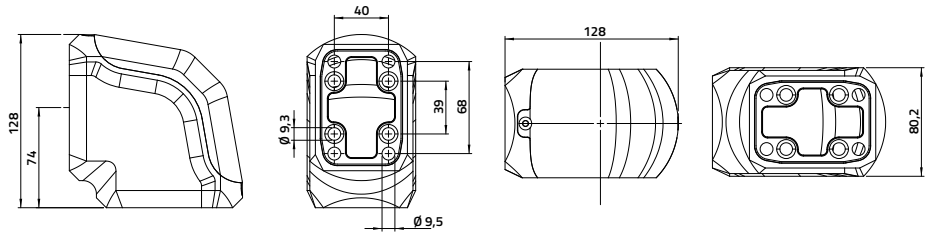

mat

col

g

cod

Al

7035

3230

060S085G130

Giunto a snodo girevole /
Swivel joint

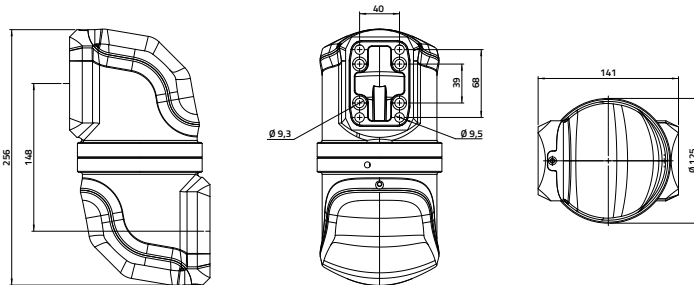

mat

col

g

cod

Al

7035

2960

060S085G190

Giunto angolare 90° girevole /
90° angular swivel joint

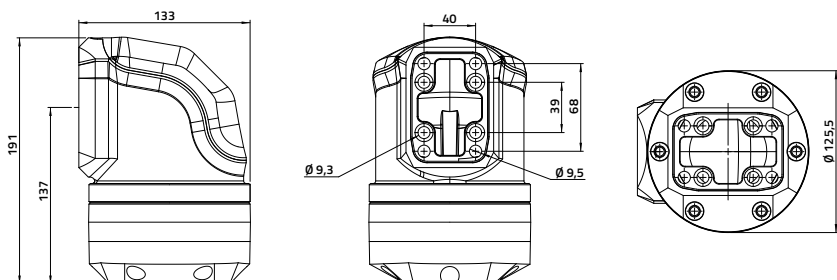

Sistemi di sospensione modulare - Linea 85

Modular suspension system - Line 85

Montanti / Bases



Montante a parete a snodo girevole /
Wall-mount swivel base

mat col g cod

Al 7035 3600 060S085M110

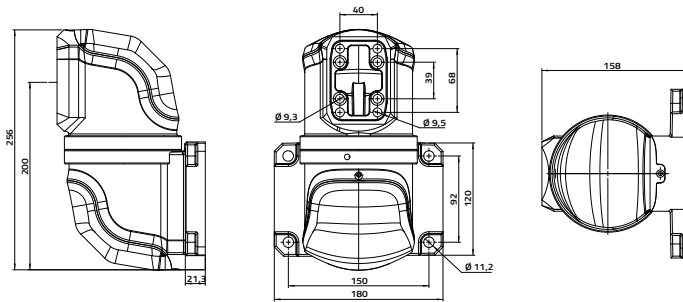

Montante angolare 90° girevole/
Swivel 90° angular base

mat col g cod

Al 7035 2775 060S085M120

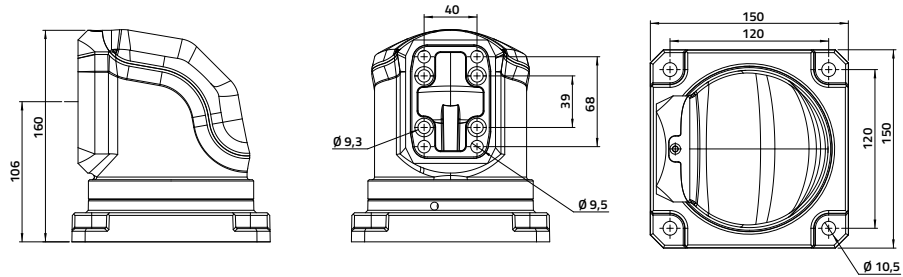

Montante fisso /
Fixed-mount base

mat col g cod

Al 7035 758 060S085M140

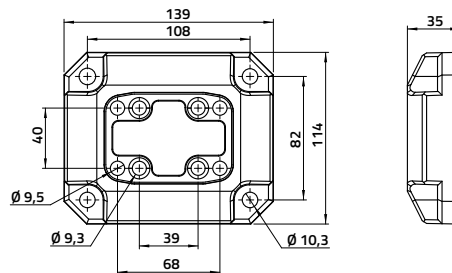

Sistemi di sospensione modulare - Linea 85 Modular suspension system - Line 85

Montanti / Bases



Montante a parete ang 90° girevole /
Wall-mount swivel 90° angular base

mat

col

g

cod

Al

7035

3550

060S085M170

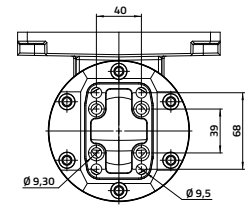
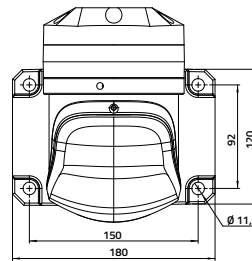
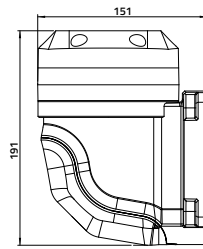

Montante girevole/
Swivel base

mat

col

g

cod

Al

7035

2900

060S085M180

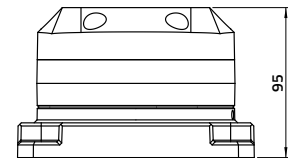
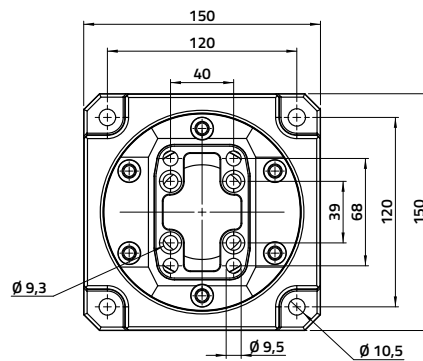

Sistemi di sospensione modulare - Linea 100 Modular suspension system - Line 100

Profilo di alluminio 70X100 / Aluminium profile 70x100



	mat	col	g	cod
Lunghezza / Length mm 250	Al	7035	1247	060S100B0250
Lunghezza / Length mm 350	Al	7035	1745	060S100B0350
Lunghezza / Length mm 500	Al	7035	2494	060S100B0500
Lunghezza / Length mm 750	Al	7035	3741	060S100B0750
Lunghezza / Length mm 1000	Al	7035	4988	060S100B1000
Lunghezza / Length mm 1500	Al	7035	7482	060S100B1500
Lunghezza / Length mm 2000	Al	7035	9976	060S100B2000

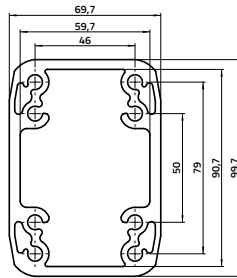

Flange / Flanges



Adattatore per inclinazione regolabile $\pm 15^\circ$ /
Adapter for adjustable tilt $\pm 15^\circ$

mat	col	g	cod
Al	7035	1470	060S100F060

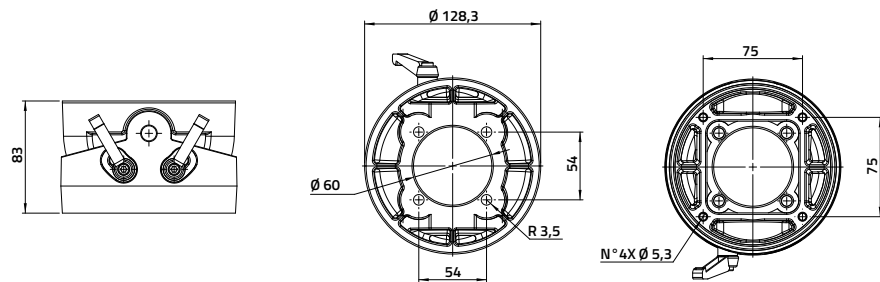

Flangia girevole
Swivel flange

mat	col	g	cod
Al	7035	1033	060S100F090

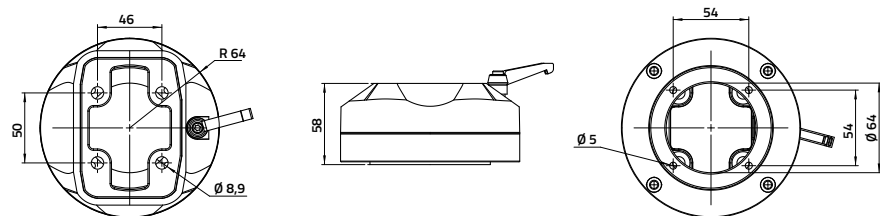

Sistemi di sospensione modulare - Linea 100

Modular suspension system - Line 100

Flange / Flanges



Flangia angolare 90° girevole /
Swivel 90° angular flange

mat col g cod

Al 7035 1770 060S100F150

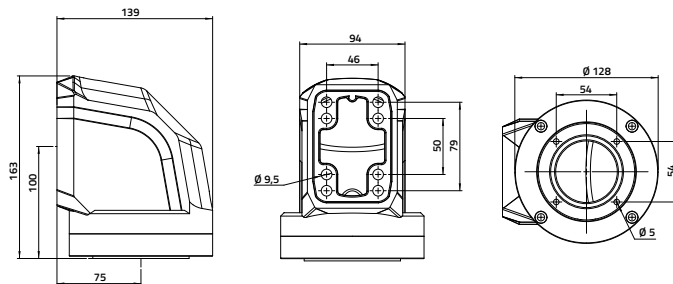

mat col g cod

Al 7035 420 060S100F165



Adattatore per inclinazione 10°
Adapter for 10° tilt

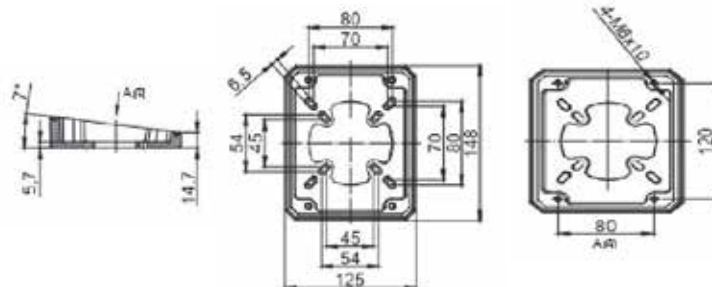

Sistemi di sospensione modulare - Linea 100

Modular suspension system - Line 100

Giunti / Joints

	mat	col	g	cod
Giunto riduzione profilo 100-85 / Reducer joint profile 100-85	Al	7035	340	060S100G070

	mat	col	g	cod
Giunto angolare 90 ° / 90° angular joint	Al	7035	1330	060S100G100

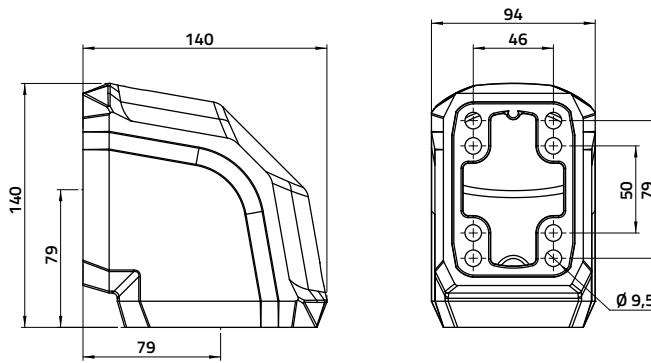

	mat	col	g	cod
Giunto a snodo girevole / Swivel joint	Al	7035	5213	060S100G130

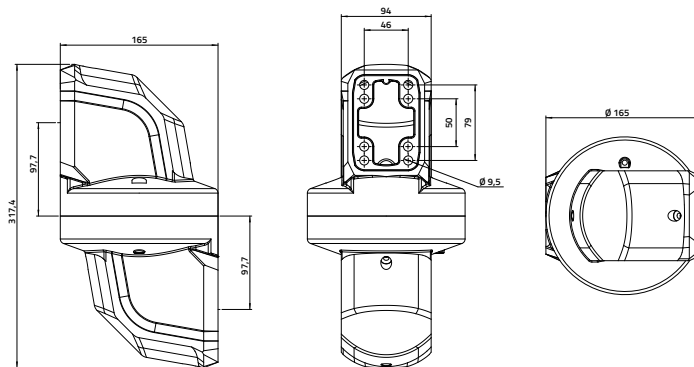

Sistemi di sospensione modulare - Linea 100

Modular suspension system - Line 100

Giunti / Joints



Giunto angolare 90° girevole /
90° angular swivel joint

mat col g cod
Al 7035 4200 060S100G190

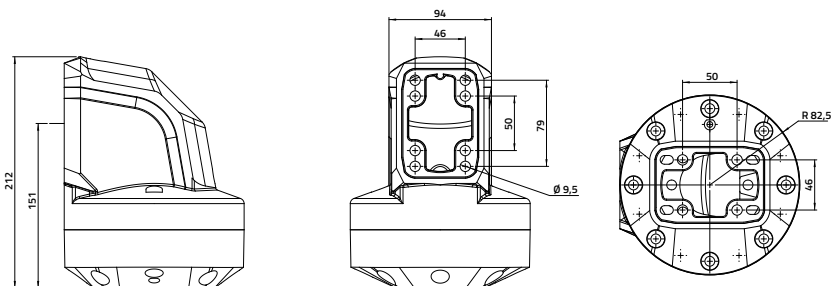

Montanti / Bases



Montante a parete a snodo girevole /
Wall-mount swivel base

mat col g cod
Al 7035 5918 060S100M110

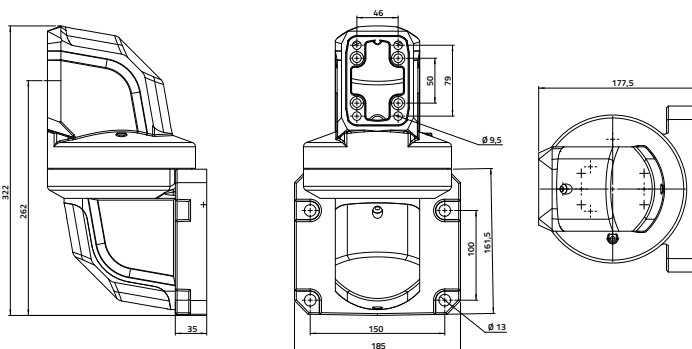

Montante angolare 90° girevole /
Swivel 90° angular base

mat col g cod
Al 7035 5165 060S100M120

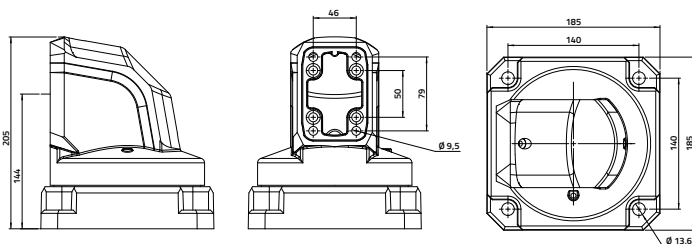

Sistemi di sospensione modulare - Linea 100

Modular suspension system - Line 100

Montanti / Bases



Montante fisso /
Fixed-mount base

mat col g cod

Al 7035 630 060S100M140

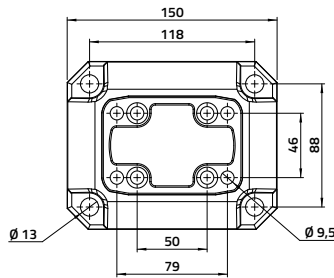

Montante angolare 90° girevole /
Swivel 90° angular base

mat col g cod

Al 7035 5700 060S100M170

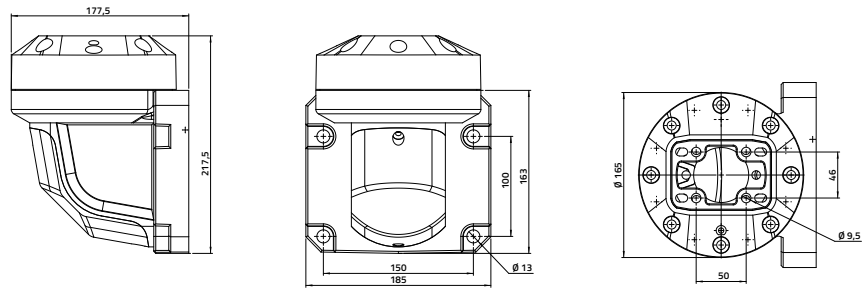

Montante girevole /
Swivel base

mat col g cod

Al 7035 4700 060S100M180

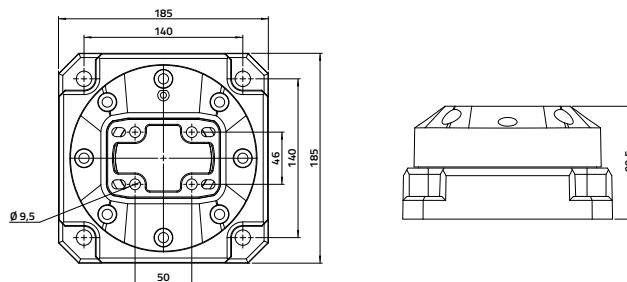

Quadri di comando pensili - Linea SC Suspended control panels - Line SC

Quadro Alluminio - Aluminium cabinet



348	348	100	300	300	90	060SC3535-10
448	348	100	400	300	90	060SC4535-10
448	448	100	400	400	90	060SC4545-10
548	448	100	500	400	90	060SC5545-10
548	548	100	500	500	90	060SC5555-10
648	548	100	600	600	90	060SC6555-10
648	648	100	600	600	90	060SC6565-10

348	348	130	300	300	120	060SC3535-13
448	348	130	400	300	120	060SC4535-13
448	448	130	400	400	120	060SC4545-13
548	448	130	500	400	120	060SC5545-13
548	548	130	500	500	120	060SC5555-13
648	548	130	600	600	120	060SC6555-13
648	648	130	600	600	120	060SC6565-13

348	348	160	300	300	150	060SC3535-16
448	348	160	400	300	150	060SC4535-16
448	448	160	400	400	150	060SC4545-16
548	448	160	500	400	150	060SC5545-16
548	548	160	500	500	150	060SC5555-16
648	548	160	600	600	150	060SC6555-16
648	648	160	600	600	150	060SC6565-16

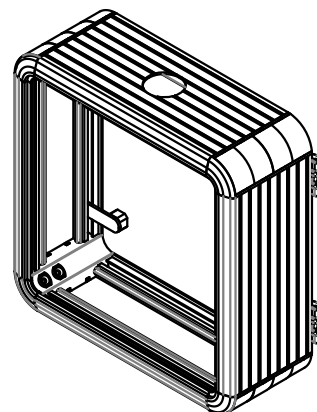
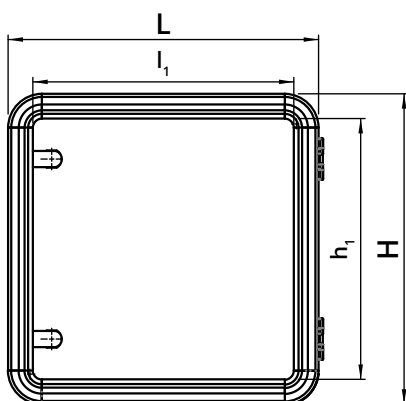

Quadri di comando pensili - Linea SC Suspended control panels - Line SC

Quadro Alluminio con maniglia inferiore - Aluminium cabinet with low handle



348	348	100	300	300	90	060SC3535-10M1
448	348	100	400	300	90	060SC4535-10M1
448	448	100	400	400	90	060SC4545-10M1
548	448	100	500	400	90	060SC5545-10M1
548	548	100	500	500	90	060SC5555-10M1
648	548	100	600	600	90	060SC6555-10M1
648	648	100	600	600	90	060SC6565-10M1

348	348	130	300	300	120	060SC3535-13M1
448	348	130	400	300	120	060SC4535-13M1
448	448	130	400	400	120	060SC4545-13M1
548	448	130	500	400	120	060SC5545-13M1
548	548	130	500	500	120	060SC5555-13M1
648	548	130	600	600	120	060SC6555-13M1
648	648	130	600	600	120	060SC6565-13M1

348	348	160	300	300	150	060SC3535-16M1
448	348	160	400	300	150	060SC4535-16M1
448	448	160	400	400	150	060SC4545-16M1
548	448	160	500	400	150	060SC5545-16M1
548	548	160	500	500	150	060SC5555-16M1
648	548	160	600	600	150	060SC6555-16M1
648	648	160	600	600	150	060SC6565-16M1

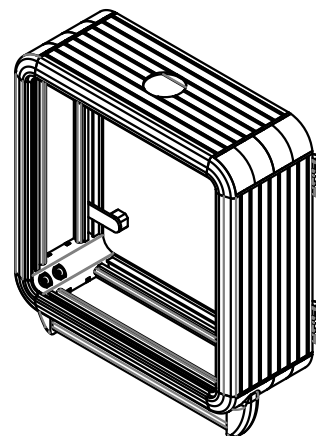
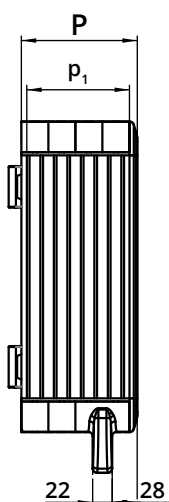
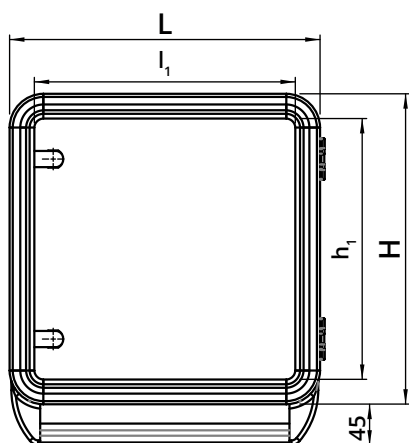

Quadri di comando pensili - Linea SC Suspended control panels - Line SC

Quadro Alluminio con maniglie laterali - Aluminium cabinet with side handles



348	348	100	300	300	90	060SC3535-10M2
448	348	100	400	300	90	060SC4535-10M2
448	448	100	400	400	90	060SC4545-10M2
548	448	100	500	400	90	060SC5545-10M2
548	548	100	500	500	90	060SC5555-10M2
648	548	100	600	600	90	060SC6555-10M2
648	648	100	600	600	90	060SC6565-10M2

348	348	130	300	300	120	060SC3535-13M2
448	348	130	400	300	120	060SC4535-13M2
448	448	130	400	400	120	060SC4545-13M2
548	448	130	500	400	120	060SC5545-13M2
548	548	130	500	500	120	060SC5555-13M2
648	548	130	600	600	120	060SC6555-13M2
648	648	130	600	600	120	060SC6565-13M2

348	348	160	300	300	150	060SC3535-16M2
448	348	160	400	300	150	060SC4535-16M2
448	448	160	400	400	150	060SC4545-16M2
548	448	160	500	400	150	060SC5545-16M2
548	548	160	500	500	150	060SC5555-16M2
648	548	160	600	600	150	060SC6555-16M2
648	648	160	600	600	150	060SC6565-16M2

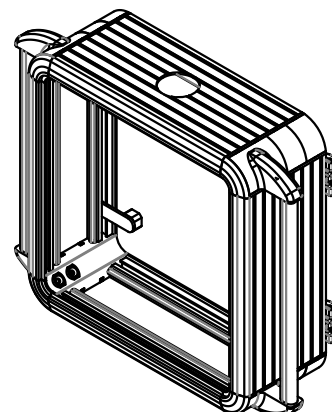
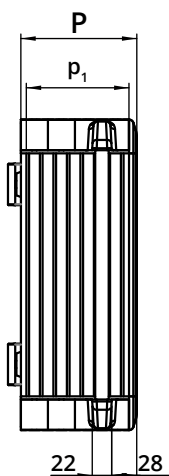
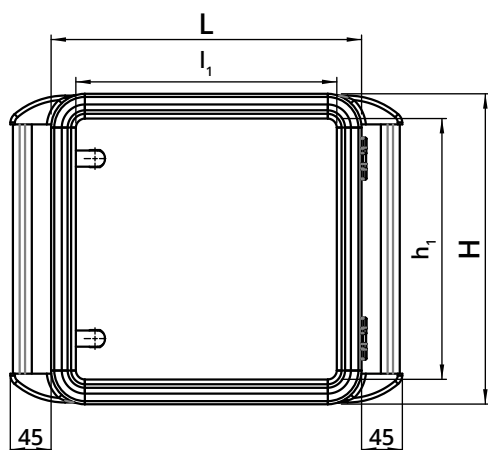

Pulsantiera mobile Hand-held push-button control unit



Fornibili operatori ad una o due velocità
Operators available at one or two speed



Manicotto antitorsione e serracavo antistrappo
Anti-torsion sleeve and tear-proof cable clamp

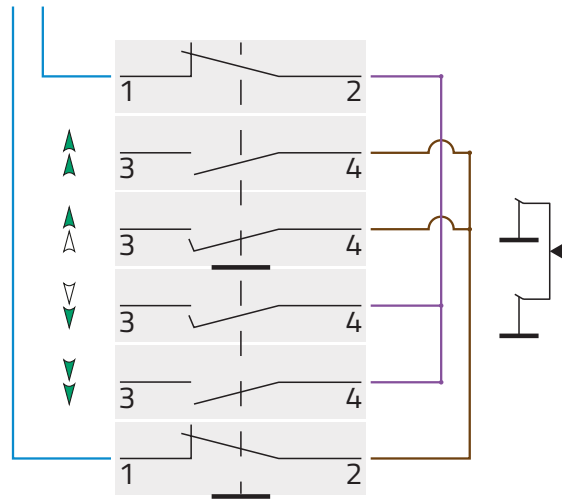

Coppia di operatori interbloccati meccanicamente ed elettricamente a due velocità
Couple of mechanically and electrically interlocked operators at two speeds

Pulsantiere pensili Pendant push-button stations

Con operatore / With operator

g

cod



2 operatori + emergenza 1NC / 2 operators + emergency 1NC

Pulsanti a 1 velocità / 1 speed push-buttons	390	060PM2S1
Pulsanti a 2 velocità / 2 speed push-buttons	390	060PM2S2

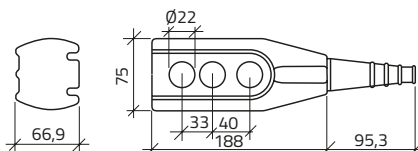

4 operatori + emergenza 1NC / 4 operators + emergency 1NC

Pulsanti a 1 velocità / 1 speed push-buttons	550	060PM4S1
Pulsanti a 2 velocità / 2 speed push-buttons	550	060PM4S2

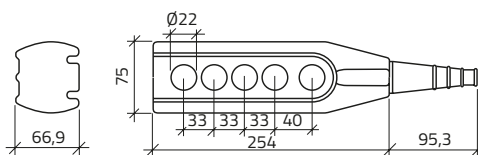

6 operatori + emergenza 1NC / 6 operators + emergency 1NC

Pulsanti a 1 velocità / 1 speed push-buttons	960	060PM6S1
Pulsanti a 2 velocità / 2 speed push-buttons	960	060PM6S2

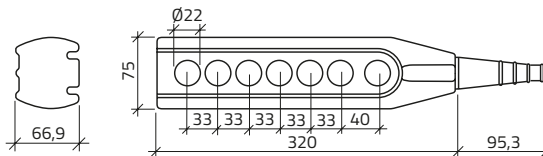

8 operatori + emergenza 1NC / 8 operators + emergency 1NC

Pulsanti a 1 velocità / 1 speed push-buttons	1070	060PM8S1
Pulsanti a 2 velocità / 2 speed push-buttons	1070	060PM8S2

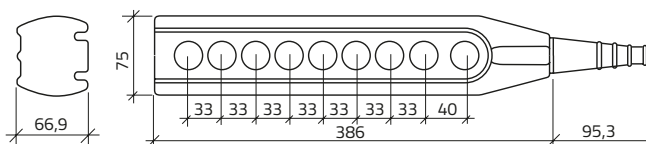

Caratteristiche tecniche / Technical data

Involucro	Body
ABS	ABS
Grado di protezione	Degree of protection
IP65	IP65
Temperatura di esercizio	Operating temperature
-5°C +125°C	-5°C +125°C

Caratteristiche pulsanti

Durata meccanica	5 x 10 ⁵ cicli di manovra
Durata elettrica	1 x 10 ⁵ cicli di manovra
Tensione nominale Ue	250v AC
Corrente nominale Ia	4 A
Potenze nominali di impiego in AC 15 secondo IEC947-5-1	1000 VA
Tensione di isolamento UI	300V Uimp 2,5 Kv

Push-button performance

Mechanical durability	5 x 10 ⁵ operations
Electrical durability	1 x 10 ⁵ operations
Rating operating voltage Ue	250v AC
Rating operating current Ia	4 A
Rated switching power according to IEC947-5-1	1000 VA
Insulation Voltage UI	300V Uimp 2,5 Kv

