

Scheda Dati

020GE01

Kosketinelementti N.C. laipalla



Caratteristiche

| | |
|------------------|-----------------------------------|
| Range | Kosketinelementit |
| Componente | Kosketuselementit 1 N.C. laipalla |
| Code | 020GE01 |
| Kuvaus | Kosketinelementti N.C. laipalla |
| Väriä | Rosso |
| Peso | 19,0 |
| Tariffa doganale | 85365080 |
| GT | 8052878004101 |

Dati tecnici

| | |
|-----------------------------------|---|
| Approvals | CE, UL, CSA |
| Compliance with standards | IEC-EN60947-1, IEC-EN60947-5-1, UL508, CSA C22-2 |
| Compliance with standards | UNI CEI EN 45545-2, CEI EN 61373 |
| Operating temperatures | -40° ÷ +70°C |
| Environmental operating values | +25°C-97%RH / +45°C-93%RH (IEC-EN60068-2-30) |
| Protection degree | IP20 (IEC-EN60529) |
| Mechanical durability | 5.000.000 Operations |
| Shock resistance | 30g duration=18ms (EN-IEC 60068-2-27) |
| Shock resistance | 50g duration=11ms (EN-IEC 60068-2-27) |
| Vibration resistance | 5g f= 2...500Hz (EN-IEC 60068-2-6) |
| Pollution degree for installation | 3 |
| Housing material | PA Polyamide |
| Flange clamping spring material | Stainless steel AISI 304 |
| Terminal screw | Tightening torque 0.8÷1 Nm (IEC-EN60947-1) |
| Terminal screw head shape | Combined:cross Phillips2 or slotted flat D.5mm max |
| Terminal screw material | Zinc plated steel |
| Terminal screw connections | min 1x0.5mm ² (20AWG) - max 2x2.5mm ² (14AWG) |
| Cable lugs | Fork type "spring spade" for screw M3.5 / W=6.4mm |
| Contact material | Ag 1000/1000 |
| Contact movement | Slow action contact |
| Contacts | Self cleaning by pads creeping |

| | |
|--|--|
| NC contact operating travel | 1.0mm NC change the state - 5mm total |
| NC contacts (all versions) | Positive opening function (IEC-EN60947-5-1 ann.K) |
| NC contacts | Minimum positive opening travel: 1mm |
| NC contacts (all versions) | Minimum force for positive opening: 1.5N |
| NC contacts (all versions) | Total travel including overtravel: 5mm |
| Operating force (all version) | 2N |
| Rated insulation voltage | Ui 690V - Uimp 4KV (IEC-EN60947-1) |
| Rated thermal current | Ith 10A (IEC-EN60947-1) |
| Rated conditional short-circuit current | 1000A (IEC-EN60947-1) |
| Short-circuit protective device | 10A cartridge fuse gG 10x38mm (IEC-EN60947-5-1) |
| Electrical ratings | AC15-DC13 (IEC-EN60947-5-1) - A600-P300 (UL 508) |
| Electrical reliability | <10exp(-8)5mA in clean environment IEC-EN60947-5-4 |
| AC Performances | AC 24V-10A, 120V-6A, 240V-3A, 600V-1.2A |
| DC Performances | DC 24V-5A, 120V-1.1A, 240V-0.55A |
| Warranty period | 18 months |

Disegni tecnici

020

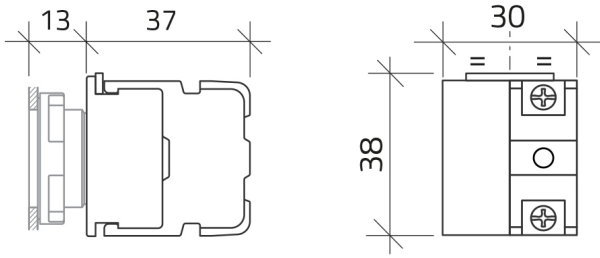

032

