

Datenblatt

030SFKQBD

Vierkantschlüssel-Wahlschalter, flächenbündig, 2 Positionen, Federrückführung von rechts, Cam B



Merkmale

Baureihe	Vierkantschlüssel-Wahlschalter Ø 30
Komponenten	Vierkantschlüssel-Wahlschalter 2 Positionen
Artikel-Nr.	030SFKQBD
Beschreibung	Vierkantschlüssel-Wahlschalter, flächenbündig, 2 Positionen, Federrückführung von rechts, Cam B
Gewicht - gr	110,0
Zolltarifnummer	85365080
GTIN	8052878036461

Technische Daten

Approvals	CE
Compliance with standards	UNI CEI EN 45545-2, CEI EN 61373
Compliance with standards	IEC-ENC60947-1, IEC-EN60947-5-1
Operating temperatures	-25° ÷ +70°C
Environmental operating values	+25°C-97%RH / +45°C-93%RH (IEC-EN60068-2-30)
Protection degree	IP66 - IP69 (IEC-EN60529)
Protection against impact	IK10 (IEC-EN62262)
Mechanical durability	1.000.000 Operations
Shock resistance	30g duration=18ms (EN-IEC 60068-2-27)
Shock resistance	50g duration=11ms (EN-IEC 60068-2-27)
Vibration resistance	5g f= 2...500Hz (EN-IEC 60068-2-6)
Contact blocks configuration	Max no. 6 blocks (3+3)
Fixing diameter	30.5mm - Thickness 1÷6mm
Protection against electric shock	Class I (IEC-EN61140)
Housing material	Stainless steel AISI 304
Square key insert material	Stainless steel AISI 304
Locking ring material	Stainless steel AISI 304
Locking ring tightening torque	3÷5Nm (26.6÷44.3 Lb-in)
Actuation torque	0.4Nm (3.5 Lb-in)
Warranty period	18 months

Technische Zeichnungen

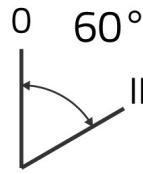
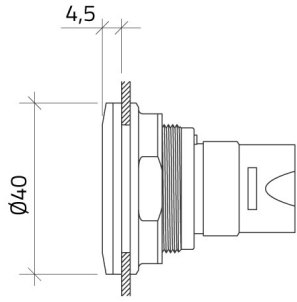

CAM B

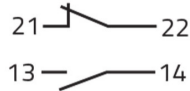
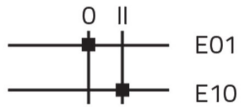

020E01
020E10
020G

