

## Datablad

### 030SFKQBD

Vierkante sleutelschakelaar, inbouwmodel, 2 posities, retour van r, Cam B



## Kenmerken

<b>Bereik</b>	Vierkante sleutelschakelaars Ø 30
<b>Component</b>	Vierkante sleutelschakelaars 2 posities
<b>Rubriek</b>	030SFKQBD
<b>Omschrijving</b>	Vierkante sleutelschakelaar, inbouwmodel, 2 posities, retour van r, Cam B
<b>Gewicht</b>	110,0
<b>Douanetarief</b>	85365080
<b>GTIN</b>	8052878036461

## Technische gegevens

<b>Approvals</b>	CE
<b>Compliance with standards</b>	UNI CEI EN 45545-2, CEI EN 61373
<b>Compliance with standards</b>	IEC-ENC60947-1, IEC-EN60947-5-1
<b>Operating temperatures</b>	-25° ÷ +70°C
<b>Environmental operating values</b>	+25°C-97%RH / +45°C-93%RH (IEC-EN60068-2-30)
<b>Protection degree</b>	IP66 - IP69 (IEC-EN60529)
<b>Protection against impact</b>	IK10 (IEC-EN62262)
<b>Mechanical durability</b>	1.000.000 Operations
<b>Shock resistance</b>	30g duration=18ms (EN-IEC 60068-2-27)
<b>Shock resistance</b>	50g duration=11ms (EN-IEC 60068-2-27)
<b>Vibration resistance</b>	5g f= 2...500Hz (EN-IEC 60068-2-6)
<b>Contact blocks configuration</b>	Max no. 6 blocks (3+3)
<b>Fixing diameter</b>	30.5mm - Thickness 1÷6mm
<b>Protection against electric shock</b>	Class I (IEC-EN61140)
<b>Housing material</b>	Stainless steel AISI 304
<b>Square key insert material</b>	Stainless steel AISI 304
<b>Locking ring material</b>	Stainless steel AISI 304
<b>Locking ring tightening torque</b>	3÷5Nm (26.6÷44.3 Lb-in)
<b>Actuation torque</b>	0.4Nm (3.5 Lb-in)
<b>Warranty period</b>	18 months

# Technische tekeningen

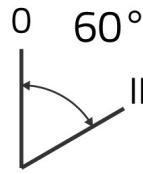
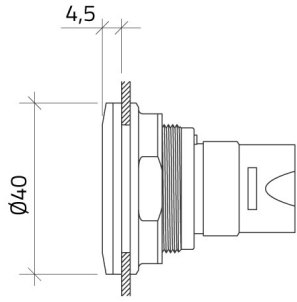

## CAM B

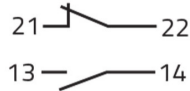
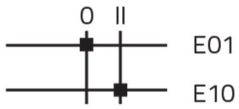

020E01  
020E10  
020G

