

Scheda Dati

030SFMLORC

Selector luminoso con mando, rojo, hilo panel, 3 posiciones, Cam O, retorno al centro



Caratteristiche

| | |
|------------------|---|
| Rango | Selectores luminosos de mando Ø 30 |
| Componente | Selectores de mando con 3 posiciones |
| Código | 030SFMLORC |
| Descripción | Selector luminoso con mando, rojo, hilo panel, 3 posiciones, Cam O, retorno al centro |
| Color | Rosso |
| Peso | 43,5 |
| Tariffa doganale | 85365080 |
| GTIN | 8052878037116 |

Dati tecnici

| | |
|--|---|
| Approvals | CE, UL, CSA |
| Compliance with standards | IEC-EN60947-1, IEC-EN60947-5-1, UL508, CSA C22-2 |
| Compliance with standards | UNI CEI EN 45545-2, CEI EN 61373 |
| Operating temperatures | -25° ÷ +65°C |
| Environmental operating values | +25°C-97%RH / +45°C-93%RH (IEC-EN60068-2-30) |
| Protection degree | IP65 (IEC-EN60529) |
| Protection against impact | IK04 (IEC-EN62262) |
| Mechanical durability | 1.000.000 Operations |
| Shock resistance | 30g duration=18ms (EN-IEC 60068-2-27) |
| Shock resistance | 50g duration=11ms (EN-IEC 60068-2-27) |
| Vibration resistance | 5g f= 2...500Hz (EN-IEC 60068-2-6) |
| Contact blocks configuration | Max no. 4 blocks (2+2) |
| Knob or lever material | PC Polycarbonate |
| External bezel material | Anodized aluminum |
| Locking ring material | Zamak zinc alloy |
| Fixing diameter | 30.5mm - Thickness 1÷6mm |
| Tightening torque | 2 ÷ 3Nm (17.7 ÷ 26.6 Lb-in) |
| Illuminated selector switch (all versions) | It is mandatory to use LED bulbs type 010BA9SLxxx |
| Protection against electric shock | Class I (IEC-EN61140) |
| Warranty period | 18 months |

Disegni tecnici

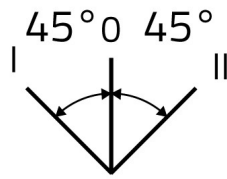
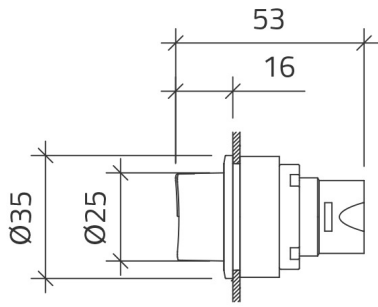

CAM O

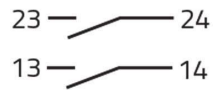
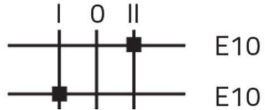
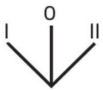

020E10
020E10
020PD9

