

## Datablad

050FC1C

Driepolige eindschakelaar 1 N.C. + 2 N.O.



## Kenmerken

<b>Bereik</b>	Eindschakelaar en kabels
<b>Component</b>	Driepolige eindschakelaars
<b>Rubriek</b>	050FC1C
<b>Omschrijving</b>	Driepolige eindschakelaar 1 N.C. + 2 N.O.
<b>Kleur</b>	Giallo
<b>Gewicht</b>	62,0
<b>Douanetarief</b>	8536500700
<b>GTIN</b>	8052878048945

## Technische gegevens

<b>Approvals</b>	CE, UL, CSA (050FC3C only)
<b>Compliance with standards</b>	IEC-EN60947-1, IEC-EN60947-5-1, UL508, CSA C22-2
<b>Operating temperatures</b>	-25° ÷ +65°C
<b>Protection degree</b>	IP40 (IEC-EN60529)
<b>Mechanical durability</b>	5.000.000 Operations
<b>Housing material</b>	PC Polycarbonate
<b>Terminal screw</b>	Tightening torque 0.8÷1 Nm (IEC-EN60947-1)
<b>Terminal screw head shape</b>	Combined:cross Phillips2 or slotted flat D.5mm max
<b>Terminal screw material</b>	Zinc plated steel
<b>Terminal screw connections</b>	min 1x0.5mm <sup>2</sup> (20AWG) - max 2x2.5mm <sup>2</sup> (14AWG)
<b>Cable lugs</b>	Fork type "spring spade" for screw M3.5 / W=6.4mm
<b>Contact material</b>	Ag 1000/1000
<b>Contact movement</b>	Slow action contact
<b>Contacts</b>	Self cleaning by pads creeping
<b>Actuation speed</b>	Min. 5mm/s - Max 20mm/s
<b>NC contacts (all versions)</b>	Positive opening function (IEC-EN60947-5-1 ann.K)
<b>Rated insulation voltage</b>	Ui 690V - Uimp 4KV (IEC-EN60947-1)
<b>Rated thermal current</b>	Ith 10A (IEC-EN60947-1)
<b>Protection against electric shock</b>	Class II (IEC-EN61140)
<b>Electrical ratings</b>	AC15-DC13 (IEC-EN60947-5-1) - A600-P300 (UL 508)
<b>AC Performances</b>	AC 24V-10A, 120V-6A, 240V-3A, 600V-1.2A

---

**DC Performances**

DC 24V-5A, 120V-1.1A, 240V-0.55A

---

**Warranty period**

18 months

---

# Technische tekeningen

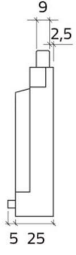
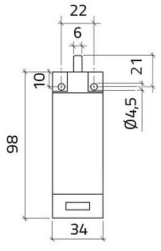

1NC+2NO

1-2  
3-4  
5-6

