

Datasheet

050FC3C

Three-pole limit switch, 3 N.C.



Features

| | |
|-----------------------|---------------------------------|
| Range | Limit switches and cables |
| components | Three-pole limit switches |
| Code | 050FC3C |
| Description | Three-pole limit switch, 3 N.C. |
| Colour | Giallo |
| Weight - gr | 62.0 |
| Customs Tariff | 8536500700 |
| GTIN | 8052878048969 |

Datasheet

| | |
|--|---|
| Approvals | CE, UL, CSA (050FC3C only) |
| Compliance with standards | IEC-EN60947-1, IEC-EN60947-5-1, UL508, CSA C22-2 |
| Operating temperatures | -25° ÷ +65°C |
| Protection degree | IP40 (IEC-EN60529) |
| Mechanical durability | 5.000.000 Operations |
| Housing material | PC Polycarbonate |
| Terminal screw | Tightening torque 0.8÷1 Nm (IEC-EN60947-1) |
| Terminal screw head shape | Combined:cross Phillips2 or slotted flat D.5mm max |
| Terminal screw material | Zinc plated steel |
| Terminal screw connections | min 1x0.5mm ² (20AWG) - max 2x2.5mm ² (14AWG) |
| Cable lugs | Fork type "spring spade" for screw M3.5 / W=6.4mm |
| Contact material | Ag 1000/1000 |
| Contact movement | Slow action contact |
| Contacts | Self cleaning by pads creeping |
| Actuation speed | Min. 5mm/s - Max 20mm/s |
| NC contacts (all versions) | Positive opening function (IEC-EN60947-5-1 ann.K) |
| Rated insulation voltage | Ui 690V - Uimp 4KV (IEC-EN60947-1) |
| Rated thermal current | Ith 10A (IEC-EN60947-1) |
| Protection against electric shock | Class II (IEC-EN61140) |
| Electrical ratings | AC15-DC13 (IEC-EN60947-5-1) - A600-P300 (UL 508) |
| AC Performances | AC 24V-10A, 120V-6A, 240V-3A, 600V-1.2A |

DC Performances

DC 24V-5A, 120V-1.1A, 240V-0.55A

Warranty period

18 months

Technical drawings

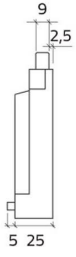
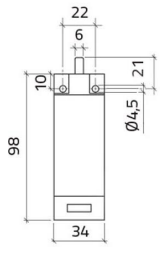

3NC

1-2
3-4
5-6

